

- Layers**
- Hydrography
 - Street Centerlines
 - County Parcels
 - Wilmington Annexations Outlines
 - Caesar Creek Lake
 - Cowan Lake
 - Municipalities Outlines
 - Township Lines
 - 2008 Aerial Photography

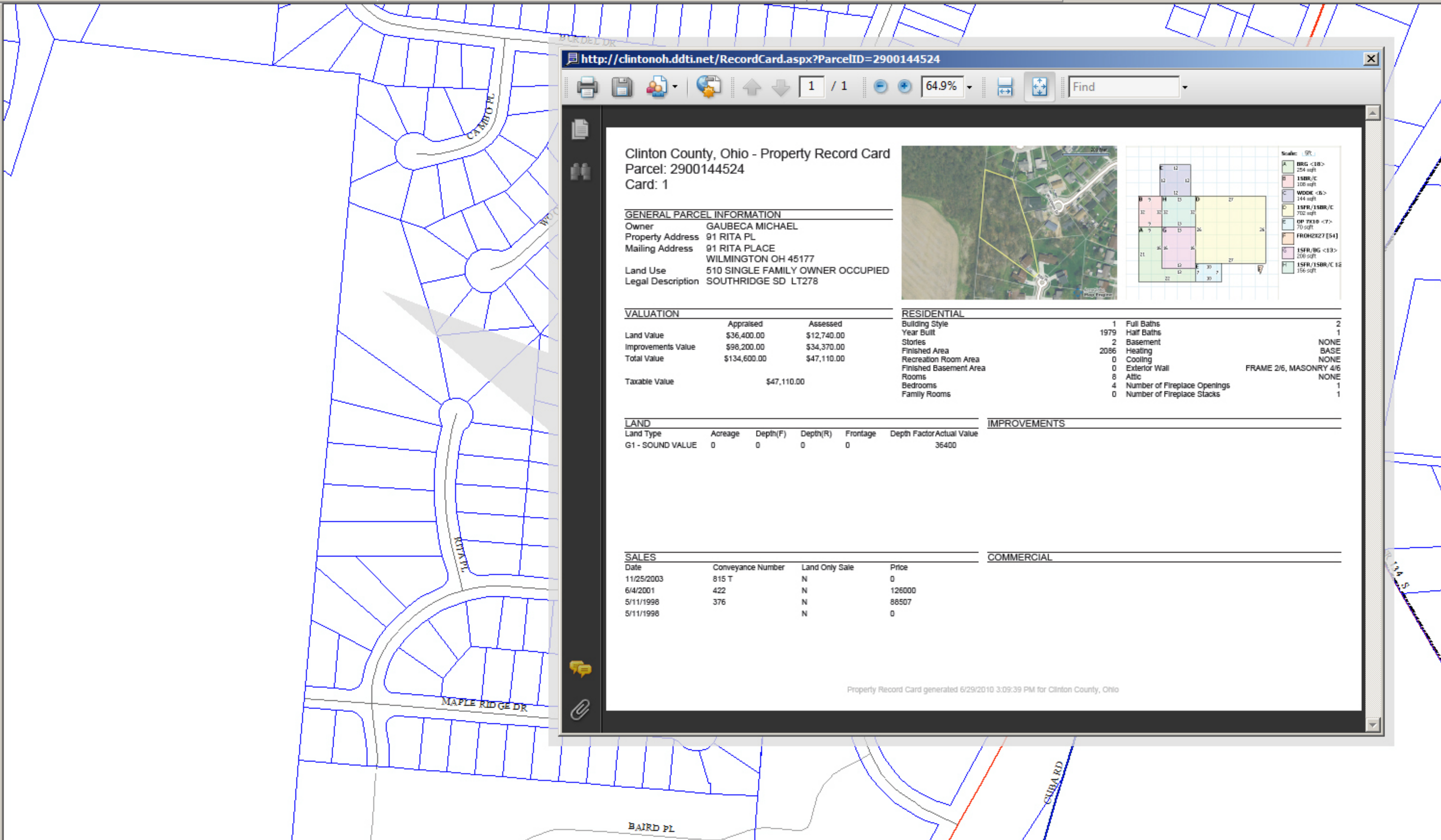

<http://clintonoh.ddti.net/RecordCard.aspx?ParcelID=2900144524>

1 / 1 64.9% Find

Clinton County, Ohio - Property Record Card

Parcel: 2900144524
Card: 1

GENERAL PARCEL INFORMATION

Owner GAUBECA MICHAEL
 Property Address 91 RITA PL
 Mailing Address 91 RITA PLACE
 WILMINGTON OH 45177
 Land Use 510 SINGLE FAMILY OWNER OCCUPIED
 Legal Description SOUTHRIDGE SD LT278

VALUATION	
	Assessed
Land Value	\$36,400.00
Improvements Value	\$98,200.00
Total Value	\$134,600.00
Taxable Value	\$47,110.00

RESIDENTIAL

Building Style	1 Full Baths	2
Year Built	1979 Half Baths	1
Stories	2 Basement	NONE
Finished Area	2086 Heating	BASE
Recreation Room Area	0 Cooling	NONE
Finished Basement Area	0 Exterior Wall	FRAME 2/6, MASONRY 4/6
Rooms	8 Attic	NONE
Bedrooms	4 Number of Fireplace Openings	1
Family Rooms	0 Number of Fireplace Stacks	1

LAND						IMPROVEMENTS
Land Type	Acreage	Depth(F)	Depth(R)	Frontage	Depth Factor	Actual Value
G1 - SOUND VALUE	0	0	0	0		36400

SALES				COMMERCIAL
Date	Conveyance Number	Land Only Sale	Price	
11/25/2003	815 T	N	0	
6/4/2001	422	N	126000	
5/11/1998	376	N	86507	
5/11/1998		N	0	

Property Record Card generated 6/29/2010 3:09:39 PM for Clinton County, Ohio