

101B

160

STATE HIGHWAY # 28

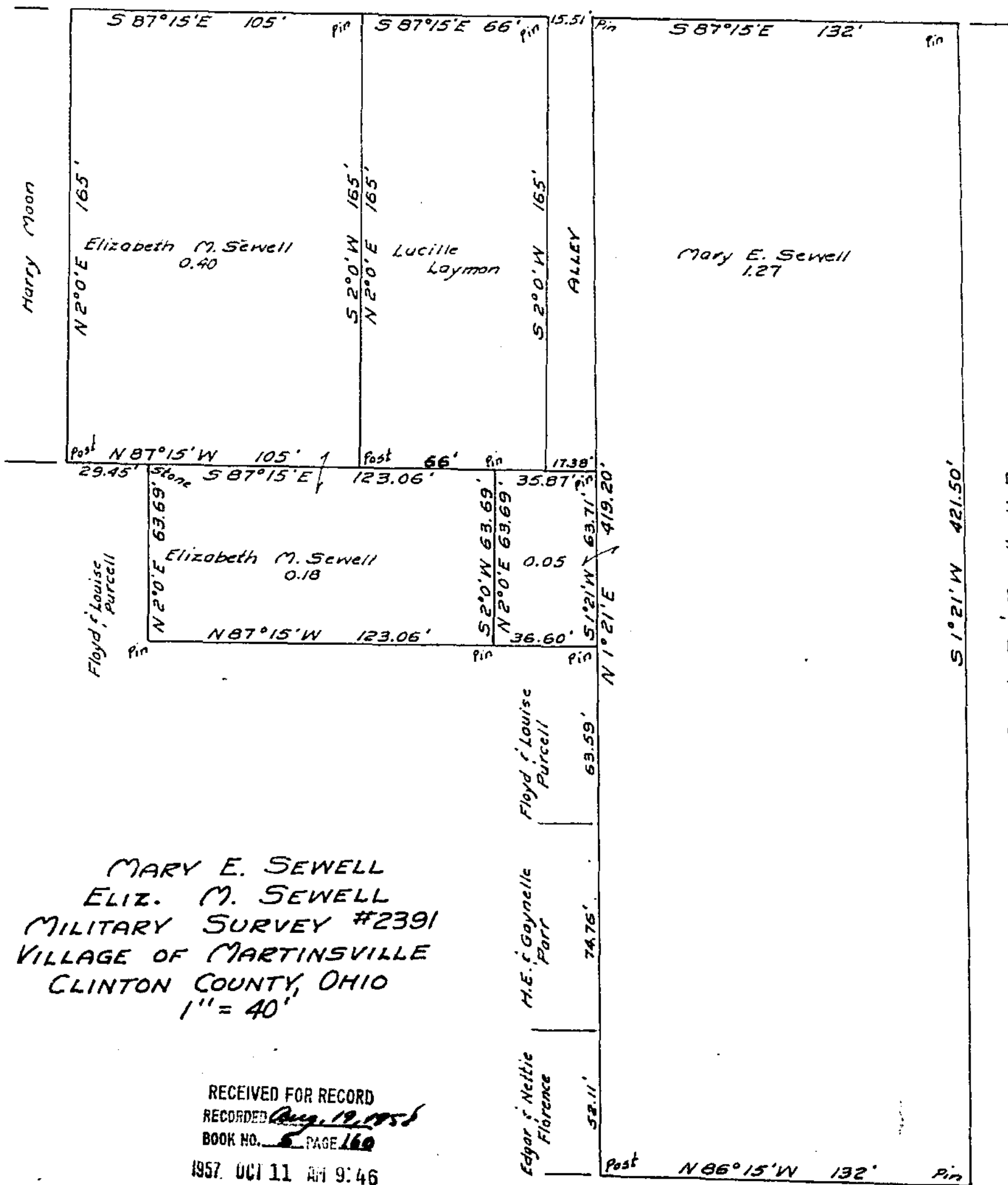

MARY E. SEWELL  
 ELIZ. M. SEWELL  
 MILITARY SURVEY #2391  
 VILLAGE OF MARTINSVILLE  
 CLINTON COUNTY, OHIO  
 1" = 40'

RECEIVED FOR RECORD  
 RECORDED *Aug. 19, 1956*  
 BOOK NO. *5* PAGE *160*  
 1957. OCT 11 AM 9:46

FEE \$  
 JEAN S. RICHARDSON  
 RECORDER  
 CLINTON COUNTY, OHIO

I hereby certify the above to be a correct plat of a survey made by me, completed October 4, 1956.

Maynard Boston  
 Registered Surveyor No. 3966

52075