

CLINTON COUNTY ENGINEERS
RECORD OF LAND DIVISION

VOLUME 43 PLAT NO. 84
DATE: 5-11-20
SCALE: 1" = 40'

DEED REFERENCE
VOLUME _____ PAGE _____
TOWNSHIP VERNON
MILITARY SURVEY NO. 2686

DEED REFERENCE
DOC. NO. 2019-00005083
O.R. 754, PAGE 401

APPROVED FOR MATHEMATICAL ACCURACY
Clinton County Engineers

Per: D. W. Sutton
Date: 5-11-20

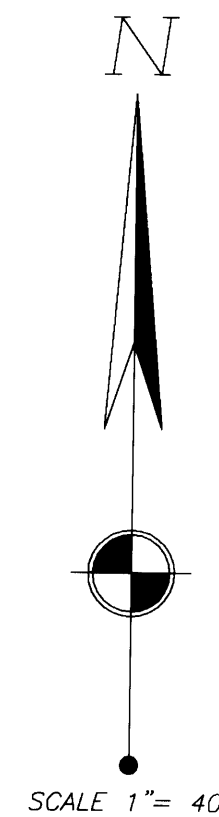

COWAN STATE PARK MONUMENT
4"x4" CONCRETE MON.
WITH 1/4" IP IN TOP
(TYPICAL)

SURVEY PLAT OF THE LANDS OF
RONALD L. GREGORY AND REBECCA A. DIXON
SITUATED IN VMS 2686
VERNON TOWNSHIP, CLINTON COUNTY
OHIO

- MONUMENT LEGEND —
- Iron Pin (fd) size per plan, if cap exist, name is shown by symbol
 - 5/8" OD Iron Pin (set) with yellow plastic cap stamped: "CLINCO & SUTTON"
 - ⊙ Iron Pin previously (set)
 - ⊙ Iron Pipe (fd) OD size per plan
 - ⊠ Stone (fd)
 - ▲ Railroad Spike (fd)
 - △ Railroad Spike (set)
 - ⊕ Mag Nail (set)
 - ⊞ Concrete Monument (fd)
 - PK or Mag Nail (fd)
 - ⊘ Post (fd) size per plan

NOTE: Bearings used are based on NAD 83 (2011) Ohio State Plane Coordinates (South Zone) as derived from GPS Observations. Distances used are based upon Grid distances. The combined scale factor is 0.999896485838. To obtain Ground distances divide the Grid distance by the combined scale factor. Monuments found or set are in good condition unless otherwise labeled. Deeds & Survey Records as noted on drawing are source data for this survey.

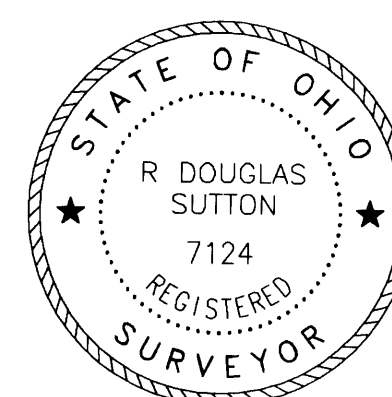
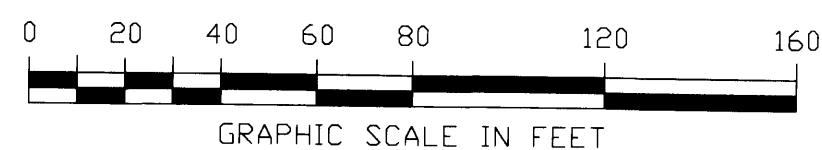

R. Douglas Sutton
R. DOUGLAS SUTTON
OHIO PROFESSIONAL SURVEYOR 7124

Clinco & Sutton
SURVEYORS
61 SOUTH MULBERRY ST.
WILMINGTON, OH 45177

JOB NO. 2020/20519
DRWG NO. 20519
DATE: MAY 2020