

**CERTIFICATE OF OWNERSHIP**

I, Carol Myers, do hereby certify that I am the owner of the property described and shown herein, and that all legally due taxes have been paid, and that as such owner, I have caused the property to be surveyed and subdivided as shown.

*Carol Myers*  
by **EDWARD J. SIMPSON, her ATTORNEY-IN-FACT**

State of Ohio

Be it remembered that on this **21st** day of **April**, 2020, before me, the undersigned, a Notary Public in and for said State, personally came Carol Myers, who has acknowledged the signing and the execution of the foregoing plat to be her voluntary act and deed. In testimony whereof, I have set my seal on the day and date above written.

*Lori J. Meshefski*  
**Lori J. Meshefski**  
Comm Exp.  
6-29-24

**MINOR SUBDIVISION  
SURVEY PLAT OF ALL OF THE LANDS OF  
CAROL MYERS  
SITUATED IN VMS 1457  
WASHINGTON TOWNSHIP, CLINTON COUNTY  
OHIO**

APPROVED FOR MATHEMATICAL ACCURACY  
Clinton County Engineer

Per: *D. Smith*  
Date: **4-28-20**

**CLINTON COUNTY ENGINEERS  
RECORD OF LAND DIVISION**

VOLUME **43** PLAT NO. **78**  
DATE: **4-28-20**  
SCALE: **1" = 200'**

DEED REFERENCE  
VOLUME **909** PAGE **467**  
TOWNSHIP **WASHINGTON**  
MILITARY SURVEY NO. **1457**



- MONUMENT LEGEND**
- Iron Pin (fd) size per plan, if cap exist, name is shown by symbol
  - 5/8" OD Iron Pin (set) with yellow plastic cap stamped: "CLINCO & SUTTON"
  - ⊗ Iron Pin previously (set)
  - ⊗ Iron Pipe (fd) OD size per plan
  - ⊗ Stone (fd)
  - ▲ Railroad Spike (fd)
  - ▲ Railroad Spike (set)
  - ⊗ Mag Nail (set)
  - ⊗ Concrete Monument (fd)
  - PK or Mag Nail (fd)
  - ⊗ Post (fd) size per plan

NOTE: Bearings used are based on NAD 83 (2011) Ohio State Plane Coordinates (South Zone) as derived from GPS Observations. Distances used are based upon Grid distances. The combined scale factor is 0.999896329864. To obtain Ground distances divide the Grid distance by the combined scale factor. Monuments found or set are in good condition unless otherwise labeled. Deeds & Survey Records as noted on drawing are source data for this survey.

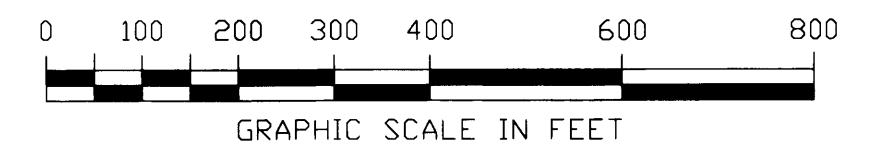

Approved by the Clinton County Regional Planning Commission, no plat required under the Ohio Revised Code 711.131.

*T. Smith* Signed **4-23-2020** Date

NOT SUBJECT TO  
ZONING DEPT. APPROVAL  
*Shelley McClure*  
ZONING INSPECTOR  
DATE **4-23-2020**

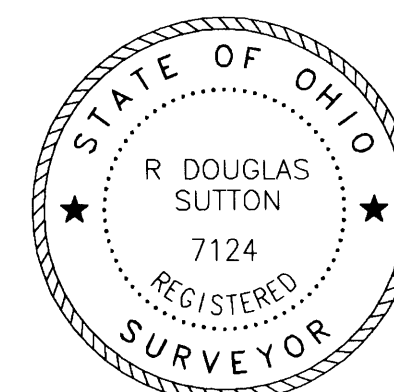

*R. Douglas Sutton*  
**R. DOUGLAS SUTTON**  
OHIO PROFESSIONAL SURVEYOR 7124

**Clinco & Sutton**  
SURVEYORS  
61 SOUTH MULBERRY ST.  
WILMINGTON, OH 45177

JOB NO. **2020/20512**  
DRWG NO. **20512**  
DATE: **APRIL 2020**

Notes:  
The Tract is located in an Un-Zoned District.

The tract shown herein appears to be located within zone "X" (areas outside the 0.2% annual chance floodplain) as depicted on the Flood Insurance Rate Map, Community Panel Number 39027c0275D wqith an effective date of May 3, 2010.

