

CLINTON COUNTY ENGINEERS
RECORD OF LAND DIVISION

VOLUME 43 PLAT NO. 73
DATE: 4.14.20
SCALE: 1" = 200'

DEED REFERENCE
VOLUME O.R. 853 PAGE 315
TOWNSHIP CLARK
MILITARY SURVEY NO. 1939 & 2390

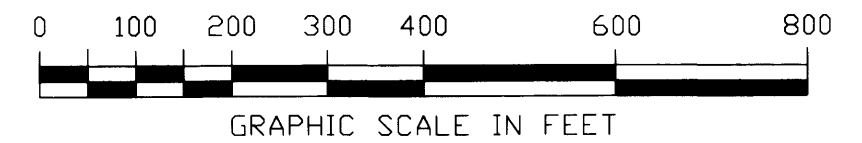

N

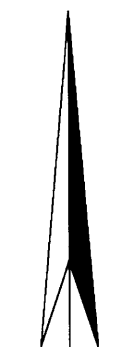

SCALE 1" = 200'

APPROVED FOR MATHEMATICAL ACCURACY
Clinton County Engineer

Per: D. Pull
Date: 4.14.20

Preliminary Access Approval

The Clinton County Engineer

Per: A. FRICKE

Date: 05.07.2020

FINE SWINE LLC
REM. PT. 70.993 AC.
S.R. 33, PLAT NO. 93
O.R. 888, PAGE 19

28.412 ACRES

JP FAMILY FARMS LLC
166.485 AC.
S.R. 34, PLAT NO. 167
O.R. 853, PAGE 315

JP FAMILY FARMS LLC
65.372 AC.
-28.412 AC.
S.R. 33, PLAT NO. 110
O.R. 853, PAGE 315

CHARLES & JEANETTE FULLER
5.001 AC.
S.R. 33, PLAT NO. 110
O.R. 665, PAGE 785

JP FAMILY FARMS LLC
78.423 AC.
S.R. 33, PLAT NO. 110
O.R. 853, PAGE 315

SURVEY PLAT OF PART OF THE LANDS OF
JP FAMILY FARMS, LLC
SITUATED IN VMS 1939 & 2390
CLARK TOWNSHIP, CLINTON COUNTY
OHIO

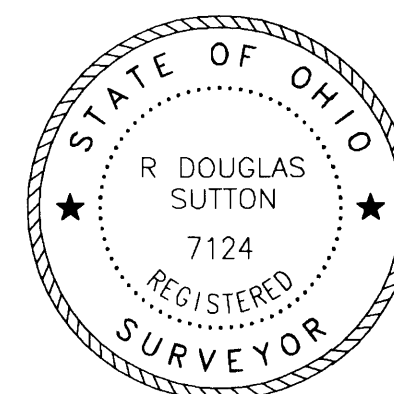

R. Douglas Sutton
R. DOUGLAS SUTTON
OHIO PROFESSIONAL SURVEYOR 7124

- MONUMENT LEGEND —
- Iron Pin (fd) size per plan, if cap exist, name is shown by symbol
 - 5/8" OD Iron Pin (set) with yellow plastic cap stamped: "CLINCO & SUTTON"
 - ⊙ Iron Pin previously (set)
 - ⊙ Iron Pipe (fd) OD size per plan
 - ⊗ Stone (fd)
 - ▲ Railroad Spike (fd)
 - △ Railroad Spike (set)
 - ⊕ Mag Nail (set)
 - ⊠ Concrete Monument (fd)
 - PK or Mag Nail (fd)
 - ⊘ Post (fnd) size per plan

NOTE: Bearings used are based on NAD 83 (2011) Ohio State Plane Coordinates (South Zone) as derived from GPS Observations. Distances used are based upon Grid distances. The combined scale factor is 0.999895442820. To obtain Ground distances divide the Grid distance by the combined scale factor. Monuments found or set are in good condition unless otherwise labeled. Deeds & Survey Records as noted on drawing are source data for this survey.

NOT SUBJECT TO
ZONING DEPT. APPROVAL
Shelley McCune
ZONING INSPECTOR
DATE 4.23.2020

Clinco & Sutton
SURVEYORS
61 SOUTH MULBERRY ST.
WILMINGTON, OH 45177

JOB NO. 2020/20513
DRWG NO. 20513
DATE: APRIL 2020