

CLINTON COUNTY ENGINEERS
RECORD OF LAND DIVISION

VOLUME 43 PLAT NO. 188
DATE: 8-18-21
SCALE: 1"= 60'

DEED REFERENCE
VOLUME O.R. 499 PAGE 142
TOWNSHIP WASHINGTON
MILITARY SURVEY NO. 2026

APPROVED FOR MATHEMATICAL ACCURACY
Clinton County Engineer

Per: shall
Date: 8-18-21

SURVEY PLAT OF THE LANDS OF
STEVE SWINGLEY & LINDA SCHARCK
AKA LINDA SCHRACK
SITUATED IN VMS 2026
WASHINGTON TOWNSHIP, CLINTON COUNTY
OHIO

— MONUMENT LEGEND —

- Iron Pin (fd) size per plan, if cap exist, name is shown by symbol
- 5/8" OD Iron Pin (set) with yellow plastic cap stamped: "CLINCO & SUTTON"
- ⊙ Iron Pin previously (set)
- ⊙ Iron Pipe (fd) OD size per plan
- ⊗ Stone (fd)
- ▲ Railroad Spike (fd)
- △ Railroad Spike (set)
- ⊕ Mag Nail (set)
- ⊠ Concrete Monument (fd)
- PK or Mag Nail (fd)
- ⌀ Post (fnd) size per plan

NOTE: Bearings used are based on NAD 83 (2011) Ohio State Plane Coordinates (South Zone) as derived from GPS Observations. Distances used are based upon Grid distances. The combined scale factor is 0.9998962798. To obtain Ground distances divide the Grid distance by the combined scale factor. Monuments found or set are in good condition unless otherwise labeled. Deeds & Survey Records as noted on drawing are source data for this survey.

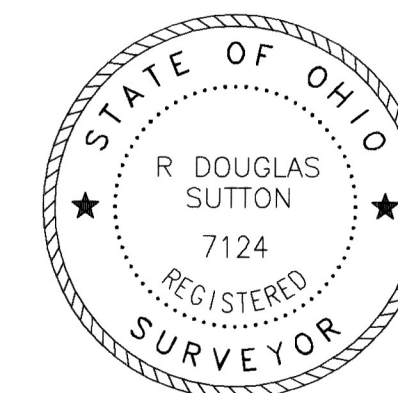

R. Douglas Sutton
R. DOUGLAS SUTTON
OHIO PROFESSIONAL SURVEYOR 7124

Clinco & Sutton
SURVEYORS

61 SOUTH MULBERRY ST.
WILMINGTON, OH 45177

JOB NO. 2021/21610
DRWG NO. 21610
DATE: JULY 22, 2021

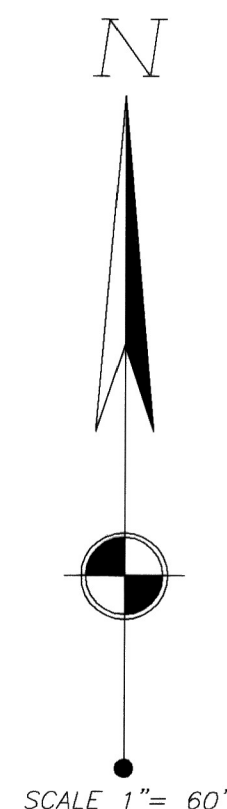

0 30 60 90 120 180 240
GRAPHIC SCALE IN FEET

N30°54'09"W 1283.35' TO MAG NAIL FD.
MARKING INTERSECTION OF CHAMPLIN ROAD
AND DALTON ROAD

VERNON L. &
DEBRA L. HELTON
1.373 AC.
S.R. 34, PLAT NO. 299
O.R. 989, PG. 548

NANCY R. LEWIS AND
GARY L. NORTON
5.010 AC.
S.R. 28, PLAT NO. 145
DOC. NO. 2021-00003153

"SOUTHWEST LAND SURVEYS"

0.898 ACRES
(ORIGINALLY 0.91 AC.)

ALEXIS CUNAGIN AND
FRANK L. HAER, IV
5.745 AC.
S.R. 28, PLAT NO. 106
DOC. NO. 2020-00006461

HARRY TOM NEANOVER
0.855 AC.
S.R. 36, PLAT NO. 30
O.R. 682, PG. 593

CHAMPLIN ROAD
40' RW

N67°23'01"E 229.70'
"ASAP" IP FD. ● 19.95'
P.O.B.
S14°06'06"E 201.98'
IP SET ● 20.00'
S73°46'05"W 183.61'
5/8"