

CLINTON COUNTY ENGINEERS
RECORD OF LAND DIVISION

VOLUME 43 PLAT NO. 155
DATE: 6-2-21
SCALE: 1" = 100'

DEED REFERENCE
VOLUME O.R. 745 PAGE 407
TOWNSHIP WASHINGTON
MILITARY SURVEY NO. 2386

SURVEY PLAT OF PART OF THE LANDS OF
MILTON W. VANDERVORT, REGINA C. VANDERVORT
& BRIAN J. & REGINA L. VANDERVORT
VMS 2386
WASHINGTON TOWNSHIP, CLINTON COUNTY
OHIO

MILTON W. & REGINA C. VANDERVORT
BRIAN J. & REGINA L. VANDERVORT
67.020 AC.
-2.195 AC.
S.R. 37, PLAT NO. 292
OFFICIAL RECORD 745, PAGE 407

KIMBERLY DANIEL DE ACHA &
RAFAEL J. DE ACHA
34.05 AC. ~ TRACT 2
OFFICIAL RECORD 1002, PAGE 628

MILTON W. & REGINA C. VANDERVORT
2.000 AC.
S.R. 16, PLAT NO. 173
OFFICIAL RECORD 509, PAGE 773

KIMBERLY DANIEL DE ACHA &
RAFAEL J. DE ACHA
12.13 AC. ~ TRACT 3
OFFICIAL RECORD 1002, PAGE 628

- MONUMENT LEGEND —
- Iron Pin (fd) size per plan, if cap exist, name is shown by symbol
 - 5/8" OD Iron Pin (set) with yellow plastic cap stamped: "CLINCO & SUTTON"
 - ⊙ Iron Pin previously (set)
 - ⊗ Iron Pipe (fd) OD size per plan
 - ⊠ Stone (fd)
 - ▲ Railroad Spike (fd)
 - △ Railroad Spike (set)
 - ⊕ Mag Nail (set)
 - ⊞ Concrete Monument (fd)
 - PK or Mag Nail (fd)
 - ⊗ Post (fnd) size per plan

NOTE: Bearings used are based on NAD 83 (2011) Ohio State Plane Coordinates (South Zone) as derived from GPS Observations. Distances used are based upon Grid distances. The combined scale factor is 0.9998944026. To obtain Ground distances divide the Grid distance by the combined scale factor. Monuments found or set are in good condition unless otherwise labeled. Deeds & Survey Records as noted on drawing are source data for this survey.

NOTE: THE 2.195 ACRE TRACT IS TO BE CONVEYED TO MILTON W. & REGINA C. VANDERVORT (ADJOINING LAND OWNERS) AND SHALL NOT CREATE AN INDEPENDENT BUILDING SITE AS ALLOWED UNDER SECTION 711.001 OF THE OHIO REVISED CODE.

NOT SUBJECT TO HEALTH
DEPARTMENT APPROVAL

Not shown

NOT SUBJECT TO
ZONING DEPT. APPROVAL
WALT DANIEL
ZONING INSPECTOR
DATE 5-27-2021

APPROVED FOR MATHEMATICAL ACCURACY
Clinton County Engineer

Per: Wall
Date: 6-2-21

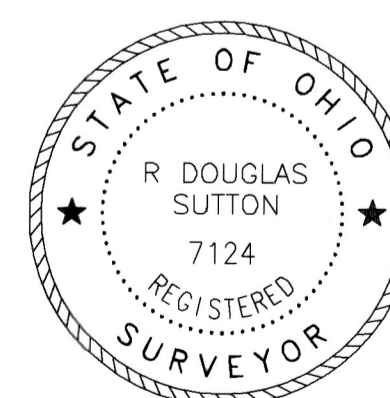

R. Douglas Sutton
R. DOUGLAS SUTTON
OHIO PROFESSIONAL SURVEYOR 7124

Clinco & Sutton
SURVEYORS
61 SOUTH MULBERRY ST.
WILMINGTON, OH 45177

JOB NO. 2021/21594
DRWG NO. 21594
DATE: MAY 2021

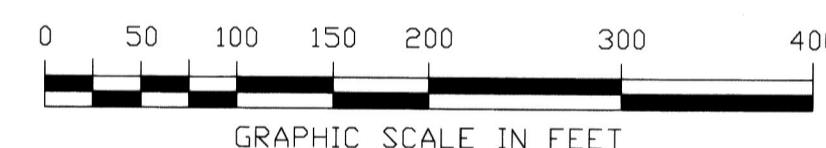

SCALE 1" = 100'

