

SURVEY PLAT OF PART OF THE LANDS OF
KEITER FAMILY LLC
SITUATED IN VMS 986 & 2433
UNION TOWNSHIP, CLINTON COUNTY,
OHIO

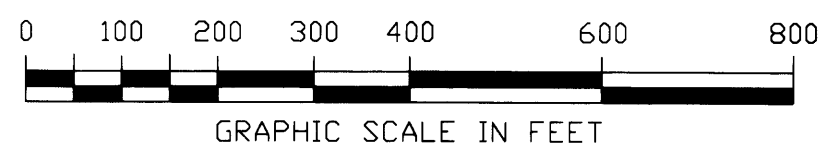

CLINTON COUNTY ENGINEERS
RECORD OF LAND DIVISION

VOLUME 43 PLAT NO. 215
DATE: 3-2-21
SCALE: 1" = 200'

DEED REFERENCE
VOLUME O.R. 733 PAGE 698
TOWNSHIP UNION
MILITARY SURVEY NO. 986/2433

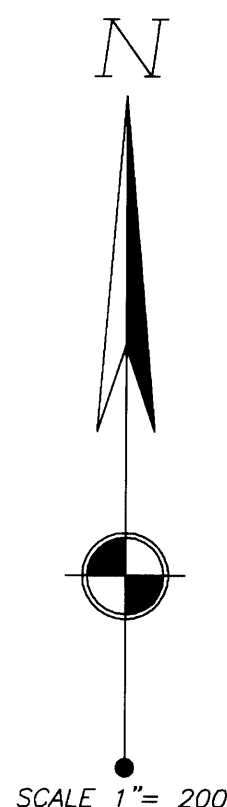

SUZANNE E. FENNESSY, TRUSTEE
59.586 AC.
S.R. 43, PLAT NO. 28
DOC NO. 2019-00005691

KEITER FAMILY LLC
69.000 AC.
S.R. 16, PLAT NO. 31
O.R. 733, PAGE 698

VMS 885
VMS 986/2433

- MONUMENT LEGEND —
- Iron Pin (fd) size per plan, if cap exist, name is shown by symbol
 - 5/8" OD Iron Pin (set) with yellow plastic cap stamped: "CLINCO & SUTTON"
 - ⊙ Iron Pin previously (set)
 - ⊖ Iron Pipe (fd) OD size per plan
 - ⊠ Stone (fd)
 - ▲ Railroad Spike (fd)
 - △ Railroad Spike (set)
 - ⊕ Mag Nail (set)
 - ⊞ Concrete Monument (fd)
 - PK or Mag Nail (fd)
 - ⊘ Post (fnd) size per plan

NOTE: Bearings used are based on NAD 83 (2011) Ohio State Plane Coordinates (South Zone) as derived from GPS Observations. Distances used are based upon Grid distances. The combined scale factor is 0.999897555897. To obtain Ground distances divide the Grid distance by the combined scale factor. Monuments found or set are in good condition unless otherwise labeled. Deeds & Survey Records as noted on drawing are source data for this survey.

APPROVED FOR MATHEMATICAL ACCURACY
Clinton County Engineer

Per: W Hall
Date: 3-2-21

NOTE: THE 15.902 ACRE TRACT IS INTENDED TO BE CONVEYED TO SUZANNE E. FENNESSY TRUSTEE (ADJOINING LAND OWNER) AND SHALL NOT CREATE AN INDEPENDENT BUILDING SITE AS ALLOWED UNDER SECTION 711.001 OF THE OHIO REVISED CODE.

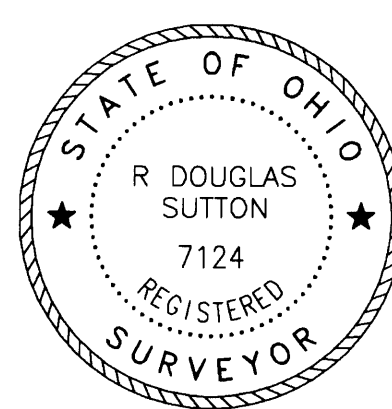

R. Douglas Sutton
R. DOUGLAS SUTTON
OHIO PROFESSIONAL SURVEYOR 7124

Clinco & Sutton
SURVEYORS
61 SOUTH MULBERRY ST.
WILMINGTON, OH 45177

JOB NO. 2021/21574
DRWG NO. SHEET 2
DATE: JANUARY 2021

15.902 ACRES

NOT SUBJECT TO HEALTH
DEPARTMENT APPROVAL

W. H. Sutton
2-25-21

APPROVED
CLINTON COUNTY ZONING DEPT.

PER one for W. H. Sutton
DATE 2.26.2021 11-3

SUZANNE E. FENNESSY TRUSTEE
173.806 AC.
S.R. 39, PLAT NO. 246
O.R. 860, PAGE 636

JOHN M. & KAREN STANFORTH
O.R. 245, PAGE 119
JOHN M. STANFORTH TRUSTEE
O.R. 339, PAGE 134
S.R. 77, 929 AC. 91
S.R. 28, PAGE 91

N52°08'53"E 181.08'
DITCH

T.P.O.B.

5/8" (2' DEEP)

S68°58'46"E 1171.68'

N40°20'01"W 1309.29'

S51°36'28"W 774.78'

N51°36'28"E 378.48'

BROKEN TEE-POST

5/8"

5/8" IP TO 15.98' P.O.C.

BENNETT ROAD
40' RW

10' STONE ROAD