

CLINTON COUNTY ENGINEERS  
RECORD OF LAND DIVISION

VOLUME 43 PLAT NO. 214  
DATE: 3-2-21  
SCALE: 1"= 200'

DEED REFERENCE  
VOLUME O.R. 733 PAGE 687  
TOWNSHIP UNION  
MILITARY SURVEY NO. 986/2433

SURVEY PLAT OF PART OF THE LANDS OF  
KEITER FAMILY LLC  
SITUATED IN VMS 986 & 2433  
UNION TOWNSHIP, CLINTON COUNTY,  
OHIO

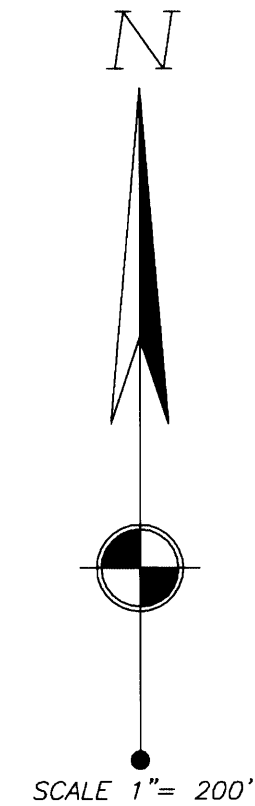
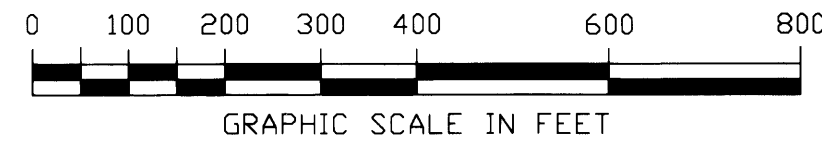

SCALE 1"= 200'

SUZANNE E. FENNESSY TRUSTEE  
70.441 AC.  
S.R. 41, PLAT NO. 11  
O.R. 935, PAGE 648

KEITER FAMILY LLC  
3.751 AC.  
S.R. 16, PLAT NO. 290  
O.R. 733, PAGE 706

KEITER FAMILY LLC  
90.207 AC.  
S.R. 16, PLAT NO. 290  
O.R. 733, PAGE 682

NOT SUBJECT TO HEALTH  
DEPARTMENT APPROVAL

*Walt Davis*  
2-26-21

APPROVED  
CLINTON COUNTY ZONING DEPT.

PER *for Walt Davis*  
DATE 2-26-2021 ZONED A-3

43.684 ACRES

SUZANNE E. FENNESSY TRUSTEE  
S.R. 39, PLAT NO. 246  
O.R. 860, PAGE 636

KEITER FAMILY LLC  
REM. PT. 124 AC.  
O.R. 733, PAGE 687

RODNEY S. & KATHY L. BENNETT  
S.R. 18, PLAT NO. 40  
O.R. 574, PAGE 108

RODNEY S. & KATHY L. BENNETT  
S.R. 15, PLAT NO. 2  
O.R. 574, PAGE 126

- MONUMENT LEGEND —
- Iron Pin (fd) size per plan, if cap exist, name is shown by symbol
  - 5/8" OD Iron Pin (set) with yellow plastic cap stamped: "CLINCO & SUTTON"
  - Iron Pin previously (set)
  - Iron Pipe (fd) OD size per plan
  - ⊗ Stone (fd)
  - ▲ Railroad Spike (fd)
  - △ Railroad Spike (set)
  - ⊕ Mag Nail (set)
  - ⊞ Concrete Monument (fd)
  - PK or Mag Nail (fd)
  - ⊗ Post (fd) size per plan

NOTE: Bearings used are based on NAD 83 (2011) Ohio State Plane Coordinates (South Zone) as derived from GPS Observations. Distances used are based upon Grid distances. The combined scale factor is 0.999897555897. To obtain Ground distances divide the Grid distance by the combined scale factor. Monuments found or set are in good condition unless otherwise labeled. Deeds & Survey Records as noted on drawing are source data for this survey.

NOTE: THE 43.684 ACRE TRACT IS TO BE CONVEYED TO SUZANNE E. FENNESSY TRUSTEE (ADJOINING LAND OWNER) AND SHALL NOT CREATE AN INDEPENDENT BUILDING SITE AS ALLOWED UNDER SECTION 711.001 OF THE OHIO REVISED CODE.

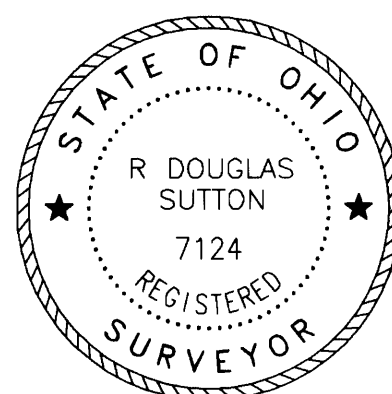

*R. Douglas Sutton*  
R. DOUGLAS SUTTON  
OHIO PROFESSIONAL SURVEYOR 7124

APPROVED FOR MATHEMATICAL ACCURACY  
Clinton County Engineer

Per: Walt  
Date: 3-2-21

**Clinco & Sutton**  
SURVEYORS

61 SOUTH MULBERRY ST.  
WILMINGTON, OH 45177

JOB NO. 2021/21574

DRWG NO. SHEET 1

DATE: JANUARY 2021