

MINOR SUBDIVISION
HORMELL ROAD
PART OF MILITARY SURVEY 3916
CHESTER TOWNSHIP, CLINTON COUNTY, OHIO
CONTAINING 20.014 TOTAL ACRES

CLINTON COUNTY ENGINEER'S
RECORD OF LAND SURVEYS
VOLUME 43, PLAT 210
DEED REFERENCE: O.R. 1026, PAGE 665

APPROVED FOR MATHEMATICAL ACCURACY
Clinton County Engineer

Per: [Signature]
Date: 02-12-21

LEGEND

- 5/8" x 30" IRON REBAR SET WITH A YELLOW CESO CAP
- MAG SPIKE SET
- ⊙ 5/8" IRON PIN FOUND AS NOTED
- ⊗ RAILROAD SPIKE FOUND
- MARKER POST FOUND

- BOUNDARY LINE
- ADJOINER LINE
- RIGHT-OF-WAY LINE
- EASEMENT LINE
- FENCE LINE
- OLD RAILROAD RIGHT-OF-WAY LINE

VICINITY MAP:
NOT TO SCALE

MICHAEL &
ANNE WEIKERT
O.R. 334, PAGE 224
SURVEY 30-261
SURVEY 30-5

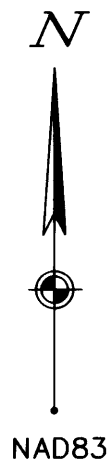

OHIO RIDERS FARMS
O.R. 74, PAGE 876

WILLIAM E. & MIKKI BAHL
O.R. 420, PAGE 618
SURVEY 13-133

WILLIAM E. & MIKKI BAHL
O.R. 420, PAGE 618
SURVEY 13-133

JASON SISCO
O.R. 1026, PAGE 665
20.00 ACRES (PER DEED)
SURVEY 13-133

WILLIAM E. & MIKKI BAHL
O.R. 420, PAGE 618
SURVEY 13-133

TRACT 1
10.000 AC
INCLUDING 0.093 ACRES
WITHIN THE R/W OF HORMELL ROAD
(NET ACREAGE = 9.907)
CURRENT ZONING IS A-3

TRACT 2
10.014 AC
INCLUDING 0.215 ACRES
WITHIN THE R/W OF HORMELL ROAD
(NET ACREAGE = 9.799)
CURRENT ZONING IS A-3

Approved by the Clinton County Regional
Planning Commission; no plat required
under the Ohio Revised Code 711.131.

Signed: [Signature] Date: 2-2-21

APPROVED
CLINTON COUNTY ZONING DEPT.

PER [Signature]
DATE: 2-2-21 ZONED A-3

OWNERS STATEMENT

I, Jason Sisco DO HEREBY STATE THAT
WE ARE THE OWNERS OF THE PROPERTY SHOWN ON THIS PLAT
AND THAT WE HAVE ORDERED THAT SAID PROPERTY BE SURVEYED
AND SUBDIVIDED AS SHOWN.

OWNER: [Signature]

STATE OF OHIO, COUNTY OF CLINTON, S.S.,
BE IT REMEMBERED THAT ON THIS DAY, BEFORE ME A NOTARY
PUBLIC, CAME Jason Sisco
AND ACKNOWLEDGED THEIR SIGNING AND EXECUTION OF THIS
PLAT TO BE THEIR VOLUNTARY ACT AND DEED.

[Signature] 2/12/21
NOTARY PUBLIC, STATE OF OHIO DATE

MY COMMISSION EXPIRES ON June 29, 2022



Danette L. Garringer
Notary Public
In and For the State of Ohio
My Commission Expires
29th Day of June, 2022

STEVEN W. &
LORRI K. BRANNAN
SURVEY 12-169

Preliminary Access Approval

The Clinton County Engineer
Per A. FRICKE
Date: 1-27-2021

MINOR SUBDIVISION APPROVAL
Meets State Minimum Survey Requirements
Engineers Map Office Date: 1-27-2021
Per [Signature]
Drainage and Driveway Approval
Clinton County Engineer Date: 1-27-2021
Per A. FRICKE

FRANK &
PAULA ROBINSON
DOC. NO. 2019-00004469
LOT 15
HAZELWOOD HILLS
SUBDIVISION
P.B. 7, PAGE 12D

CLINTON COUNTY HEALTH DISTRICT

APPROVED: [Signature]
DATE: 2/1/21 TITLE: Ext. Director

GRAPHIC SCALE

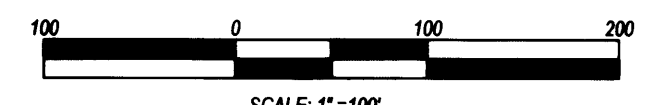

SURVEYOR'S NOTES

SURVEYOR'S CERTIFICATION:

I HEREBY CERTIFY THAT THIS PLAT OF SURVEY WAS PREPARED
UNDER MY DIRECT SUPERVISION, AND BASED ON AN ACTUAL
FIELD SURVEY, COMPLETED IN SEPTEMBER OF 2020, AND WAS
MADE IN ACCORDANCE WITH THE STATE OF OHIO MINIMUM
STANDARDS FOR BOUNDARY SURVEYS, OAC 4733-37.

SIGNED: [Signature] 1/16/2021
MICHAEL JAY WILSON P.S.
OHIO P.S. NO. 8281
MICHAEL.WILSON@CESOINC.COM

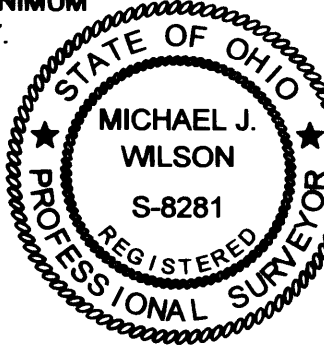

- NORTH BASED UPON THE OHIO STATE PLANE SOUTH COORDINATE SYSTEM (NAD83) AS ESTABLISHED USING GPS OBSERVATIONS ALONG WITH THE O.D.O.T. VRS NETWORK. SCALED TO GROUND AT LAT. N39°33'09.68752", LONG. 83°56'39.77169" WITH A SCALE FACTOR OF 1.00010130649715 AND A PROJECT HEIGHT OF 868.063 FEET.
- THIS SURVEY WAS PREPARED IN THE ABSENCE OF A COMPLETE AND ACCURATE TITLE SEARCH.
- ALL PERTINENT DOCUMENTS USED TO DETERMINE THE BOUNDARY SHOWN HEREON ARE ON FILE AT THE CLINTON COUNTY RECORDER'S OFFICE, WILMINGTON, OHIO.
- TRACT 2 HAS A GAS LINE EASEMENT RUNNING THROUGH IT. THE ACTUAL LOCATION OF THE EASEMENT DOES NOT APPEAR TO AGREE WITH THE PHYSICAL LOCATION OF THE PIPELINE. THE OWNER OF THE PROPERTY HAS BEEN MADE AWARE OF THE SITUATION.

OWNER

JACKIE & JASON SISCO
4180 E. CENTERVILLE RD.
SPRING VALLEY, OH 45370

SURVEYOR

MICHAEL WILSON
CESO INC.
3601 RIGBY ROAD, SUITE 300
MIAMISBURG, OHIO 45342
937.396.6896

REVISIONS

NO.	DATE	DESCRIPTION

MINOR SUBDIVISION

SISCO PROPERTY

HORMELL ROAD CHESTER TOWNSHIP		PART OF MILITARY SURVEY 3916 CLINTON COUNTY, OHIO	
SCALE: 1" = 100'		DATE: 10-22-2020	
DESIGN: N/A		JOB NO.: 758359	1 OF 1
DRAWN: JKH		SHEET NO.:	
CHECKED: MJW			