

CLINTON COUNTY ENGINEERS
RECORD OF LAND DIVISION

VOLUME 43 PLAT NO. 203
DATE: 2-2-21
SCALE: 1"= 100'

DEED REFERENCE
VOLUME O.R. 361 PAGE 8
TOWNSHIP CHESTER
MILITARY SURVEY NO. 2246

N

SCALE 1"= 100'

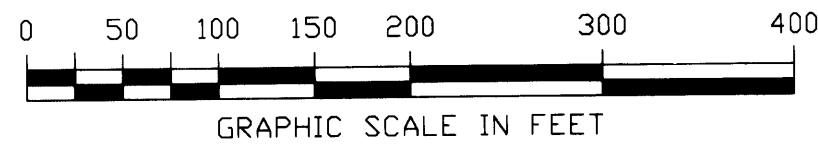

GRAPHIC SCALE IN FEET

CHARLES H. & MARY L. BUSH TRUSTEES
REM. PT. 66.70 AC.
O.R. 142, PAGE 806

APPROVED FOR MATHEMATICAL ACCURACY
Clinton County Engineer

Per: Mall
Date: 2-2-21

APPROVED
CLINTON COUNTY ZONING DEPT.

PER [Signature]
DATE 2-2-21 ZONED 943

NOTE: THE ABOVE DESCRIBED 3.113 ACRE TRACT SHALL BE CONVEYED TO
ORVILLE AND WANDA J. WILLIAMS, TRUSTEES (ADJOINING LAND OWNERS) AND
SHALL NOT CREATE AN INDEPENDENT BUILDING SITE AS ALLOWED UNDER
SECTION 711.01 OF THE OHIO REVISED CODE.

SURVEY PLAT OF THE LANDS OF
ORVILLE & WANDA J. WILLIAMS TRUSTEES
OF THE WANDA J. WILLIAMS REVOCABLE LIVING TRUST
SITUATED IN VMS 2246
CHESTER TOWNSHIP, CLINTON COUNTY
OHIO

ORVILLE & WANDA J. WILLIAMS TRUSTEES
OF THE WANDA J. WILLIAMS REVOCABLE LIVING TRUST
6.301 AC.
S.R. 13, PLAT NO. 32
O.R. 361, PAGE 8

3.113 ACRES

NOT SUBJECT TO HEALTH
DEPARTMENT APPROVAL

[Signature]
2-1-21

ORVILLE & WANDA J. WILLIAMS TRUSTEES
OF THE WANDA J. WILLIAMS REVOCABLE LIVING TRUST
REMAINING PART ORIGINAL 62.184 AC.
-3.113 AC.
S.R. 20, PLAT NO. 99
O.R. 361, PAGE 8

MONUMENT LEGEND

- Iron Pin (fd) size per plan, if cap exist, name is shown by symbol
- 5/8" OD Iron Pin (set) with yellow plastic cap stamped: "CLINCO & SUTTON"
- Iron Pin previously (set)
- ⊙ Iron Pipe (fd) OD size per plan
- ⊠ Stone (fd)
- ▲ Railroad Spike (fd)
- △ Railroad Spike (set)
- ⊕ Mag Nail (set)
- ⊞ Concrete Monument (fd)
- PK or Mag Nail (fd)
- ⊘ Post (fd) size per plan

NOTE: Bearings used are based on NAD 83
(2011) Ohio State Plane Coordinates (South Zone)
as derived from GPS Observations. Distances
used are based upon Grid distances.
The combined scale factor is 0.999901608288.
To obtain Ground distances divide the Grid
distance by the combined scale factor.
Monuments found or set are in good
condition unless otherwise labeled.
Deeds & Survey Records as noted on
drawing are source data for this survey.

CHRISTOPHER ALAN CONGER
REM. PT. 48.560 AC.
S.R. 20, PLAT NO. 99
O.R. 620, PAGE 401

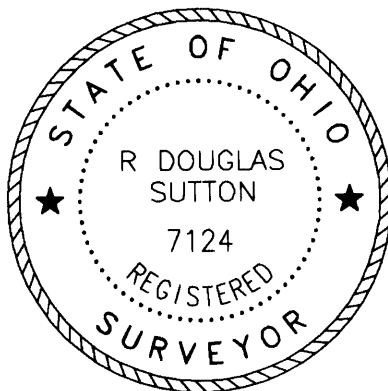

[Signature]
R. DOUGLAS SUTTON
OHIO PROFESSIONAL SURVEYOR 7124

Clinco & Sutton
SURVEYORS
61 SOUTH MULBERRY ST.
WILMINGTON, OH 45177

JOB NO. 2021/21567
DRWG NO. 21567
DATE: JANUARY 2021