

CLINTON COUNTY ENGINEERS
RECORD OF LAND DIVISION

VOLUME 43 PLAT NO. 111
DATE: 7-28-20
SCALE: 1" = 100'

DEED REFERENCE
VOLUME O.R. 866 PAGE 20
TOWNSHIP VERNON
MILITARY SURVEY NO. 2706

SURVEY PLAT OF PART OF THE LANDS OF
DONALD F. FELDMEYER, TRUSTEE OF THE
DEER LAKE FARM TRUST
SITUATED IN VMS 2706
VERNON TOWNSHIP, CLINTON COUNTY
OHIO

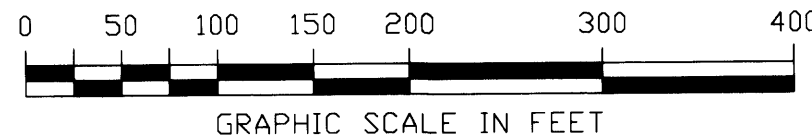

JUSTIN & MINDA CROMER
REM. PT. 20.387 AC.
-1.124 AC.
S.R. 20, PLAT NO. 298
DOC. NO. 2019-00002640

DONALD F. FELDMEYER, TRUSTEE
OF THE DEER LAKE FARM TRUST
15.476 AC.
-1.124 AC.
S.R. 20, PLAT NO. 298
OFFICIAL RECORD 727, PAGE 546
OFFICIAL RECORD 866, PAGE 20

MARK E. & MARGIE D. SCHMEES
S.R. 12, PLAT NO. 504
O.R. 629, PAGE 605

NOT SUBJECT TO HEALTH
DEPARTMENT APPROVAL

[Signature]
7-27-20

APPROVED FOR MATHEMATICAL ACCURACY
Clinton County Engineer

Per: Uhall
Date: 7-28-20

NOT SUBJECT TO
ZONING DEPT. APPROVAL

ZONING INSPECTOR
DATE 7-28-20

Clinco & Sutton
SURVEYORS
61 SOUTH MULBERRY ST.
WILMINGTON, OH 45177

JOB NO. 2019/19446
DRWG NO. 19446/2020
DATE: JULY 2020

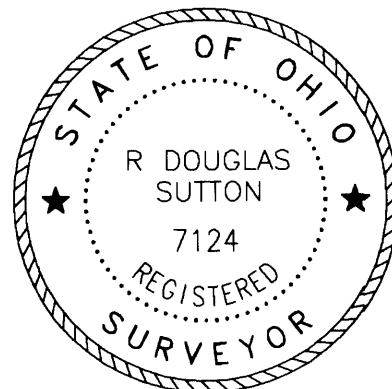

[Signature]
R. DOUGLAS SUTTON
OHIO PROFESSIONAL SURVEYOR 7124

DONALD F. FELDMEYER TRUSTEE
OF THE DEER LAKE FARM TRUST
14.151 AC.
S.R. 20, PLAT NO. 298
OFFICIAL RECORD 866, PAGE 22

N

SCALE 1" = 100'

- MONUMENT LEGEND —
- Iron Pin (fd) size per plan, if cap exist, name is shown by symbol
 - 5/8" OD Iron Pin (set) with yellow plastic cap stamped: "CLINCO & SUTTON"
 - ⊙ Iron Pin previously (set)
 - ⊗ Iron Pipe (fd) OD size per plan
 - ⊠ Stone (fd)
 - ▲ Railroad Spike (fd)
 - △ Railroad Spike (set)
 - ⊕ Mag Nail (set)
 - ⊞ Concrete Monument (fd)
 - PK or Mag Nail (fd)
 - ⊘ Post (fnd) size per plan

NOTE: Bearings used are based on NAD 83 (2011) Ohio State Plane Coordinates (South Zone) as derived from GPS Observations. Distances used are based upon Grid distances.
The combined scale factor is 0.99989979824. To obtain Ground distances divide the Grid distance by the combined scale factor.
Monuments found or set are in good condition unless otherwise labeled.
Deeds & Survey Records as noted on drawing are source data for this survey.

NOTE: THE 1.124 ACRE TRACT IS TO BE RETAINED BY DONALD F. FELDMEYER, TRUSTEE OF THE DEER LAKE FARM TRUST AND IS TO BE ATTACHED TO HIS ADJOINING 14.151 ACRE TRACT AND SHALL NOT CREATE AN INDEPENDENT BUILDING SITE AS ALLOWED UNDER SECTION 711.01 OF THE OHIO REVISED CODE.