

DONALD & VIRGINIA JACKSON  
2.505 AC.  
S.R. 27, PLAT NO. 206  
O.R. 878, PAGE 296

DARREN S. DAVIS  
2.505 AC.  
S.R. 28, PLAT NO. 25  
O.R. 550, PAGE 344

HANEY ROAD 50' RW

SURVEYORS RECORD  
Book 43 Page 102

APPROVED FOR MATHEMATICAL ACCURACY  
Clinton County Engineer  
Per: [Signature]  
Date: 6-15-20

FINAL PLAT  
HANEY & HALE SUBDIVISION  
SITUATED IN VMS 2371  
ADAMS TOWNSHIP  
CLINTON COUNTY  
OHIO

302JP-00000004  
KIND: PLAT OF SURVEY RECORDS (PLAT BOOK)  
RECORDED: 06/15/2020 02:36:17 PM  
FEE AMT: \$0.00  
CLINTON COUNTY, OHIO  
BRENDA J. HUFF, RECORDER  
BK 8 ENV 179 A

### DESCRIPTION

THE WITHIN PLAT CONTAINS 25.992 ACRES OF LAND AND BEING ALL OF THE REMAINING PART OF A 29.86 ACRE TRACT WHICH INCLUDES PART OF LOTS 28, 31, & 40 AND ALL OF LOTS 29, 30, 34, 35, 36, 37 & 41 THROUGH 45 OF JIMMIE D. & GERALDINE CREDIT SUBDIVISION BLOCK "B" AS RECORDED IN CLINTON COUNTY PLAT BOOK 6, PAGE 239 ENVELOPE 151A AND BEING CONVEYED BY DEED TO DONALD R. JOHNSON AND SHARON M. JOHNSON AS RECORDED IN VOLUME 708, PAGE 451 OF THE CLINTON COUNTY OFFICIAL RECORDS.

### DEDICATION AND ACKNOWLEDGEMENT

WE, THE UNDERSIGNED BEING THE OWNERS OF THE LANDS HEREIN PLATTED, DO HEREBY VOLUNTARILY CONSENT TO THE EXECUTION OF THIS PLAT AND DO HEREBY DEDICATE THE ROAD RIGHT OF WAY AS SHOWN TO THE PUBLIC USE FOREVER.

[Signature]  
DONALD R. JOHNSON

[Signature]  
SHARON M. JOHNSON

[Signature]  
WITNESS

[Signature]  
WITNESS

### STATE OF OHIO, COUNTY OF CLINTON, S.S.

BE IT REMEMBERED ON THIS 3 DAY OF June, 2020 BEFORE ME, THE UNDERSIGNED, A NOTARY PUBLIC IN AND FOR SAID COUNTY AND STATE, PERSONALLY CAME DONALD R. JOHNSON AND SHARON M. JOHNSON, TO ME KNOWN, DO HEREBY ACKNOWLEDGE AND VOLUNTARY CONSENT TO THE EXECUTION OF THIS PLAT.

IN TESTIMONY WHEREOF, I HAVE HEREUNTO SET MY HAND AND AFFIXED MY SEAL ON THE DATE ABOVE MENTIONED.

[Signature]  
NOTARY PUBLIC



TABATHA KENNEDY  
Notary Public, State of Ohio  
My Commission Expires: July 1, 2024  
Recorded in Clinton County

### CLINTON COUNTY ZONING

I HEREBY APPROVE THIS PLAT ON THIS 10 DAY OF June, 2020.

[Signature]  
CLINTON COUNTY ZONING INSPECTOR

R-R  
CURRENT ZONING

### CLINTON COUNTY REGIONAL PLANNING

THIS PLAT WAS APPROVED BY THE CLINTON COUNTY REGIONAL PLANNING COMMISSION OF THIS 10 DAY OF June, 2020.

[Signature]  
EXECUTIVE DIRECTOR

### CLINTON COUNTY ENGINEER

I HEREBY APPROVE THIS PLAT ON THIS 10 DAY OF June, 2020.

[Signature]  
CLINTON COUNTY ENGINEER

### CLINTON COUNTY HEALTH DISTRICT

I HEREBY APPROVE THIS PLAT ON THIS 11 DAY OF June, 2020.

[Signature]  
CLINTON COUNTY HEALTH DEPARTMENT

### CLINTON COUNTY COMMISSIONERS

WE, THE BOARD OF COUNTY COMMISSIONERS OF CLINTON COUNTY, OHIO, DO HEREBY APPROVE THIS PLAT ON THIS 15th DAY OF June, 2020.

COMMISSIONERS:

Not Present  
COMMISSIONER

[Signature]  
COMMISSIONER

[Signature]  
COMMISSIONER

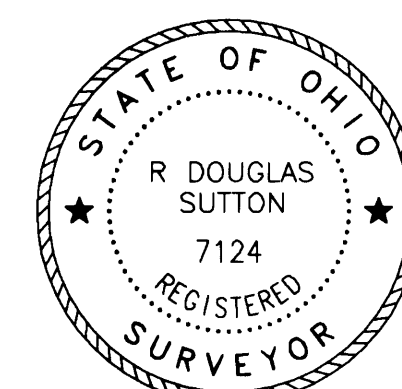

I HEREBY CERTIFY THAT THIS PLAT IS A TRUE AND COMPLETE SURVEY THAT WAS MADE UNDER MY DIRECTION IN MARCH 2020, AND THAT ALL MONUMENTS FOUND AND OR SET ARE AS SHOWN.

[Signature]  
R. DOUGLAS SUTTON  
OHIO PROFESSIONAL SURVEYOR 7124

**Clinco & Sutton**  
SURVEYORS  
61 SOUTH MULBERRY ST.  
WILMINGTON, OH 45177

JOB NO. 2020/20495  
DRWG NO. 20495  
DATE: MARCH 2020

- MONUMENT LEGEND —
- Iron Pin (fd) size per plan, if cap exist, name is shown by symbol
  - 5/8" OD Iron Pin (set) with yellow plastic cap stamped: "CLINCO & SUTTON"
  - Iron Pin previously (set)
  - Iron Pipe (fd) OD size per plan
  - Stone (fd)
  - ▲ Railroad Spike (fd)
  - ▲ Railroad Spike (set)
  - Mag Nail (set)
  - Concrete Monument (fd)
  - PK or Mag Nail (fd)
  - Post (fd) size per plan

NOTE: Bearings used are based on NAD 83 (2011) Ohio State Plane Coordinates (South Zone) as derived from GPS Observations. Distances used are based upon Grid distances. The combined scale factor is 0.999901603916. To obtain Ground distances divide the Grid distance by the combined scale factor. Monuments found or set are in good condition unless otherwise labeled. Deeds & Survey Records as noted on drawing are source data for this survey.

INDICATES LOT NO. OF JIMMIE D. & GERALDINE CREDIT SUBDIVISION BLOCK "B", PLAT BOOK 6, PAGE 239 ENVELOPE 151A

ACREAGE BREAKDOWN  
TOTAL ROAD RIGHT OF WAY = 1.000 AC.  
TOTAL ACREAGE IN LOTS = 24.992 AC.  
TOTAL ACREAGE OF SUBDIVISION 25.992 AC.

FRONT YARD SETBACK: 105 FT  
SIDE/REAR SETBACKS: 30 FT

### DRAINAGE STATEMENT

THE CLINTON COUNTY COMMISSIONERS ASSUME NO LEGAL OBLIGATION TO MAINTAIN OR REPAIR ANY OPEN DRAINAGE DITCHES OR CHANNELS DESIGNATED AS "DRAINAGE EASEMENTS" ON THIS PLAT. THE EASEMENT AREA OF EACH LOT AND ALL IMPROVEMENTS WITHIN IT SHALL BE MAINTAINED CONTINUOUSLY BY THE LOT OWNER. WITHIN THE EASEMENTS, NO STRUCTURE, PLANTING, FENCING, CULVERT, OR OTHER MATERIAL SHALL BE PLACED OR PERMITTED TO REMAIN WHICH MAY OBSTRUCT, RETARD, OR DIVERT THE FLOW THROUGH THE WATERCOURSE.