

SURVEY PLAT OF THE LANDS OF
RONALD E. & BRENDA F. JOHNSON, TRUSTEES
 OF THE RONALD E. & BRENDA F. JOHNSON REVOCABLE LIVING TRUST
 SITUATED IN VMS 2705 & 1176
 JEFFERSON & WASHINGTON TOWNSHIPS
 CLINTON COUNTY, OHIO

CLINTON COUNTY ENGINEERS
 RECORD OF LAND DIVISION

VOLUME 38 PLAT NO. 249
 DATE: 11.29.10
 SCALE: 1" = 400'

ADJOINING OWNERS

- ① MICHAEL D. POPSON
1.321 AC.
S.R. 17, PLAT NO. 38
O.R. 450, PAGE 73
- ② RUSSELL E. & LORENE H. RENNER
0.235 AC. & 1.204 AC.
S.R. 17, PLAT NO. 38
O.R. 107, PAGE 460
- ③ MARTHA B. BLOCKER
1.61 AC. ~ D.B. 236, PAGE 412
- ④ FRANK L. & GEORGIA F. THOMPSON
0.99 AC. ~ D.B. 159, PAGE 113
- ⑤ MICHAEL MOORE
2.199 AC.
S.R. 32, PLAT NO. 113
O.R. 750, PAGE 864

APPROVED
 CLINTON COUNTY ZONING DEPT.
 PER WALT DANIEL
 DATE 11/24/10
72.800 ACRES
WASHINGTON NO-ZONING
Jefferson A-3

APPROVED
 CLINTON COUNTY ZONING DEPT.
 PER WALT DANIEL
 DATE 11/24/10
102.359 ACRES
WASHINGTON NO-ZONING
Jefferson A-3



CAROL L. ABT, SUCCESSOR TRUSTEE
 181.952 AC.
 S.R. 30, PLAT NO. 17
 OFFICIAL RECORD 745, PAGE 714

WASHINGTON TOWNSHIP
 JEFFERSON TOWNSHIP

- MONUMENT LEGEND**
- Iron Pin (fd) size per plan
 - 5/8" OD Iron Pin (set) with yellow plastic cap stamped: "CLINCO & SUTTON"
 - ⊙ Iron Pipe (fd) OD size per plan
 - ⊗ Stone (fd)
 - ▲ Railroad Spike (fd)
 - △ Railroad Spike (set)
 - ⊕ Mag Nail (set)
 - ⊞ Concrete Monument (fd)
 - PK or Mag Nail (fd)
 - ⊗ Post (fd) size per plan
 - ⊕ Bolt (fd)

NOTE: Bearings used are based on NAD 83 (1995) Ohio State Plane Coordinates (South Zone) as derived from GPS Observations. Distances used are based upon Ground Distances.
 Monuments found or set are in good condition unless otherwise labeled.
 Deeds & Survey Records as noted on drawing are source data for this survey.
 NOTE: ALL IRON PINS FOUND ARE 5/8" DIAMETER UNLESS OTHERWISE INDICATED.

THE TOWNSHIP LINE WAS BASED UPON TOWNSHIP STONES FOUND USING GPS STATIC METHODS AND THE TOWNSHIP LEGAL DESCRIPTIONS AS PROVIDED BY THE CLINTON COUNTY ENGINEER'S OFFICE. THE TOWNSHIP LINE IS ONLY APPROXIMATE DUE TO LACK OF MONUMENTATION.

APPROVED FOR MATHEMATICAL ACCURACY
 Clinton County Engineer
 Per: Walt Daniel
 Date: 11.29.10

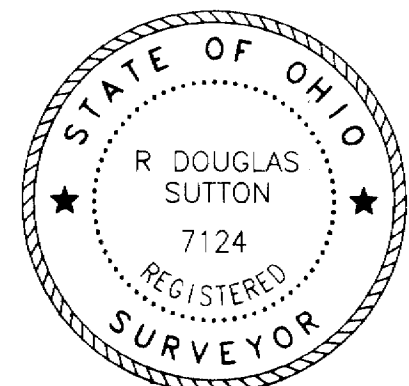

R. Douglas Sutton
 R. DOUGLAS SUTTON
 OHIO PROFESSIONAL SURVEYOR 7124

NOT SUBJECT TO HEALTH
 DEPARTMENT APPROVAL
Walt Daniel
 11-24-10

APPROVED
 Clinton Soil & Water
 Conservation District
Walt Daniel
 11/24/10

Preliminary Access Approval
 The Clinton County Engineer
 Per *Walt Daniel*
 Date 11/24/10

Clinco & Sutton
 SURVEYORS
 61 SOUTH MULBERRY ST.
 WILMINGTON, OH 45177

JOB NO. 2010/10178
 DRWG NO. SITE 7
 DATE: NOVEMBER 2010

