

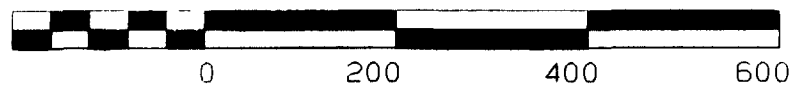

GRAPHIC SCALE 1" = 200'



BEARING REFERENCE

BEARINGS WERE BASED UPON THE 45.00 ACRE TRACT (OFFICIAL RECORD VOLUME 596, PAGE 854), AND RECORDED IN VOLUME 12, PLAT NO. 526, OF THE CLINTON COUNTY SURVEYORS RECORD (S 34°32' 00" E ON A EASTERY LINE)

LINE TABLE FOR 1.443 ACRE TRACT

- (L-1) S 34°32' 00" E 50.00'
- (L-2) S 68°50' 46" E 61.01'
- (L-3) S 45°11' 30" E 75.00'
- (L-4) S 20°18' 32" E 48.35'
- (L-5) S 05°34' 33" W 41.28'

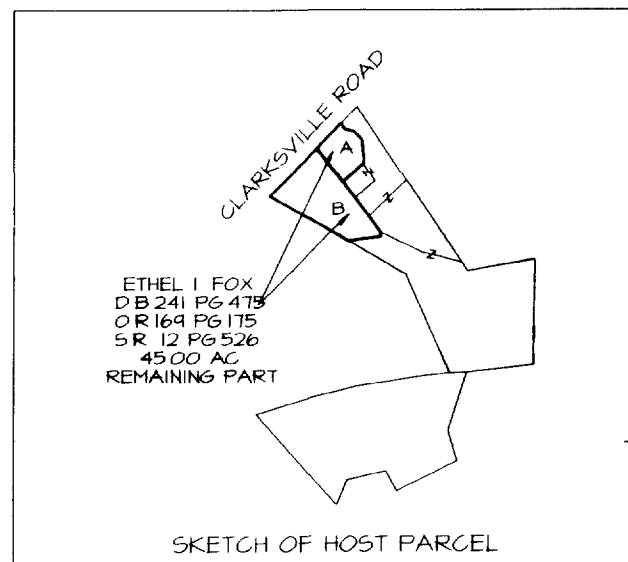
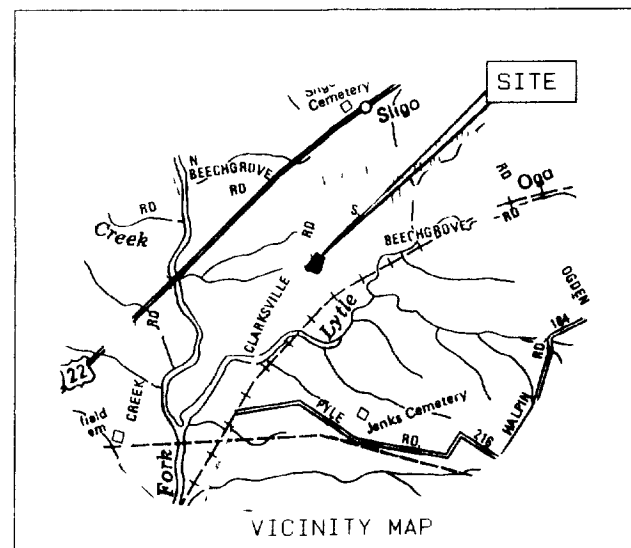

MINOR SUBDIVISION APPROVAL

Meets State Minimum Survey Requirements  
Engineers Map Office Date: 10-26-10  
Per: [Signature]

Preliminary Access Approval

By: Clinton County Engineer  
Per: [Signature]  
Date: 10/27/10

CERTIFICATE OF OWNERSHIP

I, THE UNDERSIGNED, DO HEREBY CERTIFY THAT I AM THE OWNER OF THE PROPERTY DESCRIBED HEREIN AND THAT ALL LEGALLY DUE TAXES HAVE BEEN PAID, AND THAT AS SUCH OWNER I HAVE CAUSED SAID PROPERTY TO BE SURVEYED AND SUBDIVIDED AS SHOWN

ETHEL I FOX (OWNER)

STATE OF OHIO, COUNTY OF CLINTON SS  
BE IT REMEMBERED THAT ON THIS 14th DAY OF OCTOBER, 2010, BEFORE ME, THE UNDERSIGNED, A NOTARY PUBLIC IN AND FOR THE SAID STATE, PERSONALLY CAME ETHEL I FOX, WHO ACKNOWLEDGED THE SIGNING AND EXECUTION OF THE FOREGOING PLAT TO BE HER VOLUNTARY ACT AND DEED IN THE TESTIMONY WHEREOF, I HAVE SET MY HAND AND SEAL ON THE DAY AND DATE ABOVE WRITTEN.

NOTARY PUBLIC

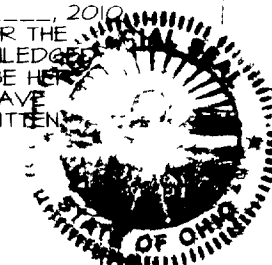

DESIREE G. MCKINNEY  
NOTARY PUBLIC - OHIO

I HEREBY CERTIFY THIS TO BE A PLAT OF A SURVEY MADE UNDER MY DIRECTION IN MAY, 2010.

[Signature]  
STEVEN D. WEBB, REGISTERED SURVEYOR NO. 7250

NOTES:

- (1) SOURCE DOCUMENTS, DEED REFERENCES & SURVEY RECORDS AS SHOWN
- (2) ALL MONUMENTS ARE IN GOOD CONDITION UNLESS OTHERWISE DENOTED

VOLUME 38 PLAT NO. 229  
CLINTON COUNTY ENGINEERS  
RECORD OF LAND DIVISION

DATE 10-26-10

SCALE 1" = 200'

VIRGINIA MILITARY SURVEY NO. 2189

TOWNSHIP ADAMS

DEED REFERENCE  
VOLUME O.R. 596 PAGE 854

DEED REFERENCE  
ETHEL I. FOX  
O.R. 596 PG. 854  
ORIG. 45.00 AC.  
S.R. 12 PG. 526  
REMAINING PART

APPROVED BY [Signature]  
DATE 10/26/10 TITLE Asst. Eng.

DATE 10/7/10 TITLE R-R

APPROVED  
Clinton Soil & Water  
Conservation District  
[Signature] 10/27/10

Approved by the Clinton County Regional  
Planning Commission; no plat required  
under the Ohio Revised Code 711.131.  
[Signature] 10/27/10

REVISED OCTOBER 5, 2010

MINOR SUBDIVISION PLAT OF  
PARTS OF **ETHEL I. FOX** LANDS  
SITUATED IN  
VIRGINIA MILITARY SURVEY NO. 2189  
ADAMS TOWNSHIP  
CLINTON COUNTY, OHIO

A. S. A. P. SURVEYS

543 GRAND AVE  
SABINA, OHIO 45169  
(937) 584-2021  
FAX (937) 584-2021

DATE	JOB NUMBER	PLAT NUMBER
MAY 13, 2010	19X10	16X10C

- LEGEND**
- SET 5/8" X 30" IRON PIN WITH PLASTIC CAP STAMPED A.S.A.P. SUR. L.S. 7250
  - SET MAG NAIL
  - ◆ FOUND NAIL
  - ◇ FOUND IRON PIN SIZE DENOTED
  - FOUND PIPE SIZE DENOTED
  - ▲ FOUND RAILROAD SPIKE
  - △ FOUND STONE
  - ⊗ FOUND BOLT
  - ⊗ FOUND POST SIZE DENOTED
  - \*-\* EXISTING FENCE ON OR NEAR PROPERTY LINE
  - NO EVIDENCE OF OCCUPATION EXISTS
  - - - APPROX. FLOW OF SURFACE WATER