

GRAPHIC SCALE 1" = 100'

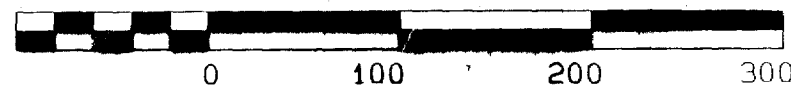

BEARING REFERENCE

BEARINGS WERE BASED UPON THE 42.62 ACRE TRACT (OFFICIAL RECORD VOLUME 680, PAGE 191), AND RECORDED IN VOLUME II, PAGE 132, OF THE CLINTON COUNTY SURVEYORS RECORD (N 28°42' 00" E ON THE CENTER OF JENKINS ROAD).

WILMINGTON AIR PARK, INC. O.R. 107 PG. 26 S.R. 23 PL. 72 ORIG. 51.67 AC. (REMAINING PART)

THOMAS R. POPP O.R. 416 PG. 854 S.R. 24 PL. 70 5.966 AC.

3.832 AC. 166,934 SQ. FT.

S.R. 26 PL. 147 4.138 AC.

JAIME L. CLUXTON O.R. 680 PG. 191 TRACT I : 42.62 AC. S.R. II PG. 132 AFTER THIS SURVEY (REMAINDER = 38.788 AC. ±)

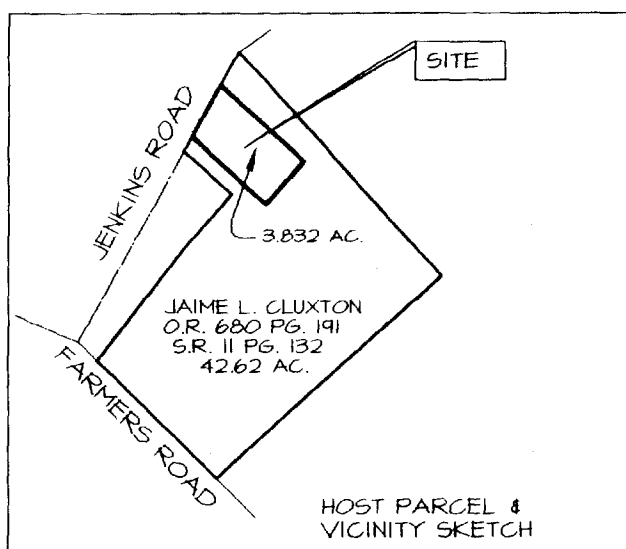

LEGEND

- SET 5/8" X 30" IRON PIN WITH PLASTIC CAP STAMPED A.S.A.P. SUR. L.S. T250.
○ SET MAG NAIL.
◇ FOUND NAIL.
◇ FOUND IRON PIN SIZE DENOTED.
□ FOUND PIPE SIZE DENOTED.
▲ FOUND RAILROAD SPIKE.
△ FOUND STONE.
⊠ FOUND BOLT.
⊗ FOUND POST SIZE DENOTED.
* * * EXISTING FENCE ON OR NEAR PROPERTY LINE.
— NO EVIDENCE OF OCCUPATION EXISTS.
- - - APPROX. FLOW OF SURFACE WATER.



I HEREBY CERTIFY THIS TO BE A PLAT OF A SURVEY MADE UNDER MY DIRECTION IN NOVEMBER, 2008.

Signature of Steven D. Webb, Registered Surveyor No. 7250.

APPROVED State Soil & Water Conservation District signature.

Approved by the Clinton County Regional Planning Commission; no plat required under the Ohio Revised Code 711.131.

Signature and Date of Planning Commission approval.

NOTES:

- (1) SOURCE DOCUMENTS, DEED REFERENCES & SURVEY RECORDS AS SHOWN.
(2) ALL MONUMENTS ARE IN GOOD CONDITION UNLESS OTHERWISE DENOTED.
(3) THE TRACT SHOWN HEREIN APPEARS TO BE LOCATED WITHIN ZONE 10' (AREAS OF MINIMAL FLOODING) ON FLOOD INSURANCE RATE MAP COMMUNITY PANEL NUMBER 390764 0004 B.
(4) ZONING REQUIREMENTS: (A) ZONING DISTRICT = A-3, (AZD-2 & AZD-3). (B) MIN. LOT SIZE = 2,000 ACRES. (C) MIN. ROAD FRONTAGE = 150.00 FEET. (D) MIN. SIDE YARD = 30.00 FEET. (E) MIN. REAR YARD = 30.00 FEET.
(5) OVERHEAD ELECTRIC LINES ARE LOCATED NEAR THE WESTERLY RIGHT-OF-WAY LINE OF JENKINS ROAD AND A UNDERGROUND TELEPHONE LINE IS LOCATED NEAR THE EASTERLY RIGHT-OF-WAY LINE OF JENKINS ROAD.

MINOR SUBDIVISION APPROVAL Meets State Minimum Survey Requirements Engineers Map Office Date: Per: Drainage and Driveway Approval Clinton County Engineer Date: Per:

DEED REFERENCE

JAIME L. CLUXTON O.R. 680 PG. 191 S.R. II PG. 132 42.62 AC.

CERTIFICATE OF OWNERSHIP:

I, THE UNDERSIGNED, DO HEREBY CERTIFY THAT I AM THE OWNER OF THE PROPERTY DESCRIBED HEREIN AND THAT ALL LEGALLY DUE TAXES HAVE BEEN PAID, AND THAT AS SUCH OWNER I HAVE CAUSED SAID PROPERTY TO BE SURVEYED AND SUBDIVIDED AS SHOWN.

JAIME L. CLUXTON (OWNER)

STATE OF OHIO, COUNTY OF CLINTON SS BE IT REMEMBERED THAT ON THIS DAY OF 2008, BEFORE ME THE UNDERSIGNED, A NOTARY PUBLIC IN AND FOR THE SAID STATE, PERSONALLY CAME JAIME L. CLUXTON, WHO ACKNOWLEDGED THE SIGNING AND EXECUTION OF THE FOREGOING PLAT TO BE HER VOLUNTARY ACT AND DEED IN THE TESTIMONY WHEREOF, I HAVE SET MY HAND AND SEAL ON THE DAY AND DATE ABOVE WRITTEN.

NOTARY PUBLIC

CLINTON COUNTY HEALTH DEPARTMENT APPROVED BY DATE 12-1-08 TITLE

APPROV CLINTON COUNTY ENGINEERS

PER DATE ZONED

SURVEY PLAT OF PART OF JAIME L. CLUXTON LANDS SITUATED IN VIRGINIA MILITARY SURVEY NO. 2386 LOWER UNION TOWNSHIP CLINTON COUNTY, OHIO

A. S. A. P. SURVEYS

543 GRAND AVE. SABINA, OHIO 45169 (937) 584-2027 FAX (937) 584-2021

Table with columns: OWNERS, DATE, JOB NUMBER, PLAT NUMBER. Owners: JAIME L. CLUXTON, 789 FARMERS ROAD, WILMINGTON, OHIO 45177. Date: NOVEMBER 20, 2008. Job Number: 58X28. Plat Number: 41X28C.