

JACK R. WADDLE
 86.12 ACRES
 OR 226 P 368
 CLINTON COUNTY

W. BORUM ROAD (T-165)(40' R/W)
 (MARION W. & HELEN JUNE WADDLE)
 108.24 ACRES
 CLINTON COUNTY

CLINTON COUNTY
 FAYETTE COUNTY

U.S. ROUTE 22 (R/W VARIES)

KOGLER FARM INVESTMENT CO.
 OR 55 P 258
 OR 55 P 251
 603.974 ACRES

BEARING BASED ON A GPS OBSERVATION ON 06/14/07
 WGS 1984 GEODETIC NORTH

DEED REFERENCE

FAYETTE COUNTY
 WADDLE FAMILY TRUST
 (MARION W. & HELEN JUNE WADDLE)
 OFFICIAL RECORD 35 PAGE 587
 (A) 100 ACRES
 92 ACRES IN FAYETTE CO.
 CLINTON COUNTY
 WADDLE FAMILY TRUST
 (MARION W. & HELEN JUNE WADDLE)
 OFFICIAL RECORD 286 PAGE 630
 (B) 100 ACRES
 8 ACRES IN CLINTON CO.

100.0585± ACRES

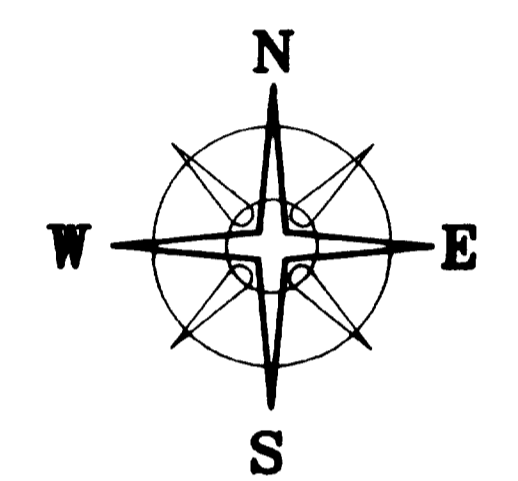

LEGEND

- ☆ COUNTY STONE (FOUND)
- ⬢ 5/8" # REBAR & RED PLASTIC CAP STAMPED "McCARTY ASSOCIATES" (FOUND)
- 1/2" IRON PIN (FOUND)
- △ CONCRETE R/W MONUMENT (FOUND)
- RAIL ROAD SPIKE (FOUND)
- MAG NAIL (SET)
- ⊙ MAG NAIL (FOUND)
- ⬡ 5/8" # REBAR & YELLOW PLASTIC CAP STAMPED "COTTRILL L.L.C. 6858" (SET)

ALL MONUMENTS FOUND OR SET ARE IN GOOD CONDITION UNLESS OTHERWISE NOTED.

FRIEDA ELAINE ELLIS
 DB 165 P 163
 103 ACRES

MICHAEL A. PIERSON
 OR 196 P 362
 188.97 ACRES
 CLINTON COUNTY

JAY WADDLE
 O R 623 P 532
 2.00 ACRES
 CLINTON COUNTY

APPROVED FOR MATHEMATICAL ASURACY
 CLINTON COUNTY ENGINEERS
 JAMES R. COTTRILL
 P.S. #6858
 DATE: 6/22/07
 (Retraiment)

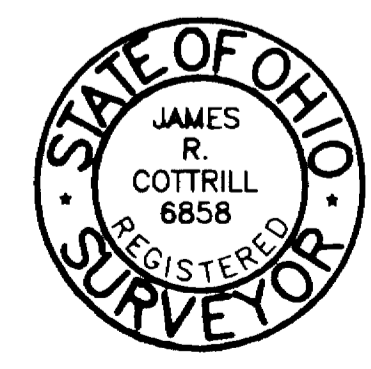

I HEREBY CERTIFY THAT THIS PLAT DEPICTS AN ACTUAL FIELD SURVEY PERFORMED BY JAMES R. COTTRILL P.S. #6858
 DATE: 6/22/07

COTTRILL SURVEYING, L.L.C.
 8256 S.R. 207 N.E. MT. STERLING, OHIO 43143 PH. (740) 869-3811

100.0585± ACRES, VMS 907,
 CONCORD TWP. OF FAYETTE CO.,
 RICHLAND TWP. OF CLINTON CO.,
 STATE OF OHIO.
 SURVEYED FOR MARVIN WADDLE.

DATE DRAWN: 6/20/07	SCALE: 1"=200'	CREW: MW
JOB # S070605	200' 100' 0 200'	DWN. BY: MW, RC
F. B. # 40		CK. BY: