

**CLINTON COUNTY ENGINEERS  
RECORD OF LAND SURVEY  
VOLUME 36 PLAT 219**

1-30-07

**DEED REFERENCE**  
VOLUME \_\_\_\_\_ PAGE \_\_\_\_\_

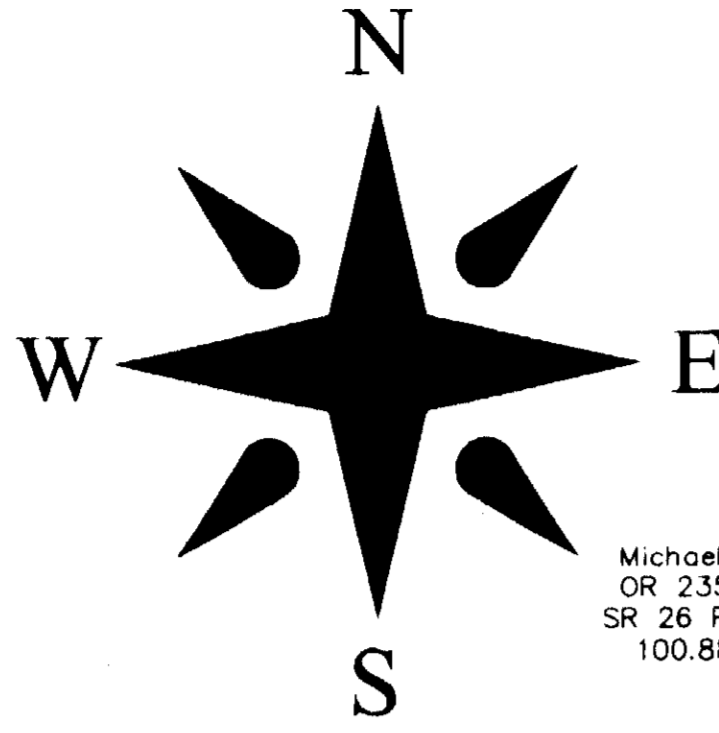

PK Nail Found North Westerly Corner  
in the center line of Hornbeam Road,  
SR 26 Plat No. 223

Michael R. Walvoord  
OR 235 Page 648  
SR 26 Plat No. 223  
100.887 Acres

Michael R. Walvoord  
OR 235 Page 648  
SR 26 Plat No. 223  
100.887 Acres

**0.5137 Acres by Survey**  
Richard Carroll & Vickie Marjorie Bennett  
DB 242 Page 321  
0.50 Acres by Deed

James A. Ellis  
OR 406 Page 863  
221.96 Acres

Curtis L. & Virginia Jones & Philip M. Jones  
OR 529 Page 558  
59.5 Acres

**DENOTES**

- Iron Pin Found
- ⊕ PK Nail Found
- $\frac{5}{8}$ " Iron Pin Set



- NOTES:**
- (1) North based upon the center line of Hornbeam Road, bearing North 42 deg 30' 00" West, Survey Record Volume 26 Plat No. 223.
  - (2) Monumentation found in good condition unless noted.
  - (3) Found Iron Pins are  $\frac{1}{2}$ " rebar with caps "Clinco".
  - (4) Set Iron Pins are  $\frac{1}{2}$ " Rebar with caps marked R. M. Roberts S-5803.
  - (5) Evidence of occupation exist as shown.
  - (6) Deeds & Survey Records as noted on drawing are source data for this survey.

POB PK Nail Found at the south westerly corner of Military Survey No. 766, and the south easterly corner of Military Survey No. 763, and being in the center line of Hornbeam Road.

APPROVED FOR MATHEMATICAL ACURACY  
Clinton County Engineer  
Per: Raymond M. Roberts  
Date: 1-30-07

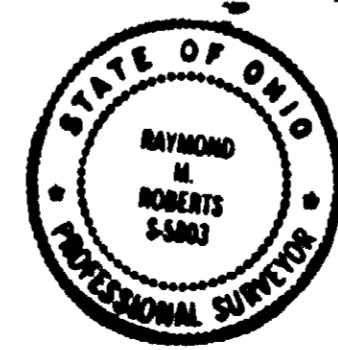

Raymond M. Roberts 1-25-07  
Raymond M. Roberts S-5803 Date

**Advanced Surveying LLC**  
4625 U.S. 68 North  
Wilmington, Ohio 45177  
Phone 937-383-2677 Fax 937-383-2350

Survey of the lands of <b>Richard Carroll &amp; Vickie Marjorie Bennett</b> Military Survey No. 766 Richland Township Clinton County, Ohio	
<b>DRAWN</b> RMR	<b>DATE</b> 1-25-07
<b>SCALE</b> 1"=20'	<b>JOB NO.</b> 07-1124