

SURVEY PLAT OF PART OF THE LANDS OF  
**FRANKLIN H. ROUDEBUSH**  
 SITUATED IN VMS 1731  
 LIBERTY TOWNSHIP, CLINTON COUNTY  
 OHIO

CLINTON COUNTY ENGINEERS  
 RECORD OF LAND DIVISION  
 VOLUME 36 PLAT NO. 17  
 DATE: 4-20-06  
 SCALE: 1" = 60'  
 DEED REFERENCE  
 VOLUME D.B. 283 PAGE 229  
 TOWNSHIP D.B. 217 LIBERTY PAGE 185  
 MILITARY SURVEY NO. 1731



FRANKLIN H. ROUDEBUSH  
 REM. PT. 102.22 AC.  
 -0.191 AC.  
 DEED BOOK 217, PAGE 184

NOTE: THE 0.341 ACRE TRACT SHALL BE CONVEYED TO TERRY L. & LAURA J. ROUDEBUSH (ADJOINING LAND OWNERS) AND SHALL NOT CREATE AN INDEPENDENT BUILDING SITE AND IS EXEMPT FROM APPROVAL AS PER OHIO REISED CODE 711.01.

SCALE 1" = 60'

- MONUMENT LEGEND -
- Iron Pin (fd) size per plan
  - 5/8" OD Iron Pin (set) with yellow plastic cap stamped: "CLINCO & SUTTON"
  - ⊙ Iron Pipe (fd) OD size per plan
  - ⊗ Stone (fd)
  - ▲ Railroad Spike (fd)
  - △ Railroad Spike (set)
  - ⊕ Mag Nail (set)
  - ⊞ Concrete Monument (fd)
  - ⊙ PK or Mag Nail (fd)
  - ⊗ Post (fd) size per plan
  - ⊕ Bolt (fd)

NOTE: Bearings used are based on NAD 83 (1995) Ohio State Plane Coordinates (South Zone) as derived from GPS Observations. Distances used are based upon Ground Distances. Monuments found or set are in good condition unless otherwise labeled. Deeds & Survey Records as noted on drawing are source data for this survey.

TERRY L. & LAURA J. ROUDEBUSH  
 5.809 AC.  
 S.R. 33, PLAT NO. 245  
 O.R. 527, PG. 700

PREVIOUSLY SURVEYED  
 S.R. 33, PLAT NO. 245

DONALD & VIRGINIA M. PETTRY  
 9.62 AC.  
 D.B. 212, PAGE 657

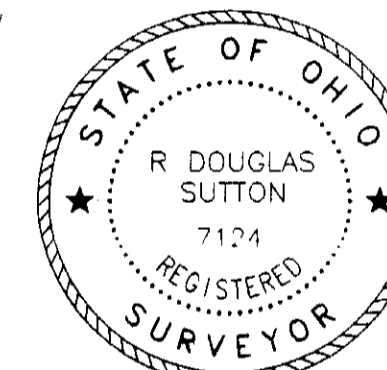

*R. Douglas Sutton*  
 R. DOUGLAS SUTTON  
 OHIO PROFESSIONAL SURVEYOR 7124

FRANKLIN H. ROUDEBUSH  
 REM. PT. 2.64 AC.  
 -0.150 AC.  
 DEED BOOK 283, PAGE 229

M.L. MARIS ETAL  
 5.484 AC.  
 O.R. 606, PG. 495

R. E. RICHARDSON ETAL  
 6.048 AC.  
 O.R. 529, PG. 566

GUTHRIE HARDWICK  
 6.023 AC.  
 O.R. 543, PG. 536

APPROVED FOR  
 MATHEMATICAL ACCURACY  
 CLINTON COUNTY ENGINEER

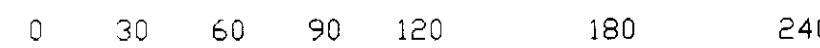

GRAPHIC SCALE IN FEET

**Clinco & Sutton**  
 SURVEYORS

61 SOUTH MULBERRY ST.  
 WILMINGTON, OH 45177

JOB NO. 2006/06806

DRWG NO. ROUDESPLIT

DATE: APRIL 2006