

SURVEY PLAT OF THE LANDS OF  
**WILLIAM J. & RICHARD STEINKOLK**  
 SITUATED IN VMS 1170  
 UNION TOWNSHIP  
 CLINTON COUNTY, OHIO

CLINTON COUNTY ENGINEERS  
 RECORD OF LAND DIVISION

VOLUME 36 PLAT NO. 129  
 DATE: 8-29-06  
 SCALE: 1" = 200'

DEED REFERENCE  
 VOLUME SEE BELOW PAGE         
 TOWNSHIP UNION  
 MILITARY SURVEY NO. 1170

DEED REFERENCES  
 DEED BOOK 249, PAGE 622  
 OFFICIAL RECORD 73, PAGE 685

**STATE OF OHIO TAKES  
 FOR PROPOSED STATE ROUTE 73**

- ① 0.432 ACRES OFFICIAL RECORD 668, PAGE 162
- ② 0.314 ACRES OFFICIAL RECORD 668, PAGE 162
- ③ 0.994 ACRES OFFICIAL RECORD 665, PAGE 25
- ④ 1.534 ACRES OFFICIAL RECORD       , PAGE
- ⑤ 0.556 ACRES OFFICIAL RECORD       , PAGE

NOTE: The 5.654 acre tract is intended to be conveyed to Michael J. & Janet M. Sepala (Adjoining land Owners) and shall not create an independent building site.

**MONUMENT LEGEND**

- Iron Pin (fd) size per plan
- 5/8" OD Iron Pin (set) with yellow plastic cap stamped: "CLINCO & SUTTON"
- ⊙ Iron Pipe (fd) OD size per plan
- ⊠ Stone (fd)
- ▲ Railroad Spike (fd)
- △ Railroad Spike (set)
- ⊕ Mag Nail (set)
- ⊞ Concrete Monument (fd)
- ⊙ PK or Mag Nail (fd)
- ⊗ Post (fd) size per plan
- ⊕ Bolt (fd)

NOTE: Bearings used are based on NAD 83 (1995) Ohio State Plane Coordinates (South Zone) as derived from GPS Observations using Clinton County Mon. CW-4. Distances used are based upon Ground Distances.

Monuments found or set are in good condition unless otherwise labeled.  
 Deeds & Survey Records as noted on drawing are source data for this survey.

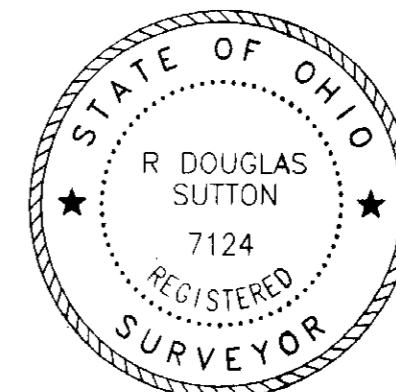
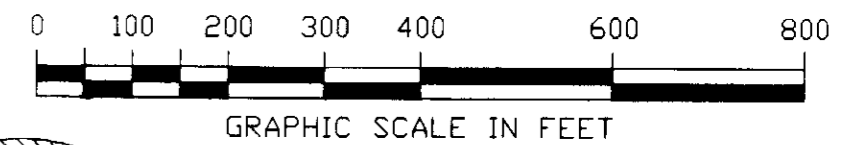

*R. Douglas Sutton*  
 R. DOUGLAS SUTTON  
 OHIO PROFESSIONAL SURVEYOR 7124

RONALD E. & JACQUELINE KERSEY  
 49.21 ACRES  
 DEED BOOK 262, PAGE 513

**Clinco & Sutton**  
 SURVEYORS

61 SOUTH MULBERRY ST.  
 WILMINGTON, OH 45177  
 (937) 382-2107

JOB NO. 2006/06821

DRWG NO. 06821

DATE:       

TRACT 2  
**20.804 AC.**

TRACT 1  
**5.654 AC.**

RODNEY RUTLEDGE  
 REM. PT. 2.74 AC.  
 O.R. 192, PG. 558

TRACT 3  
**85.702 AC.**

TRACT 4  
**44.205 AC.**

U.S. 22~3

PROPOSED STATE ROUTE 73

MICHAEL R. BIGELOW  
 REM. PART 46.235 AC.  
 S.R. 34, PLAT NO. 115  
 OFFICIAL RECORD 564, PAGE 337

ELKS 797 GOLF CLUB INC.  
 REM. PT. 66.401 AC.  
 DEED BOOK 280, PAGE 673

MICHAEL J. & JANET M. SEPALA  
 REM. PART 15.872 AC.  
 S.R. 33, PLAT NO. 79  
 OFFICIAL RECORD 482, PAGE 473

WALMART STORES EAST INC.  
 24.692 AC.  
 S.R. 32, PAGE 89  
 OFFICIAL RECORD 408, PAGE 876

STATE OF OHIO  
 OHIO DEPT. OF TRANSPORTATION  
 82.035 ACRES  
 OFFICIAL RECORD 668, PAGE 162

APPROVED FOR MATHEMATICAL ACCURACY  
 Clinton County Engineer  
 Date: 7/27/06

ANDY A. & MARTHA L. HOLMES  
 9.000 AC.  
 S.R. 34, PLAT NO. 115  
 OFFICIAL RECORD 564, PAGE 36

POB TRACTS 1-4  
 SURVEY PER ODOT PLAN CL. 73-12-03  
 SURVEY RECORD 36, PLAT NO. 87

CHANNEL EASEMENT  
 O.R. 668, PAGE 179

CHANNEL EASEMENT  
 O.R. 668, PAGE 179

16.877 ACRES  
 (ORIG. 55.872 AC.)  
 100.901 AC.

