

RECORD OF LAND DIVISION

VOLUME 34 PLAT NO. 289
 DATE 1-31-05
 SCALE _____

DEED REFERENCE

O.R. _____ PAGE _____
 TOWNSHIP _____
 MILITARY SURVEY NO. _____

CERTIFICATE OF OWNERSHIP
 I, GARY L. BROWN, PRESIDENT OF BFK FARM CORPORATION, INC., DO HEREBY CERTIFY THAT I AM THE OWNER OF THE PROPERTY DESCRIBED AND SHOWN HEREON, AND THAT ALL LEGALLY DUE TAXES HAVE BEEN PAID, AND THAT AS SUCH OWNER, I HAVE CAUSED THE SAID PROPERTY TO BE SURVEYED AND SUBDIVIDED AS SHOWN.

Gary L. Brown
 GARY L. BROWN

STATE OF OHIO, SS
 BE IT REMEMBERED THAT ON THIS 27 DAY OF January, 2005, BEFORE ME THE UNDERSIGNED, A NOTARY PUBLIC IN AND FOR SAID STATE, PERSONALLY CAME GARY L. BROWN, WHO ACKNOWLEDGED THE SIGNING AND EXECUTION OF THE FOREGOING PLAT TO BE HIS VOLUNTARY ACT AND DEED, IN TESTIMONY WHEREOF, I HAVE SET MY HAND AND SEAL ON THE DAY AND DATE ABOVE WRITTEN.

Anna Mae Rosenow

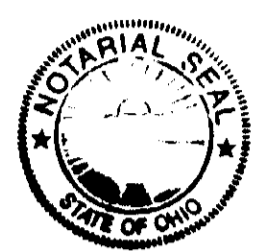

ANNA MAE ROSENOW
 Notary Public, State of Ohio
 My Commission Expires 01/24/09
 Recorded in Clinton County

BFK FARM CORPORATION, INC.
 O.R. 339, PG. 771
 TRACT III
 69.401 ACRES

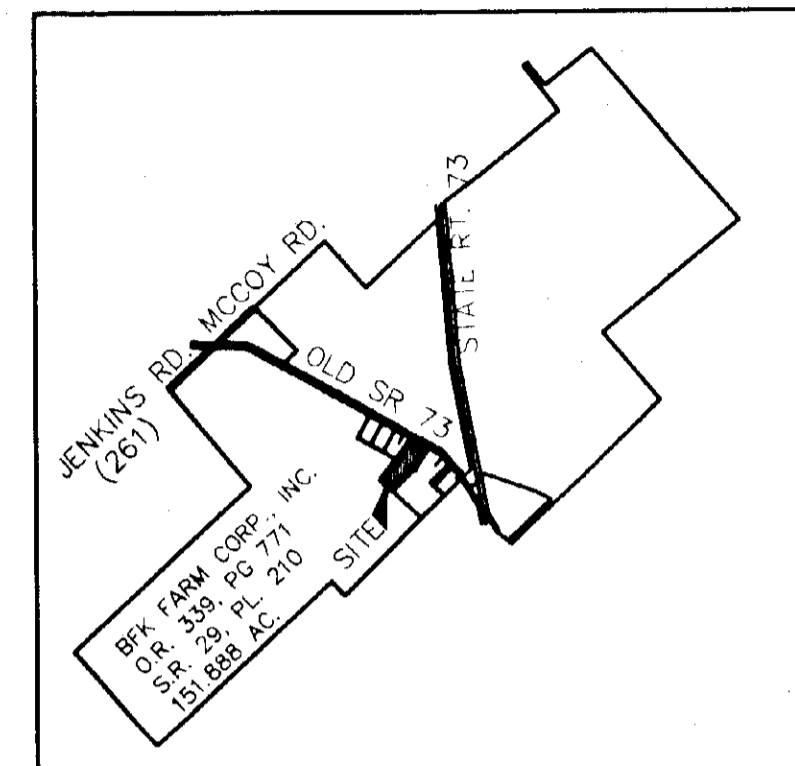

VICINITY MAP AND PROPERTY SKETCH

APPROVED
 Clinton Soil & Water Conservation District
[Signature] 1-27-05

MINOR SUBDIVISION APPROVAL
 Meets State Minimum Survey Requirements
 Engineer's Map Office Date: 1-28-05
 Drainage and Driveway Approval
 Clinton County Engineer Date: 1-28-05
 Per: [Signature]

APPROVED
 CLINTON COUNTY ZONING DEPT.
 PER [Signature]
 DATE 1-27-05 ZONED A-1

CLINTON COUNTY HEALTH DEPARTMENT
 APPROVED BY [Signature]
 DATE 1-27-05 TITLE [Signature]

Approved by the Clinton County Regional Planning Commission.
 No Plat Required.
 Signed [Signature] Date 1-27-05

CERTIFICATION:
 I HEREBY CERTIFY THIS TO BE A CORRECT PLAT OF A SURVEY MADE UNDER MY DIRECTION IN JANUARY, 2005, AND THAT ALL MONUMENTS ARE SET AS SHOWN.

- LEGEND:**
- IRON PIN FOUND "AS NOTED"
 - P/K NAIL FOUND
 - ⊙ IRON PIN SET "M-E COMP. S-6552"
 - ~ DIRECTION OF SURFACE DRAINAGE
 - ➔ DIRECTION OF CHANEL DRAINAGE

BEARINGS SHOWN HEREON ARE BASED ON CLINTON COUNTY ENGINEERS RECORD OF LAND DIVISION VOLUME 29, PAGE 210 AND VOLUME 29, PAGE 211.

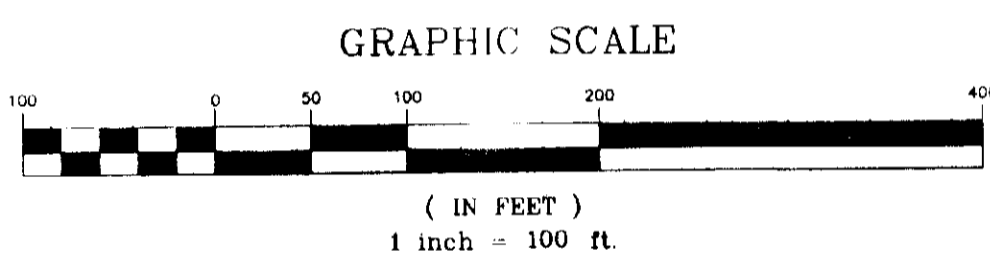

- NOTES:**
1. THE SITE SHOWN HEREON IS ZONED A-1 (AGRICULTURE DISTRICT)
 2. THERE IS AN EXISTING OVERHEAD ELECTRIC LINE LOCATED ALONG THE SOUTHERLY RIGHT-OF-WAY LINE OF OLD S.R.

RECEIVED BY THE WILMINGTON CITY PLANNING COMMISSION ON _____, 2005.

APPROVED ON _____, 2005.

CHAIRMAN _____
 SECRETARY _____

BFK FARM CORPORATION, INC.
 O.R. 339, PG. 771
 TRACT II
 151.888 ACRES

151.888 ACRES (ORIGINAL)
 -2.569 ACRES (SPLIT)
 149.319 ACRES (REMAINDER)

PRINT DATE:	FIELD	PM	DRAW
	JD	BA	BA
SHEET NO.: 1/1	JOB NO.:	05-032	
	DATE:	01/12/05	
SCALE: HORIZONTAL: 1" = 100'			

MINOR SUBDIVISION

2.569 ACRE TRACT
 LOCATED IN VMS 2386 (UPPER)
 UNION TOWNSHIP, CLINTON COUNTY, OHIO



Robert S. Wynd
 REGISTERED SURVEYOR

23 Triangle Park Drive, Suite 2300
 Cincinnati, Ohio 45246
 Contact: Brett Adcock
 513-942-3141 ext. 43
 Fax: 881-2263

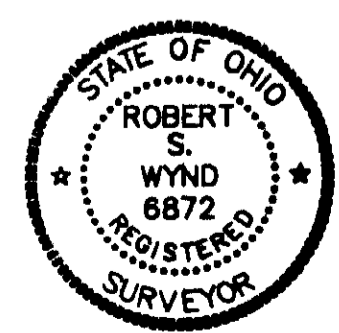

6872 NO. 01/26/05 DATE

REVISIONS		
DATE	BY	DESCRIPTION