

VOLUME 34 PLAT NO. 109
 CLINTON COUNTY ENGINEER'S 5-03-04
 RECORD OF LAND SURVEYS
 DATE APRIL 14, 2004
 SCALE 1"=60'
 DEED REFERENCE
 OFFICIAL RECORD PAGE
 TOWNSHIP UNION
 MILITARY SURVEY NUMBER
 CITY OF WILMINGTON

CLINTON COUNTY
 COMMUNITY
 ACTION PROGRAM
 O.R. 404, PAGE 818
 EXHIBIT B
 0.335 Ac.
 S.R. 30, PLAT 170

DONALD J. RAUCH
 ET UX
 D.B. 284, PAGE 662
 TRACT VI
 6.81 Ac.

CROSS CREEK SUBDIVISION
 PHASE 1, SECTION 1
 PLAT BOOK 8, PAGE 101-B

1.317 Ac. TRACT
 S.R. 17, PLAT 2
5.017 Ac.
 1.254 Ac. TRACT
 S.R. 16, PLAT 9
 2.338 Ac. IN PLATTED LOTS
 2.679 Ac. IN CORPORATION LAND

CLINTON METROPOLITAN
 HOUSING AUTHORITY
 D.B. 271, PAGE 273
 PARCEL ONE
 ORIG. 2.828 Ac.
 (NET 0.363 Ac.)

CONCRETE
 PAD

EASEMENT RESERVED FOR
 FUTURE EXTENSION OF
 THORNE AVENUE AS SHOWN
 ON S.R. 34, PAGE 55

2.828 Ac. TRACT
 (2.465 Ac.)
 S.R. 16, PLAT 9

$\Delta = 10'46'19''$
 Rod=229.50
 Len=43.15
 Tan=21.64
 Ch=S 14'28'46" E
 43.08

S.R. 34, PLAT 55

MARILYN J. CLARK
 O.R. 163, PAGE 649
 PART OF LOT No. 20

N 02'15'50" E
 15.76'

5/8" IRON PIN
 (FOUND) 1.43'

WILMINGTON FRIENDS
 HOUSING, INC.
 O.R. 042, PAGE 828
 0.843 Ac.

BEARINGS ARE BASED UPON THE RECORD BEARING
 (N 86°09'30" E) OF THE NORTHERLY LINE OF THE
 0.843 ACRES TRACT AS FOUND IN
 O.R. 042, PAGE 828.

ALFRED JOHNSON'S ADDITION
 # 34
 PLAT BOOK 3, PAGE 15A

FRIENDS HANDICAPPED
 HOUSING, INC.
 O.R. 001, PAGE 421
 1.000 Ac.

SCHOFIELD SUBDIVISION
 # 59
 PLAT BOOK 2, PAGE 22

DEED REFERENCE:
 CLINTON METROPOLITAN
 HOUSING AUTHORITY
 D.B. 271, PAGE 273
 PARCEL ONE
 ORIG. 2.828 Ac.
 PARCEL TWO
 1.254 Ac.
 D.B. 279, PAGE 058
 1.317 Ac.

HOWARD STREET (50')

THORNE AVENUE (49.5')

VALLEY STREET (50')

VINE STREET (50')

SUMMIT STREET (50')

LEGEND

- ⊙ 1/2" IRON PIN (FOUND)
- 1/2" IRON PIPE (FOUND)
- 5/8" IRON PIN (FOUND)
- 5/8" IRON PIN (SET) WITH PLASTIC CAP
 STAMPED "McCARTY ASSOCIATES"
- ⊗ DRILL HOLE (FOUND IN CONCRETE SIDEWALK)
- ⊙ MAG NAIL (SET)

APPROVED FOR
 MATHEMATICAL ACCURACY
 CLINTON COUNTY ENGINEER

Per Wheg

APPROVED BY THE CITY OF WILMINGTON, OHIO
 ON THIS _____ DAY OF _____, 2004.

MAYOR _____
 CITY CLERK _____

NOTES

THE ABOVE LISTED DEED REFERENCES WERE USED
 AS A BASIS FOR CARRYING OUT THE WORK.
 NO EVIDENCE OF OCCUPATION EXISTS ALONG
 PROPERTY LINES INDICATED BY SOLID LINES.
 ALL MONUMENTS FOUND OR SET ARE IN GOOD
 CONDITION UNLESS OTHERWISE INDICATED.

I HEREBY CERTIFY THIS TO BE A PLAT
 OF A SURVEY MADE UNDER MY DIRECTION
 IN APRIL, 2004

Eric N. Lutz
 ERIC N. LUTZ, P. S. 7232

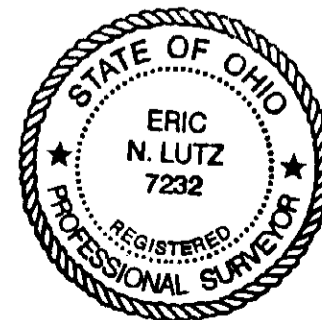

SURVEY FOR
WILMINGTON HOUSING PARTNERS, LTD

CITY OF WILMINGTON
 CLINTON COUNTY, OHIO
 V.M.S. No. 1057

McCARTY ASSOCIATES, LLC
 Engineers - Surveyors - Architects

213 N. High Street Hillsboro, Ohio 45133 (937) 393-9971
 104 S. Main Street Washington C.H., Ohio 43160 (740) 335-3816

DATE	SCALE	PROJECT NO.
APRIL 14, 2004	1"=60'	S04-161

