

CLINTON COUNTY ENGINEERS
 RECORD OF LAND DIVISION
 VOLUME 34 PLAT NO. 10
 DATE: 1-02-2004
 SCALE: 1" = 30'
 DEED REFERENCE
 VOLUME O.R. 169 PAGE 152
 TOWNSHIP CITY OF WILMINGTON
 MILITARY SURVEY NO. 2471

POB
 SOUTHEASTERLY CORNER
 OF THE FULLER ADDITION
 RECORDED IN
 PLAT BOOK 2, PAGE 111

APPROVED BY THE CITY OF WILMINGTON, OHIO ON
 THIS 30th DAY OF December, 2003

[Signature]
 MAYOR
[Signature]
 CITY CLERK



SURVEY PLAT OF PART OF THE LANDS OF
MRC ACTIVITIES LTD
 SITUATED IN
 VMS 2471
 CITY OF WILMINGTON
 CLINTON COUNTY, OHIO

1.579 ACRES

- CURVE DATA -
 R = 5669.58'
 I = 2°08'11.4"
 A = 211.41'
 T = 105.72'
 CB = S 19°57'42.9" W
 LC = 211.40'

- MONUMENT LEGEND -
 ● Iron Pin (fd) size per plan
 ○ 5/8" OD Iron Pin (set) with yellow plastic cap stamped: CLINCO & SUTTON
 ⊗ Iron Pipe (fd) OD size per plan
 ⊠ Stone (fd)
 ▲ Railroad Spike (fd)
 △ Railroad Spike (set)
 ⊕ P.K. or Mag Nail (set)
 ⊞ Concrete Monument (fd)
 ⊙ PK or Mag Nail (fd)
 ⊛ Bolt (fd) size per plan
 ⊚ Post (fd) size per plan

NOTE: Bearings used are based on an assumed azimuth and are for purposes of angular measurement only. Monuments found or set are in good condition unless otherwise labeled. Deeds & Survey Records as noted on drawing are source data for this survey.

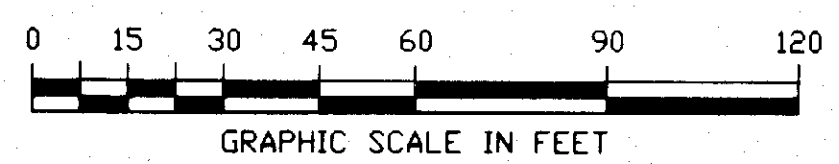

MATHEMATICAL ACCURAC.
 CLINTON COUNTY ENGINEER
 per *Margaret Watters*
 12-30-2003

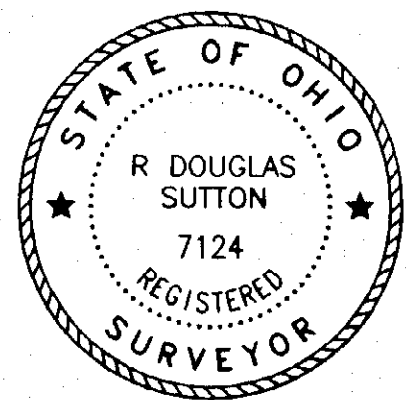

[Signature]
 R. DOUGLAS SUTTON
 OHIO PROFESSIONAL SURVEYOR NO. 7124

Clinco & Sutton
 SURVEYORS
 61 SOUTH MULBERRY ST.
 WILMINGTON, OH 45177

JOB NO. 03357
 DRWG NO. P:\2003\2003\03357
 DATE: DECEMBER, 2003

SANDRA L. DOLL
 REMAINING PART 2.098 ACRES
 OFFICIAL RECORD 372, PAGE 617

