

CLINTON COUNTY ENGINEERS RECORD OF LAND DIVISION	
VOLUME <u>33</u>	PLAT NO. <u>119</u>
DATE: <u>4-29-03</u>	
SCALE: 1" = 60'	
DEED REFERENCE	
VOLUME <u>O.R. 46</u>	PAGE <u>342</u>
TOWNSHIP <u>ADAMS</u>	
MILITARY SURVEY NO. <u>1554</u>	

SURVEY PLAT OF PART OF THE LANDS OF
JANICE ELAINE MOONEY
SITUATED IN
VMS 1554
ADAMS TOWNSHIP
CLINTON COUNTY, OHIO

N



SCALE 1" = 60'

DONALD E. & MIRIAM SPEAIGHT
40.00 ACRES
OFFICIAL RECORD 24, PAGE 828

APPROVED FOR
MATHEMATICAL ACCURACY
CLINTON COUNTY ENGINEER

[Signature]

CLINTON COUNTY RURAL WATER CO. INC.
0.581 ACRES
SURVEY RECORD 20, PLAT NO. 263
OFFICIAL RECORD 56, PAGE 851

Note: The 2.500 acre tract shall be conveyed to Robert L. Webb (adjoining owner of a 5.029 acre tract), and shall not create an independent building site.

- MONUMENT LEGEND —
- Iron Pin (fd) size per plan
 - 5/8" OD Iron Pin (set) with yellow plastic cap stamped: "CLINCO & SUTTON"
 - ⊗ Iron Pipe (fd) OD size per plan
 - ⊠ Stone (fd)
 - ▲ Railroad Spike (fd)
 - △ Railroad Spike (set)
 - ⊕ P.K. or Mag Nail (set)
 - ⊞ Concrete Monument (fd)
 - PK or Mag Nail (fd)
 - ◆ Bolt (fd) size per plan
 - ⊗ Post (fd) size per plan

NOTE: Bearings used are based on an assumed azimuth and are for purposes of angular measurement only. Monuments found or set are in good condition unless otherwise labeled. Deeds & Survey Records as noted on drawing are source data for this survey.

Clinco & Sutton
SURVEYORS
61 SOUTH MULBERRY ST.
WILMINGTON, OH 45177

JOB NO. 03304
DRWG NO. E./2003/03304
DATE: APRIL, 2003

JANICE ELAINE MOONEY
REMAINING PART 86.95 ACRES
- 2.500 ACRES
OFFICIAL RECORD 46, PAGE 342

2.500 AC.

ROBERT L. WEBB
5.029 ACRES
SURVEY RECORD 20, PLAT NO. 60
OFFICIAL RECORD 46, PAGE 339

EXIST. BLDG. TO BE REMOVED

POB SOUTHEASTERLY
CORNER OF THE 5.029
ACRE TRACT AS SURVEYED
IN S.R. 20, PL. 60

CEMETERY
BOOK K, PAGE 2

0.313 AC.

MARKK A. WISWELL ETAL
1.67 AC.
O.R. 178, PAGE 721

ROBERT L. WEBB
74.01 ACRES
OFFICIAL RECORD 46, PAGE 339

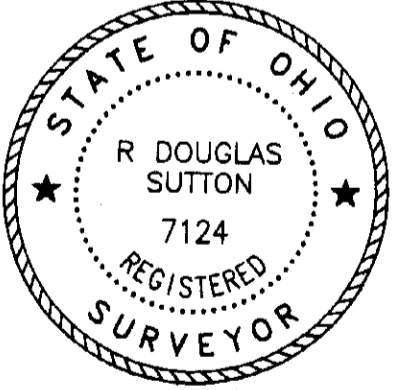

[Signature]
R. DOUGLAS SUTTON
OHIO PROFESSIONAL SURVEYOR NO. 7124

