

CLINTON COUNTY ENGINEERS  
RECORD OF LAND DIVISION

VOLUME 32 PLAT NO 189  
DATE 6-25-02  
SCALE 1" = 100'

DEED REFERENCE  
VOLUME OR 6 PAGE 736  
TOWNSHIP GREEN  
MILITARY SURVEY NO 4397

SURVEY PLAT OF PART OF THE LANDS OF  
**MARTHA GILLESPIE ETAL**  
SITUATED IN  
VMS 4397  
GREEN TOWNSHIP  
CLINTON COUNTY, OHIO

HUGH YOUNG, JR REVOCABLE TRUST ETAL  
93 00 ACRES  
OFFICIAL RECORD 342, PAGE 239

APPROVED  
CLINTON COUNTY ZONING DEPT.  
PER [Signature]  
DATE 6/24/02 ZONED A-2

NOTED  
PROPERTY CLINCO  
COMMUNITY PLANNING  
CERTIFICATE BASED ON  
[Signature] 6/24/02

NOT SUBJECT TO HEALTH  
DEPARTMENT APPROVAL  
[Signature] 6-24-02

- MONUMENT LEGEND
- Iron Pin (fd) size per plan
  - 5/8" OD Iron Pin (set) with yellow plastic cap stamped "CLINCO & SUTTON"
  - ⊙ Iron Pipe (fd) OD size per plan
  - ⊠ Stone (fd)
  - ▲ Railroad Spike (fd)
  - △ Railroad Spike (set)
  - ⊕ P K. or Mag Nail (set)
  - ⊞ Concrete Monument (fd)
  - PK or Mag Nail (fd)
  - ◆ Bolt (fd) 1/2"
  - ⊘ Post (fd) size per plan

NOTE Bearings used are based on an assumed azimuth and are for purposes of angular measurement only. Monuments found or set are in good condition unless otherwise labeled. Deeds & Survey Records as noted on drawing are source data for this survey.

MARTHA GILLESPIE ETAL  
REMAINING PART OF 105 381 ACRES  
- 8 363 ACRES  
SURVEY RECORD 18, PLAT NO 145  
OFFICIAL RECORD 6, PAGE 736

MARTHA GILLESPIE  
3 092 ACRES  
SURVEY RECORD 19 PLAT NO 208  
OFFICIAL RECORD 52 PAGE 688

EAST FORK QUAKER CEMETERY  
REMAINING PART 3 00 ACRES  
DEED BOOK A, PAGE 436

DAVID HENDERSON  
2 426 ACRES  
SURVEY RECORD 18, PLAT NO 145  
OFFICIAL RECORD 34, PAGE 9

JAY D AND JULIE J JONES  
2 000 ACRES  
SR 19, PL NO 61  
OF 239, PG 272

INCORPORATED VILLAGE OF NEW VIENNA  
43 357 ACRES  
SURVEY RECORD 17 PLAT NO 277  
OFFICIAL RECORD 15, PAGE 475

WALTER C DOLL, JR AND LUCY E DOLL  
93 452 ACRES  
SURVEY RECORD 18, PLAT NO 186  
OFFICIAL RECORD 353 PAGE 862

8.353 AC.

NORDYKE ROAD NO 140

STATE ROUTE NO. 73

VILLAGE OF NEW VIENNA CORPORATION LINE

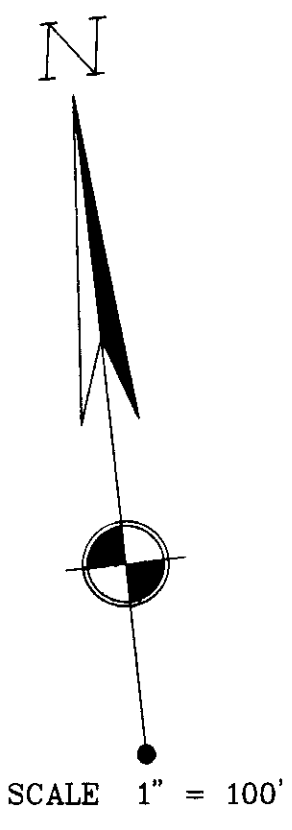

MATHEMATICAL ACCURACY  
CLINTON COUNTY ENGINEER  
[Signature]  
June 21, 2002

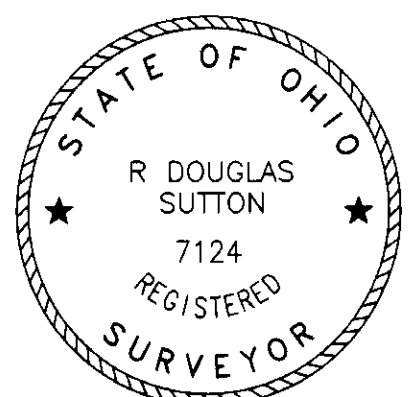
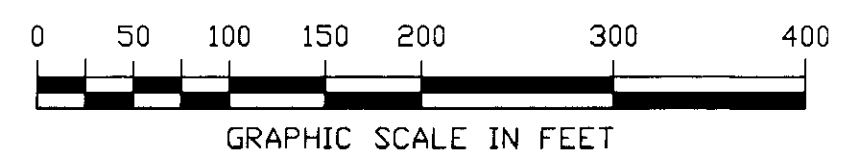

[Signature]  
R DOUGLAS SUTTON  
OHIO PROFESSIONAL SURVEY NO 7124

**Clinco & Sutton**  
SURVEYORS

61 SOUTH MULBERRY ST  
WILMINGTON, OH 45177

JOB NO E/2002/02196  
DRWG NO 02196  
DATE JUNE, 2002