

CLINTON COUNTY ENGINEERS
 RECORD OF LAND DIVISION
 VOLUME 28 PLAT NO. 6
 DATE 5-7-1997
 SCALE 1" = 300'

DEED REFERENCE
 VOLUME O.R. 55 PAGE 207
 MILITARY SURVEYS NO. 1112 & NO. 4896
 TOWNSHIP WAYNE

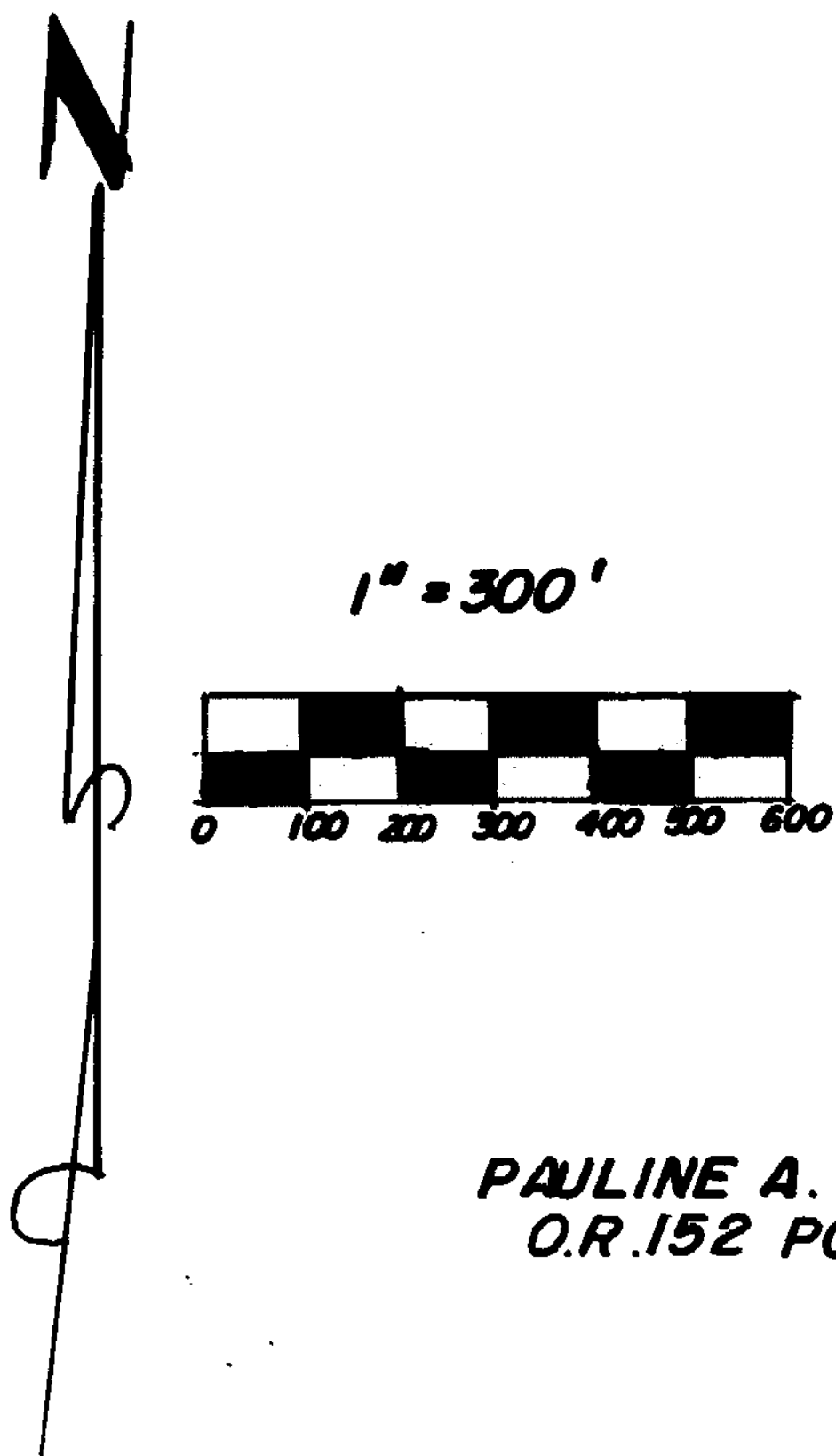

1" = 300'

PAULINE A. TERRELL
 O.R. 152 PG. 347

JAMES LEE LARRICK &
 LANA JEAN LARRICK
 O.R. 75 PG. 718

SURVEY PLAT OF
THOMAS C. TERRELL & PAMELA TERRELL LANDS
 SITUATED IN
 MILITARY SURVEYS NO. 1112 & NO. 4896
 WAYNE TOWNSHIP
 CLINTON COUNTY, OHIO

ROBERT C. TERRELL
 D.B. 180 PG. 590
 S.R. 9 PG. 524

- NOTES:**
- (1) "SET PIN" DENOTES 1/2" X 30" IRON PIN WITH PLASTIC CAP STAMPED "CLINCO"
 - (2) "SET NAIL" DENOTES P.K. MASONRY NAIL
 - (3) BEARINGS WERE DERIVED FROM THE DEED AS RECORDED IN VOLUME 55, PAGE 207, OF THE OFFICIAL RECORDS OF CLINTON COUNTY, OHIO.

155.975 ACRES

PAULINE A. TERRELL
 O.R. 152 PG. 347

JOHNSON ROAD NO. 147

TERRELL ROAD NO. 13

THOMAS C. TERRELL
 D.B. 261 PG. 65
 S.R. 9 PG. 47
 101.27 AC.

APPROVED FOR
 MATHEMATICAL ACCURACY
 Clinton County Engineer
 Per Margaret Walters
 MAY 7 1997

I HEREBY CERTIFY THIS TO BE A CORRECT PLAT OF A
 SURVEY MADE UNDER MY DIRECTION IN APRIL, 1997.



Richard D. Roll
 REGISTERED SURVEYOR NO. 4957

CLINCO SURVEYORS
 P.O. BOX 241
 58 S. WALNUT STREET
 WILMINGTON, OHIO 45177

SCALE 1" = 300' DRAWN BY MJS CHECKED BY RDR
 DATE 4-29-97 DRWG. C-8183