

SCALE: 1" = 200'

BEARINGS ARE MAGNETIC AND BASED UPON THE N 2° 55' 26" E LINE

SOURCE OF DOCUMENTS ARE DEED RECORDS AS SHOWN ON PLAT.

VOLUME 23 PLAT NO. 300
CLINTON COUNTY ENGINEERS
RECORD OF LAND DIVISION
DATE: 03-30-93
SCALE: 1" = 200'
TOWNSHIP CLARK
MILITARY SURVEY NO. 4163

FRANK WELSH
118.39 AC.
O.R. 75 P. 43
S.R. 16 P. 63

JOHN & LORRAINE BENE
22.85 AC.
O.R. 29 P. 274
S.R. 13 P. 324

JOHNNY MARTIN
120.27 AC.
O.R. 104 P. 400
S.R. 13 P. 324

EDWARD WILSON,
ETAL
2.00 AC.
O.R. 89 P. 388
S.R. 22 P. 185

TERRY McCANN
4.208 AC.
O.R. 105 P. 444 S.R. 22 P. 185
**MULLEN HILL
ROAD T-223**

5.002 AC.
JAMES & JULIE WICKLINE
3.154 AC.
O.R. 71 P. 694
S.R. 15 P. 22

F. ROBERT & DONNA K. HASTINGS
ORIG. 83.43 AC.
O.R. P.
S.R. 15 P. 22

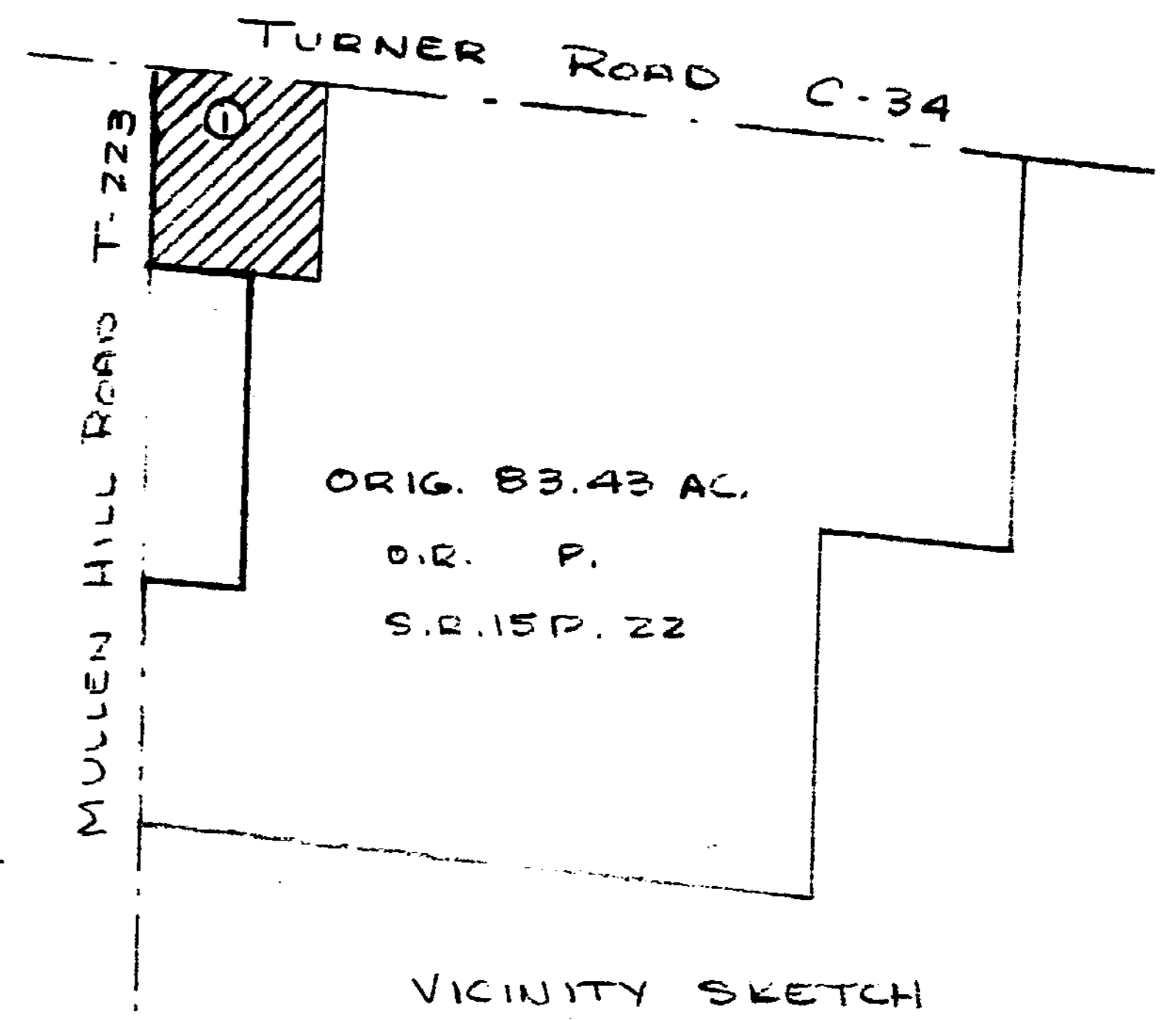

APPROVAL
CLINTON COUNTY BOARD
OF HEALTH

DATE _____ DIRECTOR _____

- LEGEND
- ⊗ SPIKE SET
 - SPIKE FOUND
 - ▽ 5/8" IRON PIN SET
 - ▼ IRON PIN FOUND
 - ⊙ IRON PIPE FOUND

SURVEY BY
SATTEFIELD & ASSOCIATES

Robert E. Satterfield
ROBERT E. SATTEFIELD
WEST UNION, OHIO
P.S. No. 4238
PHONE: 513-544-2833



APPROVED FOR
MATHEMATICAL ACCURACY
Clinton County Engineer
Per *[Signature]*
MAR 0 1993

SURVEY
FOR
**ROBERT & DONNA K.
HASTINGS**
MILITARY SURVEY No. 4163
CLARK TOWNSHIP
CLINTON COUNTY, OHIO
SCALE: 1" = 200' FEBRUARY, 1993