

CLINTON COUNTY ENGINEER'S
 RECORD OF LAND DIVISION:
 VOLUME 23 PLAT 119
 DATE: 8-27-92
 PRIOR DEED REFERENCE:
 O.R. VOL. 30, Pg. 519

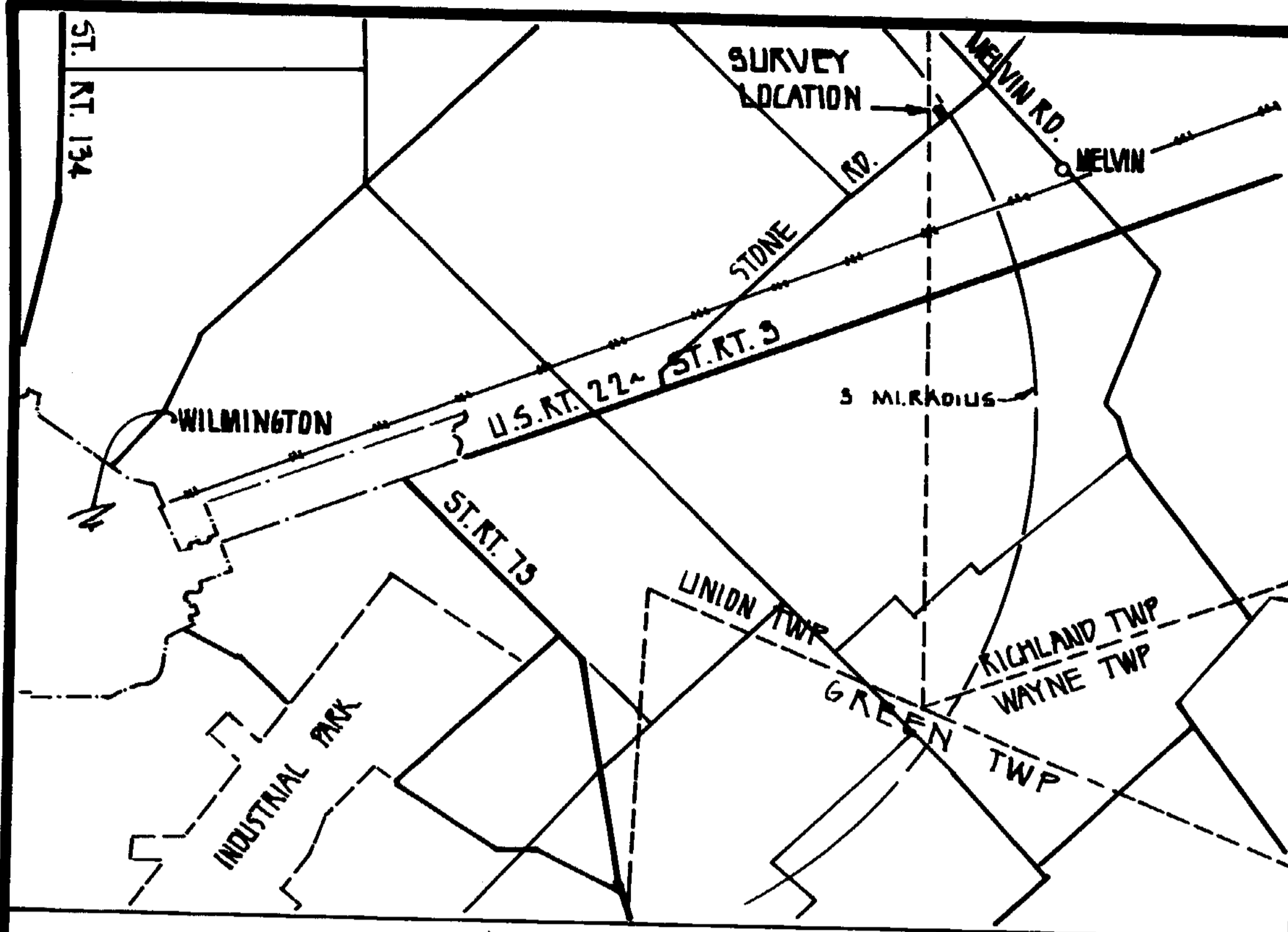

BEARINGS ARE BASED UPON THE CENTERLINE OF STONE ROAD AS DENOTED IN VOLUME 14, PLAT 378 OF THE CLINTON COUNTY ENGINEER'S RECORD OF LAND DIVISION.

SURVEY PLAT FOR
 PART OF **CONNIE WATSON, et al.** LANDS
 MILITARY SURVEY No. 885
 RICHLAND TOWNSHIP
 CLINTON COUNTY, OHIO
 FOR
 CLARK FLINT

EDWARD D. & JEAN J. KEITER
 D.D. VOL. 273, Pg. 187
 13.37 AC

CONNIE WATSON, et al
 O.R. VOL. 30, Pg. 519
 75.15 AC

LEGEND

- FOUND P.K. MASONRY NAIL
- ⊙ SET P.K. MASONRY NAIL
- SET 5/8" IRON PIN W/ PLASTIC I.D. CAP
- △ FOUND RAILROAD SPIKE
- x- WOVEN WIRE FENCE ON OR NEAR PROPERTY LINE
- NO EVIDENCE OF OCCUPATION ON PROPERTY LINE

BENNETT ROAD
No. 108

1.000 AC

2.000 AC
S.R. VOL. 14, PL. 378

STONE ROAD No. 23

MELVIN ROAD
No. 9

APPROVED FOR
 MATHEMATICAL ACCURACY
 Clinton County Engineer
 Per *Margaret Walters*
 AUG 06 1992

APPROVED
 CLINTON COUNTY ZONING DEPT
 PER *Michael Richardson*
 DATE 8-7-92 ZONED A-1

APPROVED BY *Loy White R.S.*
 DATE 8-7-92 TITLE Director E&E
 CLINTON COUNTY HEALTH DEPARTMENT

APPROVALS:

APPROVED THIS 25 DAY OF Aug., 1992
 BY THE WILMINGTON CITY PLANNING COMMISSION.

Brian F. Gallagher
 CHAIRMAN
Paul J. Martin
 SECRETARY

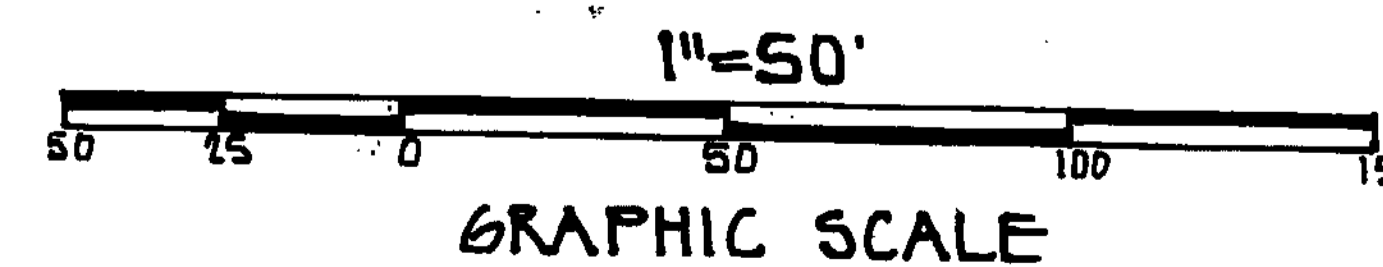

SOUTHWEST OHIO LAND SURVEYS
 P.O. BOX 201, WILMINGTON, OHIO 45177
 (513)-382-0799

SCALE: 1" = 50' DRAWN BY: BF6 DATE: AUG. 5, 1992
 DRAWING No.: 1824 170

Brian F. Gallagher
 BRIAN F. GALLAGHER, OHIO P.S. 6945