

VOLUME 20 PLAT No. 7
 CLINTON COUNTY ENGINEER'S
 RECORD OF LAND SURVEYS
 DATE: 9-07-1988
 SCALE: 1" = 30'

DEED REFERENCE:
 WILLIAM L. & SHERRY L. AREHART, RICHARD G. & SANDRA J. AREHART
 & HERBERT J. & JANET L. AREHART - D.B. 271, PG. 75 - 20.48 Ac.
 HERBERT J. AREHART, JR. & JANET L. AREHART - D.B. 284, PG. 132
 S.R. 17, PL. 245 - 1.797 Ac.
 TOWNSHIP RICHLAND-VILLAGE OF SABINA
 MILITARY SURVEY 837

NOTES

I.R. = 1/2" Iron Rod (Set) with plastic cap stamped "RLL 6106."
 OCCUPATION: Roadway & Monumentation (Fd.)
 All monumentation in good condition.
 REFERENCE BEARING: N. 39°43'40" W. The West line of
 797 Ac. Tract as per D.B. 284, PG. 132

ROSE AVENUE (50' R/W)

S & R TOOL & DIE SERVICE
 O.R. 28, PG. 337
 S.R. 19, PG. 159
 0.803 Ac.

WILLIAM L. & SHERRY L. AREHART,
 RICHARD G. & SANDRA J. AREHART &
 HERBERT J. & JANET L. AREHART
 D.B. 271, PG. 75
 20.48 Ac.

0.4462 Ac.

0.2538 Ac.

HERBERT J. AREHART, JR.
 & JANET L. AREHART
 D.B. 284, PG. 132
 S.R. 17, PL. 245
 1.797 Ac.

APPROVED FOR
 MATHEMATICAL ACCURACY
 Clinton County Engineer
 Per *[Signature]*
 SEP 7 1988

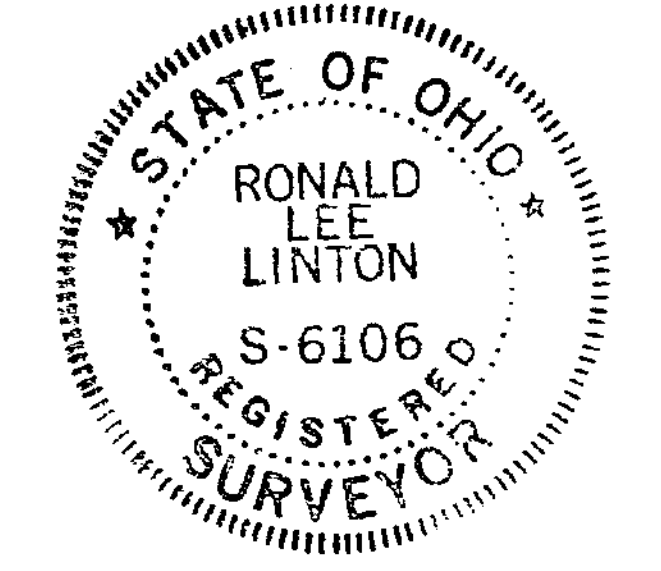

Ronald L. Linton

Ronald L. Linton, P.S. No. 6106

Gale L. Helms & Assoc., Inc.
 Consulting Engineers & Surveyors
 222 N. OAKLAND AVE.
 WASHINGTON C.H., OHIO 43160 PH. (614) 335-3816

SURVEY OF 0.4462 Ac. & 0.2538 Ac.
 V.M.S. 837
 VILLAGE OF SABINA
 RICHLAND TOWNSHIP
 CLINTON COUNTY, OHIO

DATE: AUG. 25, 1988 SCALE: 1" = 30'