

STATE ROUTE 73

VOLUME 19 PLAT NO. 7
 CLINTON COUNTY ENGINEERS
 RECORD OF LAND SURVEYS
 DATE: NOVEMBER 8, 1984 11-06-1986
 SCALE: 1" = 100'
 DEED REFERENCE
 DEED BOOK _____ PAGE _____
 TOWNSHIP CHESTER
 MILITARY SURVEY NUMBER 1994

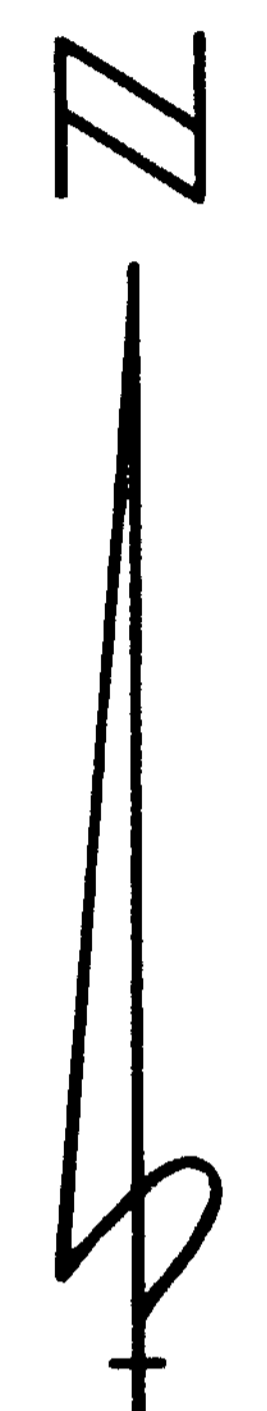

BEARINGS ARE MAGNETIC
 FEBRUARY 24, 1977

STATE ROUTE 380

MATTHIAS TOEBBEN
 VOL. 252 - PG. 527
 ORIGINAL 154 Ac.
 S.R. 14 - PG. 230
 NET 3.706 Ac.

CLIFTON L. WHITAKER, ET AL
 VOL. 283 - PG. 349
 3.50 Ac.
 S.R. 13 - PG. 149

CLIFTON L. WHITAKER
 O.R. 11 - PG. 440
 8.000 Ac.

①
1.456 Ac.

②
1.456 Ac.

③
7.039 Ac.

SAMUEL LACY ET LUX
 O.R. 12 - PG. 52B
 2.435 Ac.

LUCILLE M. PLYMIRE
 VOL. 280 - PG. 425
 141.18 Ac.
 S.R. 12 - PG. 267

ALBERT C. HAYDOCK, ET LUX
 VOL. 244 - PG. 249
 PARCEL I
 ORIGINAL 31.00 Ac.

APPROVED FOR
 MATHEMATICAL ACCURACY
 Clinton County Engineer
 Per Margaret Waters
 NOV 4 1986

DEED REFERENCE:
JAMES F. ANDERSON
 And
MARILYN ANDERSON
 O.R. 11 - PG. 446
 ORIG. 20.424 Ac.
JAMES F. ANDERSON, MARILYN ANDERSON, And CLIFTON L. WHITAKER
 VOL. 263 - PG. 665
 VOL. 283 - PG. 345
 20.424 Ac.

SURVEY FOR
JAMES ANDERSON
 CHESTER TOWNSHIP
 CLINTON COUNTY, OHIO
 K.M.S. NO. 1994

MCCARTY ENGINEERING
 CIVIL ENGINEERS & SURVEYORS
 213 N. HIGH ST. P.O. BOX 391
 HILLSBORO, OHIO 43131
 513-393-9971
 REV'D. DEC. 4, 1984; JULY 7, 1986; OCT. 27, 1988; OCT. 28, 1986

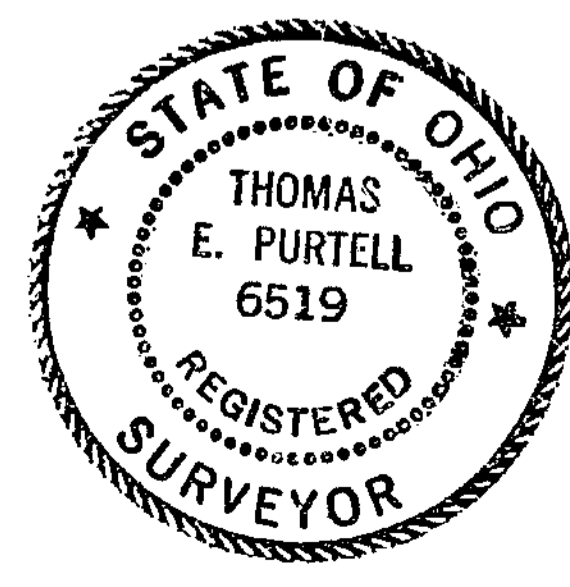

I HEREBY CERTIFY THIS TO BE A PLAT OF A SURVEY MADE UNDER MY DIRECTION IN NOVEMBER, 1984

Thomas E. Purtell
 THOMAS E. PURTELL, P.S. 6519

APPROVAL
 CLINTON COUNTY COMMISSIONERS

11/6/86 David R. Stewart
 11-6-86 Thomas C. Mc Miller

The approval of this plat by the Board of County Commissioners does not constitute the approval by the Board of Health, roads or streets, zoning and the drainage of this subdivision.

NOTES
 THE LISTED DEED REFERENCES AND SURVEYOR'S RECORD WERE USED AS A BASIS FOR CARRYING OUT THE WORK.
 NO EVIDENCE OF OCCUPATION EXISTS ALONG THE PROPERTY LINES INDICATED BY SOLID LINES.

LEGEND

- SPIKE (FOUND)
- R.R. SPIKE (SET)
- 1/2" IRON PIN (FOUND)
- 5/8" IRON PIN (SET)
- WOVEN WIRE FENCE GENERALLY ON OR NEAR LINE

