

**CLINTON COUNTY ENGINEERS
RECORD OF LAND DIVISION**

VOLUME 17 PLAT NO. 69
DATE 5-9-83
SCALE 1"=50'

DEED REFERENCE

DEED BOOK 144 PAGE 425
TOWNSHIP VERNON
MILITARY SURVEY NO. 2705

NOTES:

- (1) "SET PIN" DENOTES 1/2" x 30" IRON PIN WITH PLASTIC CAP.
- (2) "SET NAIL" DENOTES P. K. MASONRY NAIL.
- (3) BEARING REFERENCE: BEARINGS WERE DERIVED FROM THE SURVEY OF THE 16.09 ACRE TRACT AS RECORDED IN VOLUME 13, PAGE 126, OF THE CLINTON COUNTY SURVEYORS RECORD.

RECEIVED BY THE CLINTON COUNTY COMMISSIONERS ON
May 12 1983

Henry J. Land
CLEAR

APPROVED ON 5-12 1983

D.M. F. David E. Bailey

COMMISSIONERS OF CLINTON COUNTY, OHIO

The approval of this plat by the Board of County Commissioners does not constitute the approval by the Board of Health, roads or streets; zoning and the drainage of this subdivision.

SURVEY PLAT OF

PARTS OF EMMA L. RUMPKE LANDS

SITUATED IN

MILITARY SURVEY No. 2705
VERNON TOWNSHIP
CLINTON COUNTY, OHIO

APPROVED FOR
MATHEMATICAL ACCURACY
Clinton County Engineer
per Melinda Wilkerson
MAY 12 1983

CLINCO

ENGINEERS - SURVEYORS
P.O. Box 241

62 1/2 E. SUGARTREE ST. WILMINGTON, OHIO

SCALE 1"=50' DRAWN BY CLY CHECKED BY RDR

DATE May 9, 1983 DRWG. **C-4425**

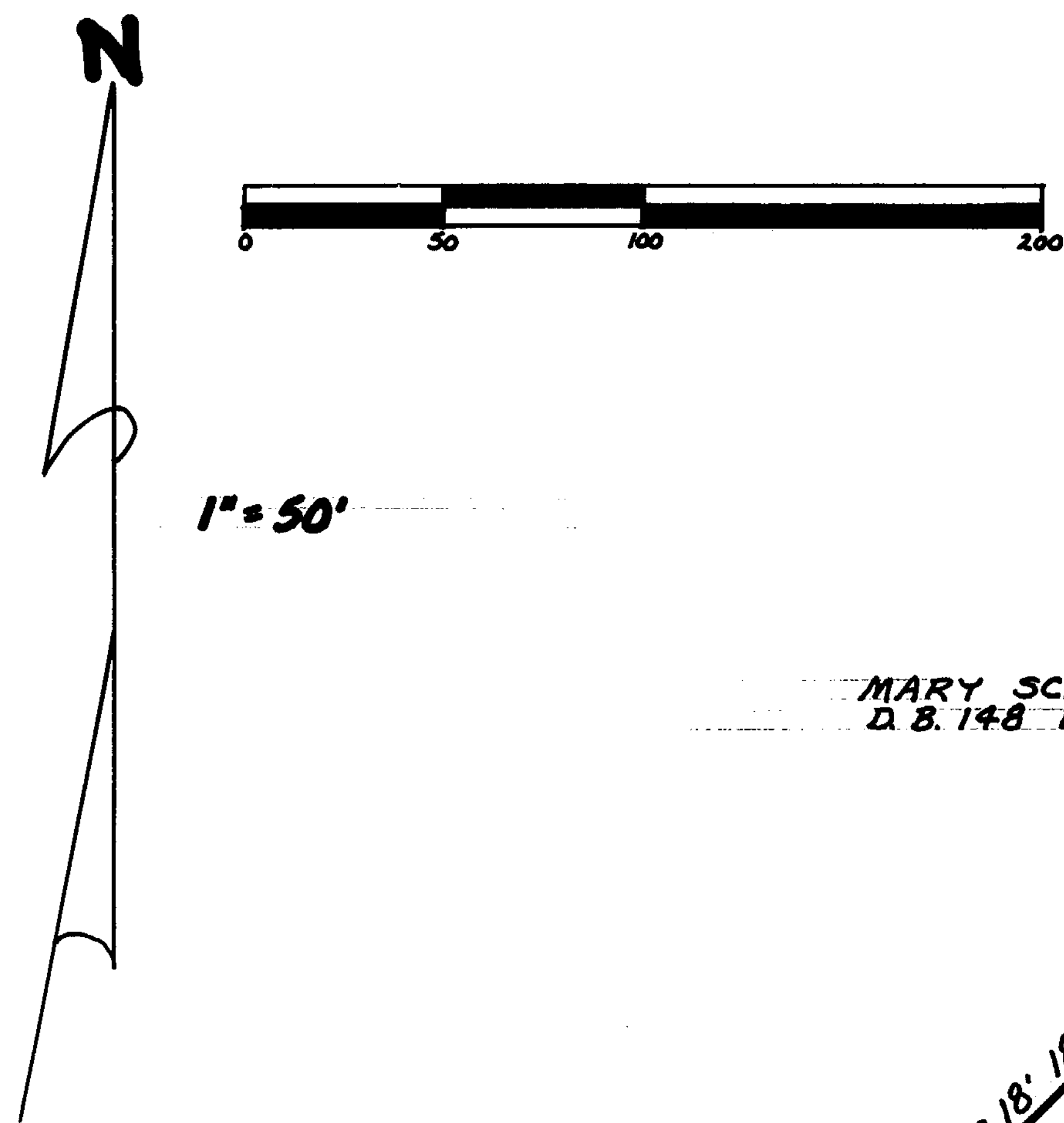

MARY SCHMIDT
D. B. 148 Pg. 316

1.671 ACRES

EVA FLEMING
D. B. 242 Pg. 667
S. R. 13 Pg. 126
16.09 Ac.

1.000 ACRE

EMMA L. RUMPKE
D. B. 144 Pg. 425

PRATT ROAD No. 256

BEGINNING POINT

ROBERT O. &
JULIA ANN CURRY
D. B. 271 Pg. 360
S. R. 12 Pg. 442

I HEREBY CERTIFY THIS TO BE A CORRECT PLAT OF A SURVEY MADE UNDER MY DIRECTION IN MAY, 1983.

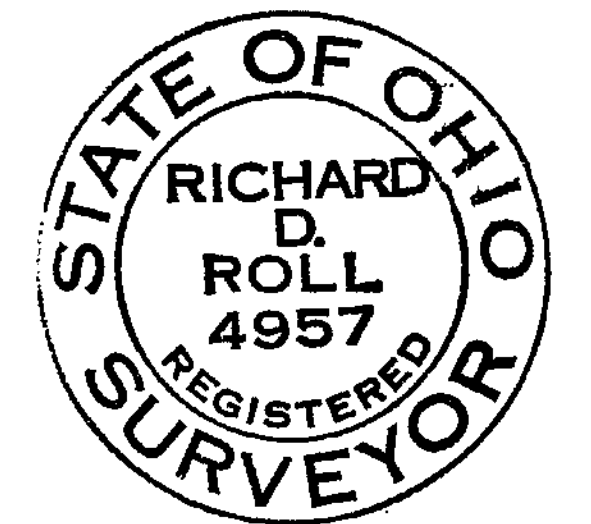

Richard D. Roll
REGISTERED SURVEYOR No. 4957