

# PLAT OF PARCELS I & II FOR METROPOLITAN HOUSING AREA

CITY OF WILMINGTON, CLINTON CO., OHIO

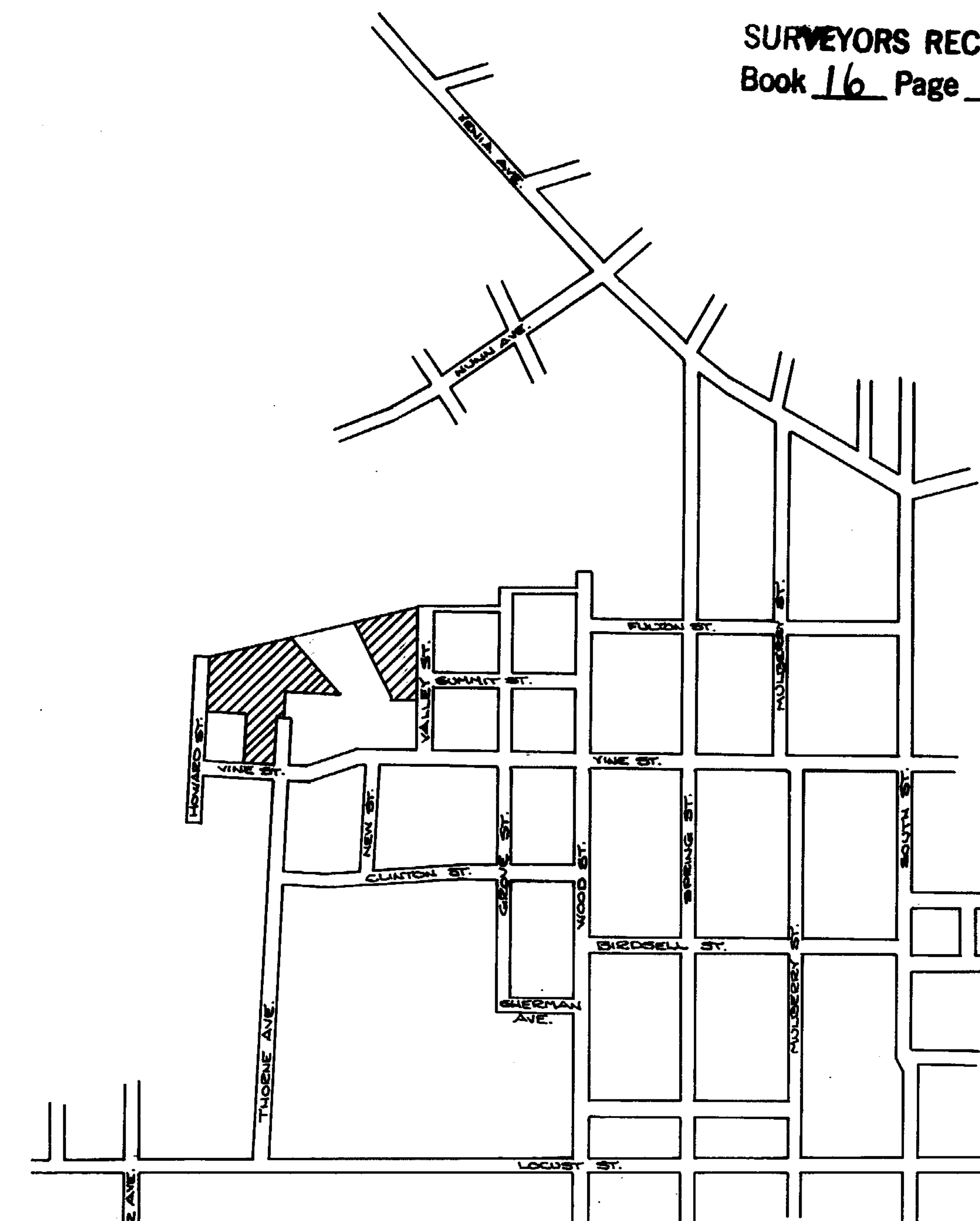

VICINITY MAP  
SCALE: 1"=600'

RECEIVED BY THE WILMINGTON CITY PLANNING COMMISSION  
ON SEPT. 25, 1980

*Bonnie MacDonald*  
SECRETARY

APPROVED BY THE WILMINGTON CITY PLANNING COMMISSION  
ON SEPT. 25, 1980

*Robert W. Meyer*  
CHAIRMAN

*Bonnie MacDonald*  
SECRETARY

**CERTIFICATION:**

I CERTIFY THAT THIS MAP IS A TRUE AND COMPLETE  
SURVEY MADE UNDER MY DIRECTION IN MAY 1980.

*Raymond V. Kline*  
RAYMOND V. KLINE KLINE ENGINEERING, YENIA, O.  
REG. SURVEYOR OHIO #3877

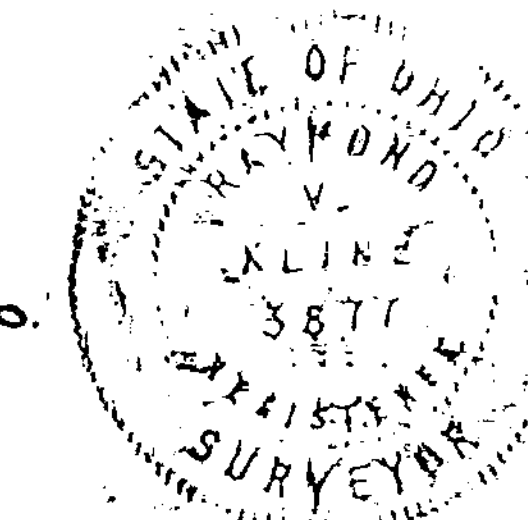

APPROVED FOR ACCURACY  
Clinton County Engineer  
Per *M. Waters*  
SEP 24 1980

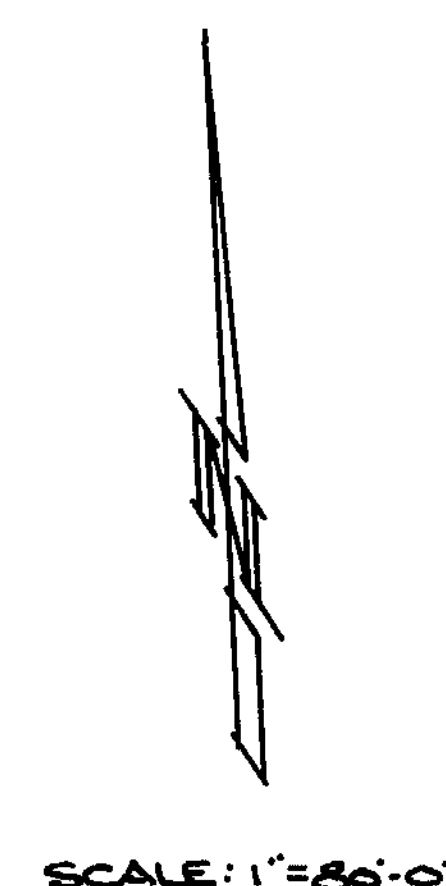

SCALE: 1"=86'-0"

