

DEED REFERENCE
DEED BOOK 235 PAGE 224
TOWNSHIP UNION
MILITARY SURVEY NO. 961 &
NO. 986/2433

I HEREBY CERTIFY THIS TO BE A CORRECT PLAT OF A SURVEY
MADE UNDER MY DIRECTION IN JULY, 1978.

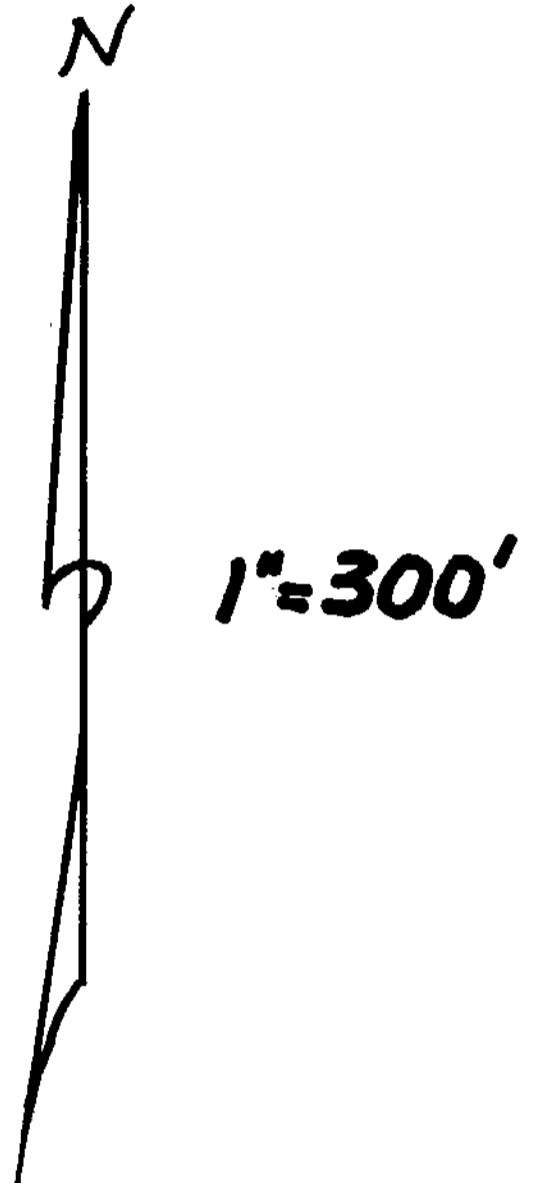

Richard D. Roll
REGISTERED SURVEYOR NO. 4957



WE, THE UNDERSIGNED, JAMES F. BENNETT, VERA F. BENNETT, ROBERT E. BENNETT, AND JOANNE BENNETT, HEREBY CERTIFY THAT WE ARE THE OWNERS OF THE REAL ESTATE SHOWN HEREIN AND THAT SUCH SUBDIVISION OF SAID REAL ESTATE IS FOR THE PURPOSE OF IMMEDIATE OR FUTURE TRANSFER OF OWNERSHIP.

STATE OF OHIO
COUNTY OF CLINTON SS:
ON THIS DAY OF 1978, BEFORE ME A NOTARY PUBLIC IN AND FOR SAID COUNTY AND STATE, PERSONALLY APPEARED JAMES F. BENNETT, VERA F. BENNETT, ROBERT E. BENNETT, AND JOANNE BENNETT OWNERS OF THE LAND SHOWN HEREIN AND ACKNOWLEDGED THE SIGNING OF THIS PLAT TO BE THEIR FREE AND VOLUNTARY ACT AND DEED. WITNESS MY HAND AND OFFICIAL SEAL ON THE DAY AND DATE ABOVE WRITTEN.

EDWARD D. &
JEAN J. KEITER

JAMES F. & VERA F. BENNETT
ROBERT E. & JOANNE BENNETT
D.B. 250 PG. 662

JAMES & VERA BENNETT
ROBERT & JOANNE BENNETT
D.B. 240 PG. 187

NOTARY PUBLIC
MY COMMISSION EXPIRES _____

RECEIVED BY THE CLINTON COUNTY COMMISSIONERS
ON 8-4 1978

Helen J. Rasmussen
CLERK

APPROVED ON 8-4 1978

David E. Bailey D M F

The approval of this plat by the Board of County Commissioners does not constitute the approval by the Board of Health, roads or streets, zoning and the drainage of this subdivision.

COMMISSIONERS OF CLINTON COUNTY, OHIO

SURVEY PLAT OF
PARTS OF JAMES F. BENNETT, ET AL LANDS
SITUATED IN
MILITARY SURVEYS NO. 961 & NO. 986/2433
UNION TOWNSHIP
CLINTON COUNTY, OHIO

APPROVED FOR ACCURACY
Clinton County Engineer
Per E. LEWIS 8-1-78

CLINCO
ENGINEERS & SURVEYORS
P.O. Box 241
62 1/2 E. SUGARTREE ST. WILMINGTON, OHIO

SCALE 1" = 300'	DRAWN BY JG	CHECKED BY RDR
DATE JULY 25, 1978	DRAWN C-3764	

