

VOLUME 14 PLAT NO. 2
 CLINTON COUNTY ENGINEERS
 RECORD OF TOWN LOTS
 DATE 11-21-75
 SCALE 1" = 30'
 DEED REFERENCE
 DEED BOOK _____ PAGE _____
 CORPORATION BLANCHESTER
 ADDITION W.H. BALDWIN'S ADD.
 LOT NO. _____
 M.S. 3342

HELEN HOSEMAN PLAT
 TRACT NO. 1

GEORGE E. MYERS
 VOL. 186 P. 664

GEORGE E. MYERS
 VOL. 186 P. 664

0.415 AC.

WRIGHT STREET

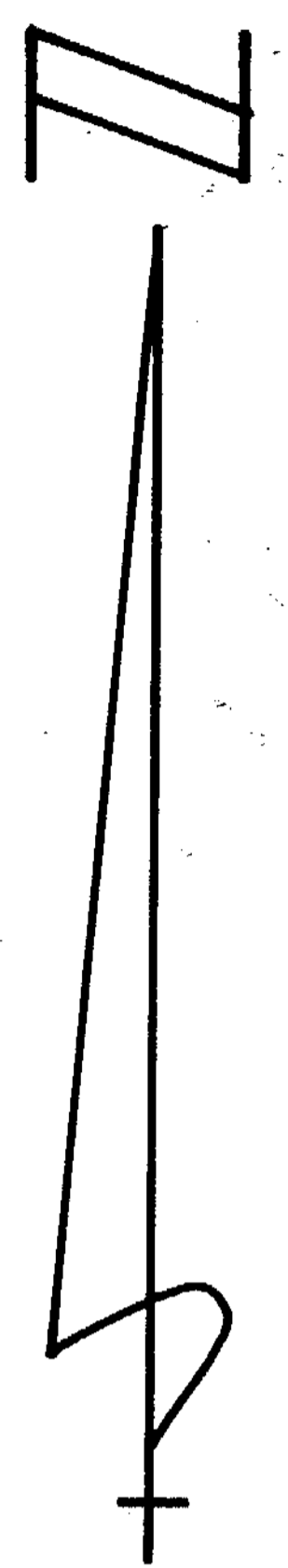

LEGEND
 • IRON PIN SET

I HEREBY CERTIFY THIS TO BE A
 CORRECT PLAT OF A SURVEY MADE
 BY ME IN NOVEMBER, 1975.

R. Lowell McCarty
 REG. SURVEYOR NO. 5008

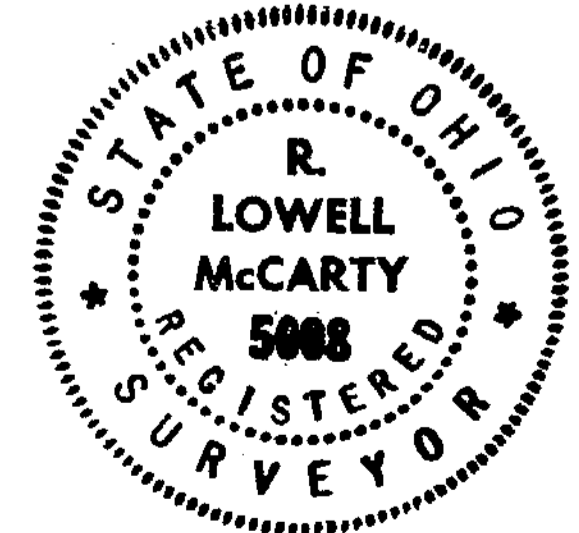

APPROVED FOR TRANSFER
 Clinton County Engineer
 Per *L. Smith* 11-28-75

APPROVAL

BLANCHESTER PLANNING COMMISSION

DATE _____ DIRECTOR *Donald E. Pittman, Sec*

SURVEY FOR
 THOMAS ALLEN
 523 S. WRIGHT ST.
 BLANCHESTER, OHIO

McCARTY ENGINEERING
 110 1/2 EAST MAIN ST.
 HILLSBORO, OHIO 45133

DATE	SCALE	DRAWING NO.
NOV. 21, 1975	1" = 30'	75-286