

COLUMBUS ST.

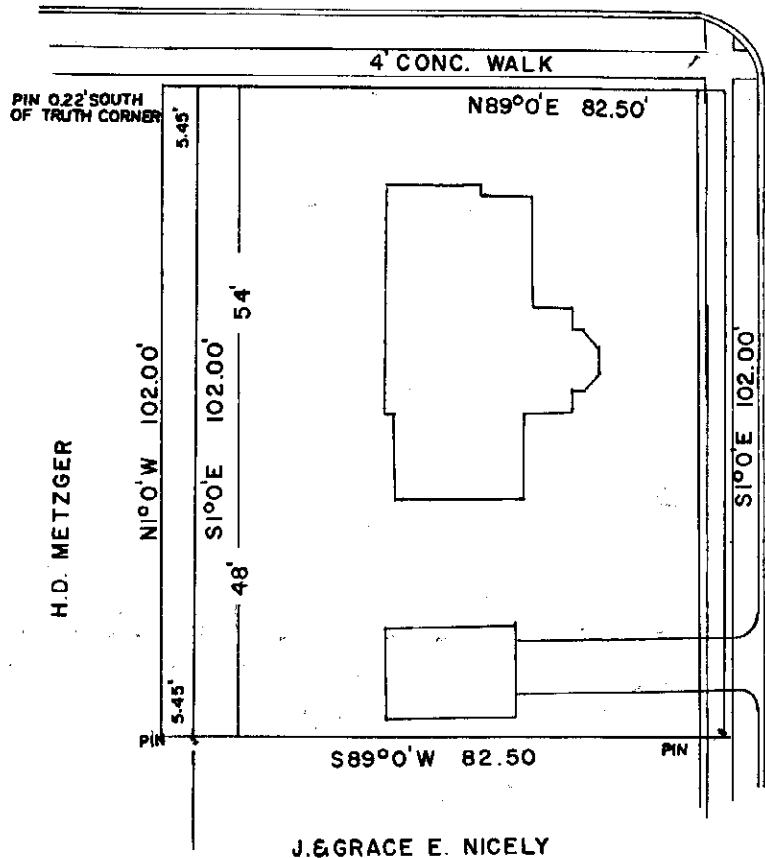

CECIL C. & ONAD SHAW
 M.S. NO. 1057 EXTENSION
 CITY OF WILMINGTON
 CLINTON COUNTY, OHIO

I hereby certify the above to be a correct plat of a survey made by me on November 18, 1968
Maynard Borton
 Registered Surveyor No. 3966

1" = 30'

WEST MAIN STREET

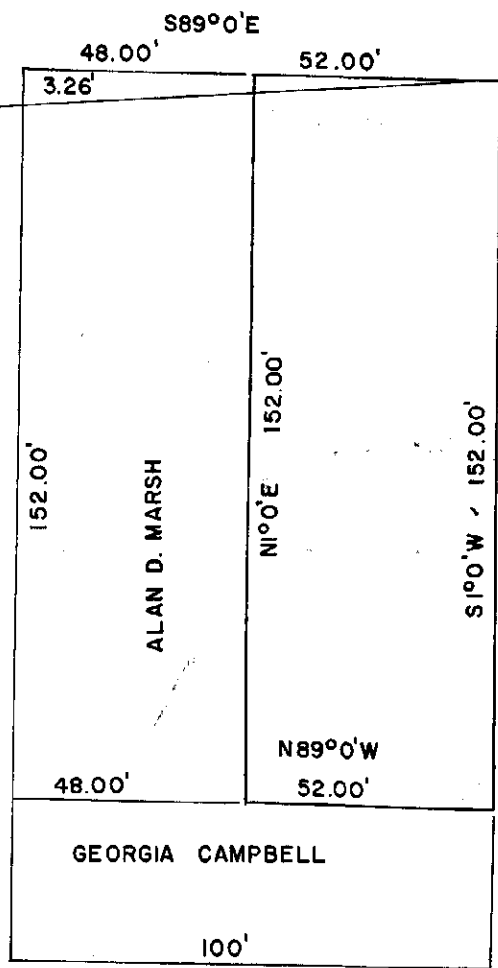

JOSEPH W. JR. & H. H. LIST
 EXTENSION WILMINGTON
 CLINTON COUNTY, OHIO

1" = 40'

I hereby certify the above to be a correct plat of a survey made by me on October 7, 1968
Maynard Borton
 Registered Surveyor No. 3966