

ELSIE MERCER  
 LOTS #130-131-105 & 106  
 E. R. MILLS GRANDVIEW ADDITION  
 MILITARY SURVEY # 1057  
 UNION TOWNSHIP & CITY OF WILMINGTON  
 CLINTON COUNTY, OHIO  
 1" = 40'

I hereby certify the above to be a correct plat of a survey made by me on November 24, 1959.

*Maynard Butts*  
 Registered Surveyor No. 3966

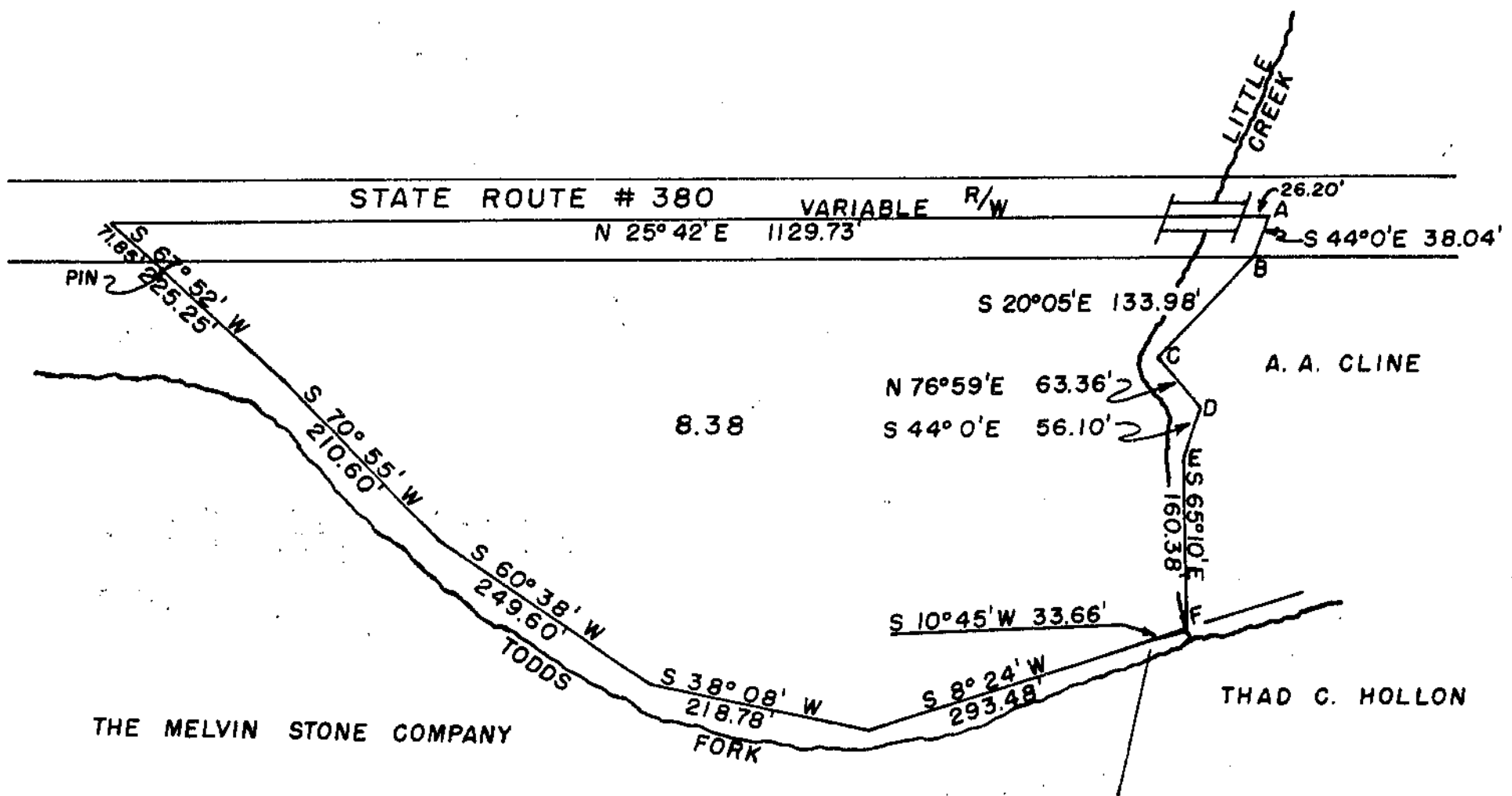

THE MELVIN STONE COMPANY  
 A. A. CLINE  
 MILITARY SURVEY # 2372  
 ADAMS TOWNSHIP  
 CLINTON COUNTY, OHIO  
 1" = 160'

I hereby certify the above to be a correct plat of a survey made by me on November 11, 1959.

*Maynard Butts*  
 Registered Surveyor No. 3966