

STATE HIGHWAY # 28

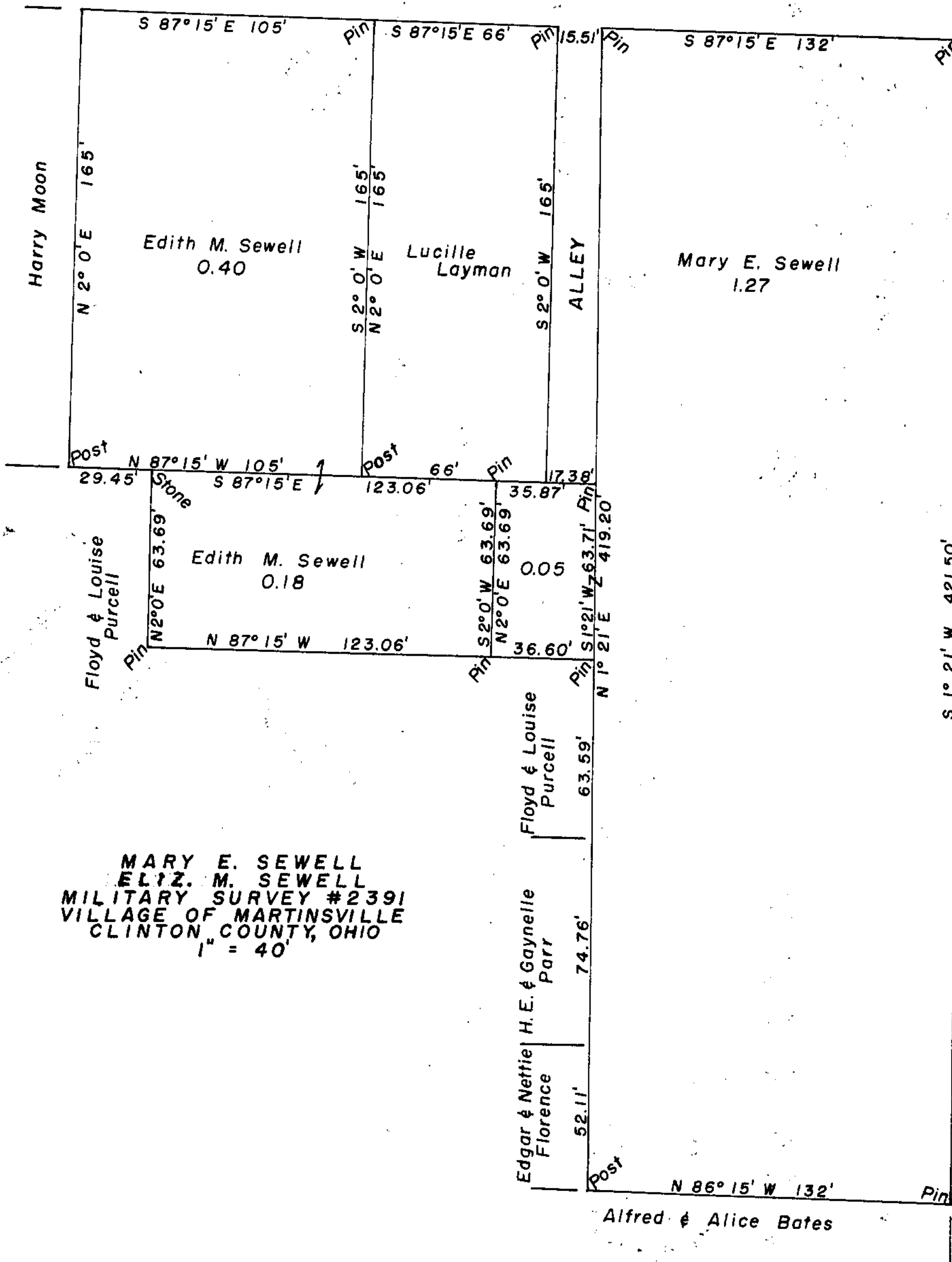

MARY E. SEWELL  
 ELIZ. M. SEWELL  
 MILITARY SURVEY #2391  
 VILLAGE OF MARTINSVILLE  
 CLINTON COUNTY, OHIO  
 1" = 40'

I hereby certify the above to be a correct plat of a survey made by me, completed October 4, 1956.

*Maynard Boston*

Registered Surveyor No. 3966