

NOTE: ADD 1000' TO ELEVATIONS SHOWN FOR SEA LEVEL DATUM

Note: This survey was made for mortgage purposes only and should not be used for any other purpose.

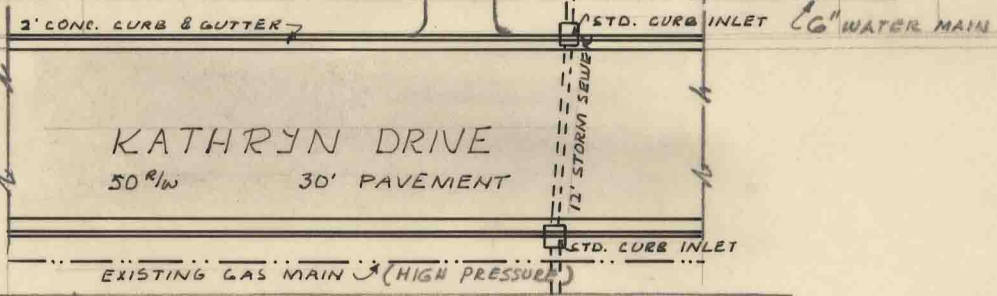

CERTIFICATION

I certify that the within plat correctly shows the results of a field survey.
 I also certify that this survey, shows the improvements or improvement as located on the premises described, that the buildings are entirely within the property lines; and that there are no encroachments upon the premises described by improvements of adjoining premises.

[Signature]
 Reg. Civil Engr. & Surveyor

FEB. 13 1966
 Date

**PLAT OF SURVEY
 LOT NO. 262
 IN THE PLAT OF
 DENVER PLACE
 SUBDIVISION, SECTION BLOCK I
 LOCATED AT 948 KATHRYN DR.
 WILMINGTON
 CLINTON COUNTY, OHIO
 Scale 1" = 30'**