



GPS STATION LOG

Station Name: 6010
 Receiver No.: 2948
 Day of Year: 112
 Session No.: G
 Project Name: Chimney Ln
 Job Number: 57526
 Local Date: 4/21/00
 Operator: G.T.F

C/A CODE POSITION

Lat: 39° 40' 06" N
 Long: 083° 48' 42" W
 Ellip. Height: 40282 M

Trimble: 4000 SSB, 4000 SSI, Other _____
 Antenna: Kinematic, Compact, Groundplane, Dome
 Battery No.: Ant 33812 Rect 3313A02948
 Tribrach No.: F-H-TP (1.5m Rod)
 File Name: 2948-112-G

Antenna H.I. => Before: 1.563 M _____ Ft
 After: 1.563 M _____ Ft
Rapid-Static, Static, Kinematic Survey

Actual => Start 22:25 Stop 23:31 UTC
 Start 18:25 Stop 19:31 Local
 Local-UTC Time Offset: 4HR

SV's Used: 26, 06, 10, 13, 17, 24

Weather: D=44.4° W=42.7° RH=88% RP=28.66
01121

Sketch:

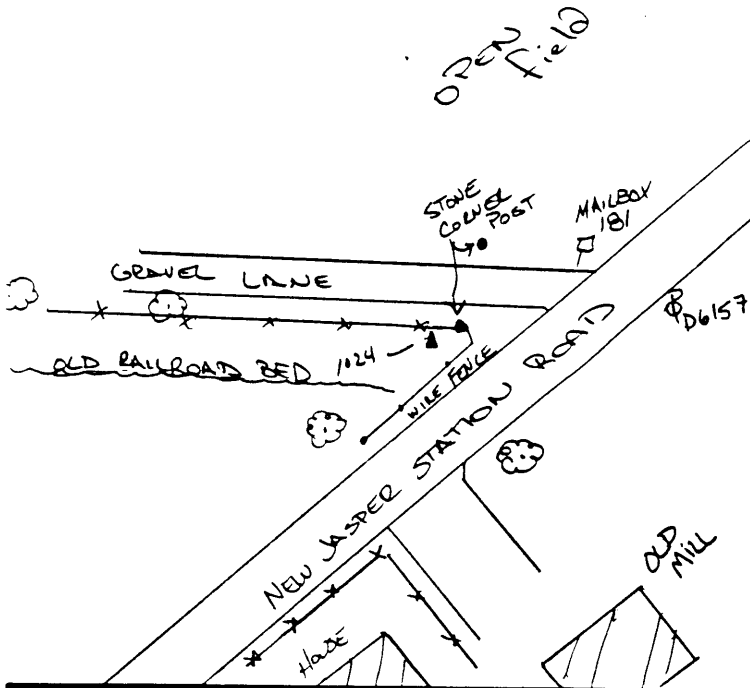

Description:

NOTE: USE 1.5 m Rod DUE TO 1.5 FT PROJECTING POST w/ SURVEY DISK

Type of Mark: DISK RIVETED TO PROJECTING PIPE
 Spacing: 1024
 Agency: CGS

↑
Indicate North

Remarks:

6010-1



DOLPERT

GPS STATION LOG

Station Name: 6010 (NGS 1024)
 Receiver No.: B1 2948 (001)
 Day of Year: 115
 Session No.: A

Project Name: Clinton Co. OH - Bluebooking
 Job Number: 57526
 Local Date: 4/24/00
 Operator: TEM

C/A CODE POSITION

Lat: 39° 40' 07" N
 Long: 83° 48' 41" W
 Ellip. Height: +358.6 M

Trimble: 4000 SSE, 4000 SSL, Other _____
 Antenna: Kinematic, Compact, Groundplane, Dome
 Battery No.: _____
 Tribrach No.: FHT @ 1.498 m
 File Name: 0031-115-A

Antenna H.I. ⇒ Before: 1.561 M _____ Ft
 After: 1.561 M _____ Ft
Rapid Static, Static, Kinematic Survey T.V.

Actual ⇒ Start 17:29 Stop 18:16 UTC
 Start 13:29 Stop 14:16 Local
 Local-UTC Time Offset: -4

SV's Used: _____ Weather: _____

Sketch:

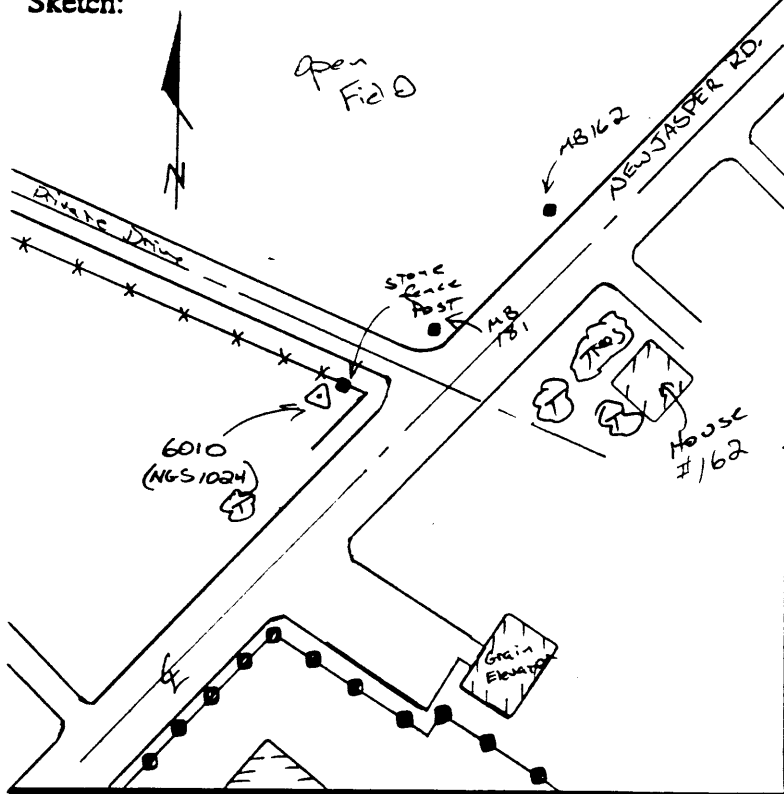

Description:

Antenna Height = $1.498 + 0.063$ m
 = 1.561 m

□ Found as described by UGS
 Notes. PID: JY1141

Surface MET Data:

D °F = 61.9°
 W °F = 51.2°
 % H = 51.0%
 B.P. = 28.82 in Hg
 CODE: 00111

Type of Mark: Monument Disk
 S ping: OHIO 1024
 Agency: USCGS



Remarks:

File name not in photo.