



Station Recovery Log

Station #: 6
 Project Name: CLINTON CO.
 Job Number: 57526
 Local Date: 11.22.99
 Name: JCS

TO-REACH DIRECTIONS

From SR 729 and SR 72,
 take 72 South $\frac{1}{2}$ 40
 miles to station on right.
 86
 87

STATION LOCATION

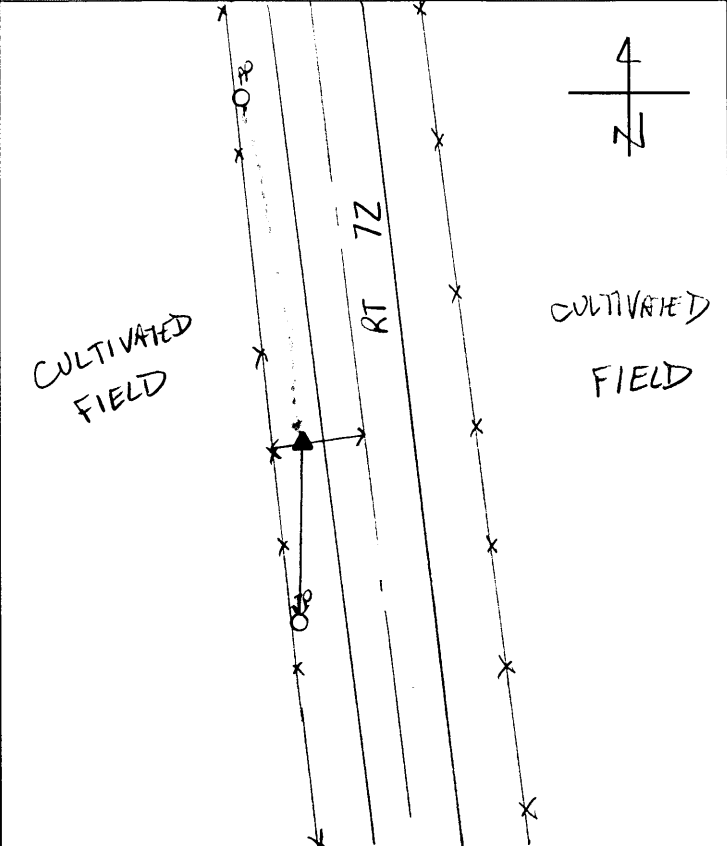

REFERENCES

Reference Object	Distance	Azimuth
Fence	12'	
Ce Rt 72	14'	
TP	90'	

VISIBILITY DIAGRAM

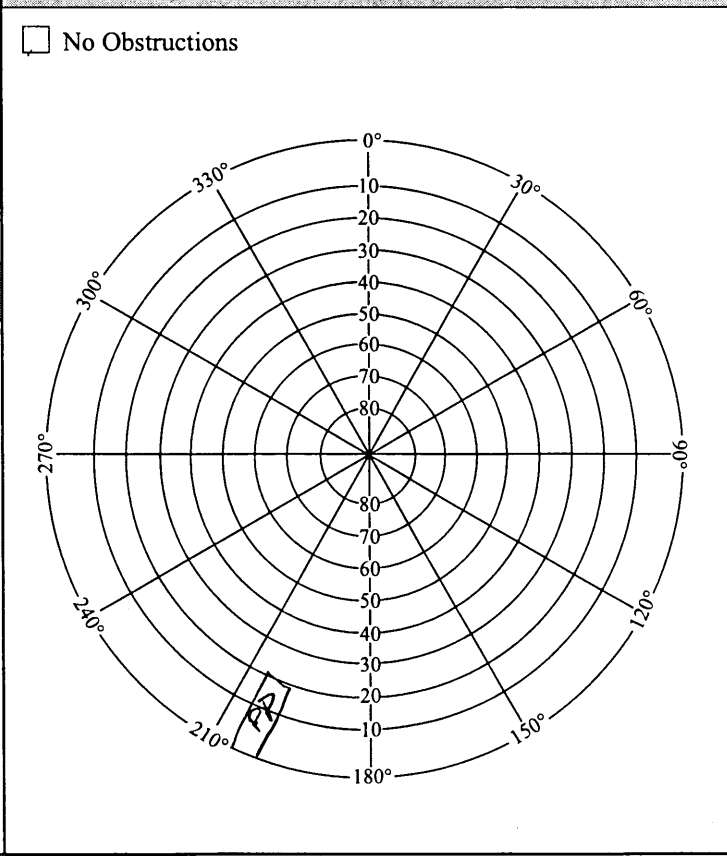

DISC DETAIL

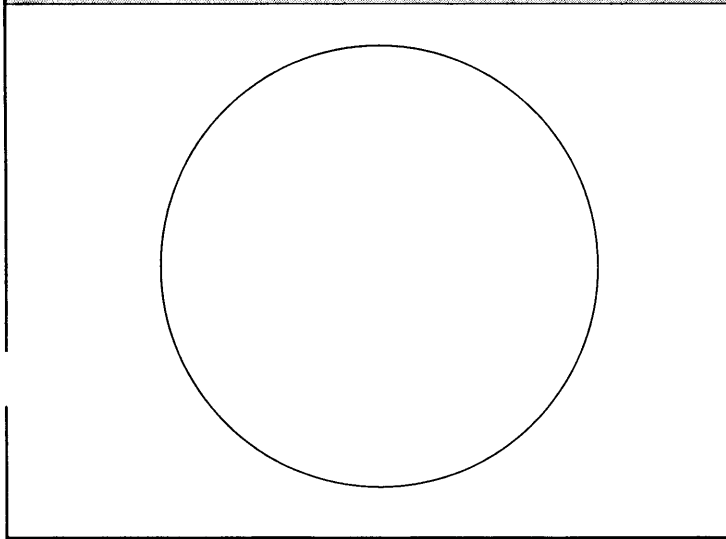



GPS STATION LOG

Station Name: 2006 Project Name: CLINTON CO.
 Receiver No.: 14 Job Number: 57526
 Day of Year: 110 Local Date: 4-19-08
 Session No.: G Operator: T. RIAN

C/A CODE POSITION

Lat: 39 ° 22 ' 50 " N
 Long: 83 ° 35 ' 38 " W
 Ellip. Height: 247.7 M

Trimble: 4000 SSE, 4000 SSL, Other _____
 Antenna: Kinematic, Compact, Groundplane, Dome _____
 Battery No.: 1A-057762
 Tribach No.: _____
 File Name: 2014-110-G

Antenna H.I. ⇒ Before: 2.063 M _____ Ft Actual ⇒ Start 20:52 Stop 21:51 UTC
 After: 2.063 M _____ Ft Start 4:52 Stop 5:51 Local
Rapid Static, Static, Kinematic Survey Local-UTC Time Offset: 4

SV's Used: 04, 05, 06, 10, 13, 18, 24, 30

Weather: 0110

Sketch:

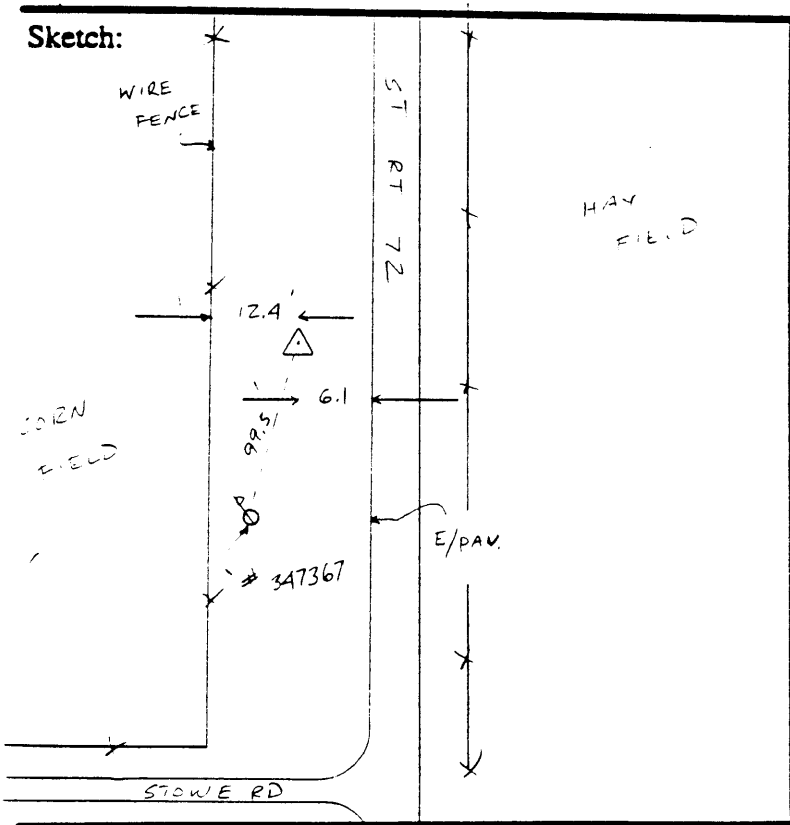

Description: INT ST. RT. 72 & STOWE RD
 SO N 0.09 MI TO PT ON
 W. SIDE OF ROAD.
 BRASS DISC 0.2' BELOW TARGET

Type of Mark: CONC. MON. W BRASS DISC
 Mapping: CLINTON CO # 6
 Agency: CLINTON CO. AUDITOR / ENGINEER



Remarks: DFM 65.8
 WET 56.7
 WJM 57%
 PRESS 28.92