

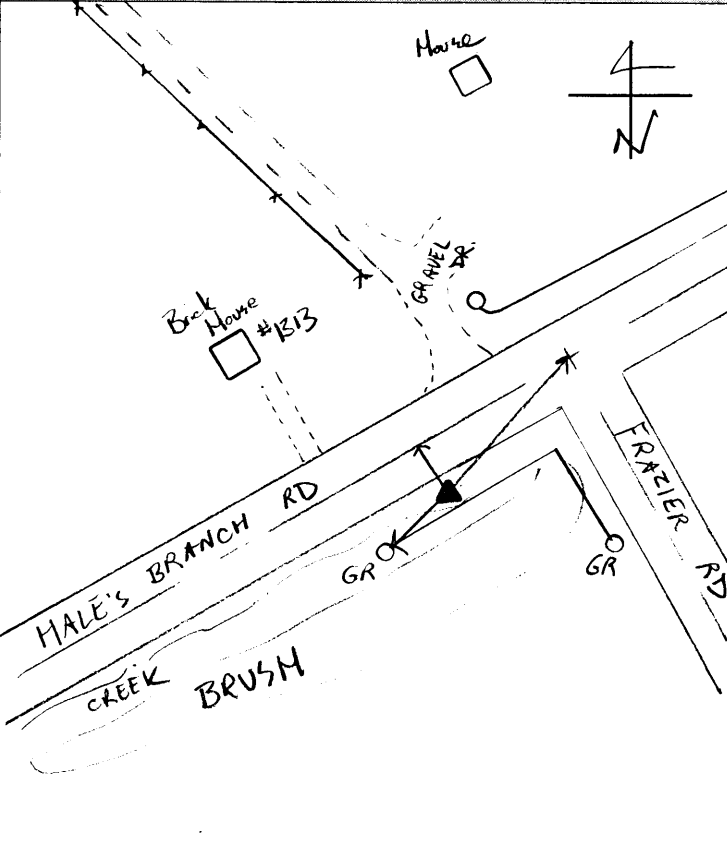

# Station Recovery Log

Station #: 29A  
 Project Name: CLINTON CO.  
 Job Number: 57520  
 Local Date: 11.29.99  
 Name: JCS

## STATION LOCATION



## TO-REACH DIRECTIONS

From US 68 and SR 28, head east on SR 28, 2 miles to CR 28 (Frazier Rd). Turn right and continue SE 1.5 miles to Mills Branch Rd. Turn left onto Mills Branch Rd. Continue 2 miles to station on right.

*409, 408, 407*

## VISIBILITY DIAGRAM

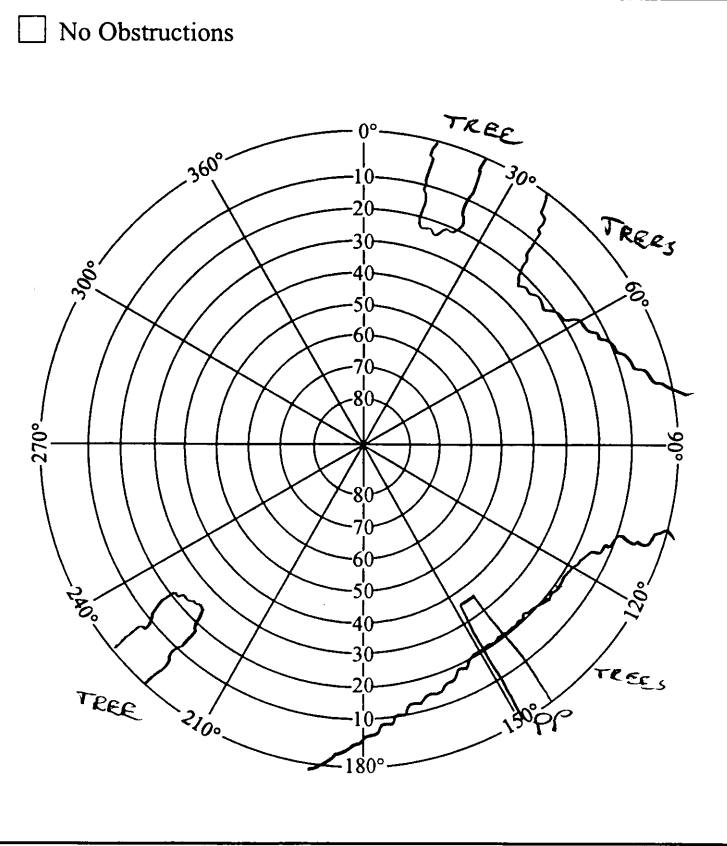

## REFERENCES

Reference Object	Distance	Azimuth
♀	15'	
♀-♀	100'	
End of GR	60'	

## DISC DETAIL

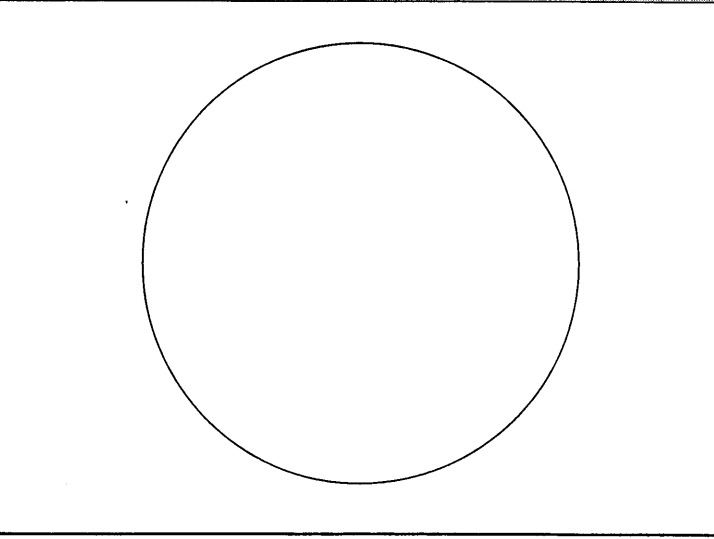



# GPS STATION LOG

Station Name: 2029 Project Name: Clinton Co  
 Receiver No.: 2948 Job Number: 57526  
 Day of Year: 109 Local Date: 4/18/00  
 Session No.: F Operator: C.J.F.

### C/A CODE POSITION

Lat: 39° 17' 48" N  
 Long: 083° 53' 08" W  
 Ellip. Height: +0362 M

Trimble: 4000 SSE, 4000 SSI, Other \_\_\_\_\_  
 Antenna: Kinematic, Compact, Groundplane, Dome \_\_\_\_\_  
 Battery No.: \_\_\_\_\_  
 Tribrach No.: F-H-TP  
 File Name: 2948-109-F

Antenna H.I. => Before: 2.063 M \_\_\_\_\_ Ft  
 After: 2.063 M \_\_\_\_\_ Ft

Actual => Start 22:42 Stop 23:23 UTC  
 Start 18:42 Stop 19:23 Local  
 Local-UTC Time Offset: -4HR

Rapid Static, Static, Kinematic Survey

SV's Used: Dp, 10, 13, 17, 24, 26, 30

Weather: D=65.5° W=55.6° RH=53% RP=28.98  
 Weather Code = 0111

Sketch:

Description:

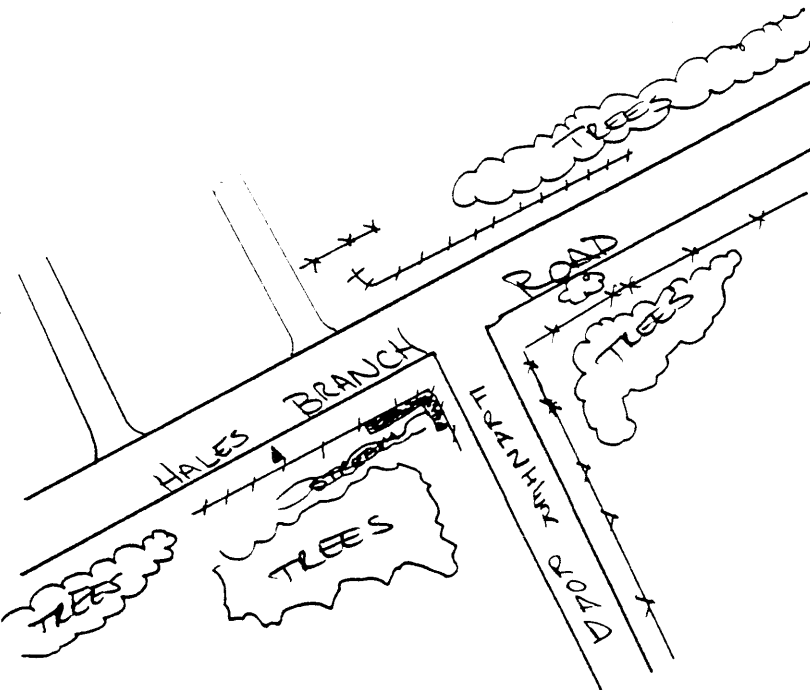

See  
STATION  
Recovery  
Logs  
for  
WITNESS  
TIES

Type of Mark: Disk in COMPLETE  
 Stamping: 29A 2000  
 Agency: Clinton Co

↑  
Indicate North

Remarks:



# GPS STATION LOG

Station Name: 2029 = 29 A  
 Receiver No.: 01  
 Day of Year: 109  
 Session No.: D

Project Name: CLINTON CO.  
 Job Number: 57526  
 Local Date: 18 APR. 00  
 Operator: BJM

### C/A CODE POSITION

Lat: 39° 17' 49.26" N  
 Long: 083° 53' 06.97" W  
 Ellip. Height: 243.1 M

Trimble: 4000 SSE, 4000 SSI, Other \_\_\_\_\_  
 Antenna: Kinematic, Compact, Groundplane, Dome  
 Battery No.: \_\_\_\_\_  
 Tribrach No.: F4 @ 2.00m  
 File Name: 0001-109-D

Antenna H.I. => Before: 2.063 M 6.768 Ft  
 After: 2.063 M 6.768 Ft  
Rapid Static, Static, Kinematic Survey TJ

Actual => Start 19:24 Stop 20:20 UTC  
 Start 15:24 Stop 16:20 Local  
 Local-UTC Time Offset: -4HR

SV's Used: 24, 18, 04, 05, 07, 30, 10, 16

Weather: 01111

chr.  
 DESCRIPTION:  
 ANT: 0220014009  
 REC: 3251A02226

---

THE STATION IS:

- 4.74 m 151° OF THE  $\angle$  OF 067°
- 32.48 m 242° OF THE  $\angle$  @ E.O.P. OF 151° AND W/ FRAZIER RD.
- 20.23 m 056° OF THE SW CORN. OF GALVANISED STEEL GUARD RAIL
- 0.16 m 238° OF A WHITE W/P

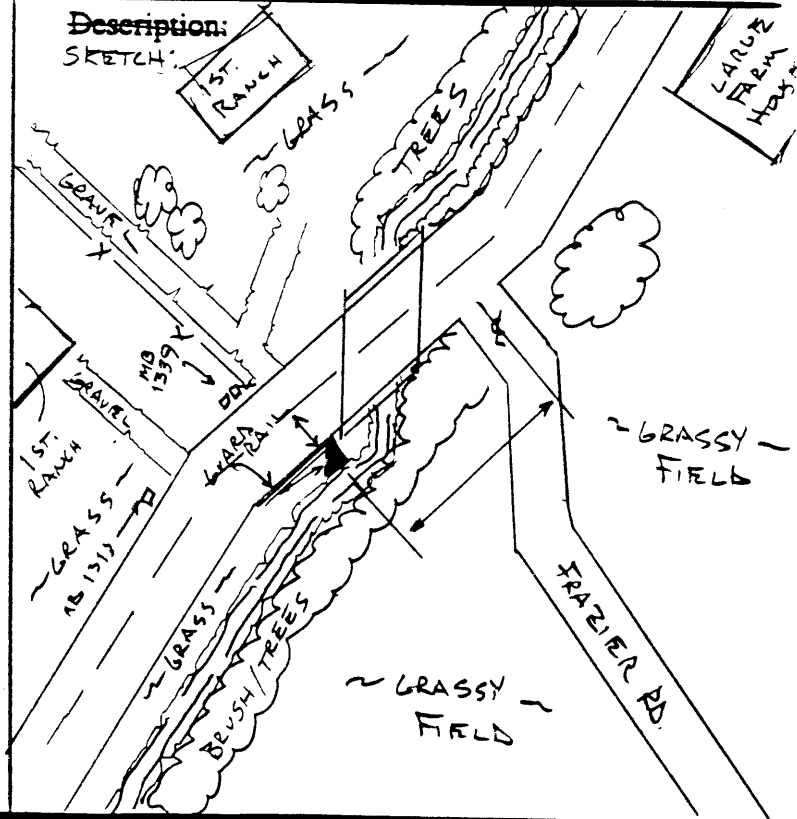

of Mark: BRONZE SURVEY DISK  
 Stamping: 2000 29A  
 Agency: CLINTON CO. AUDITOR/ENGINEER

Indicate North

Remarks:  
 DRY: 56.1°F REL. HUM: 61%  
 WET: 49.2°F BAR. PRES.: 29.00" Hg