



WOOLPERT

Station Recovery Log

Station #: 28A
 Project Name: CLINTON Co.
 Job Number: 57526
 Local Date: 11.29.99
 Name: SCB

STATION LOCATION

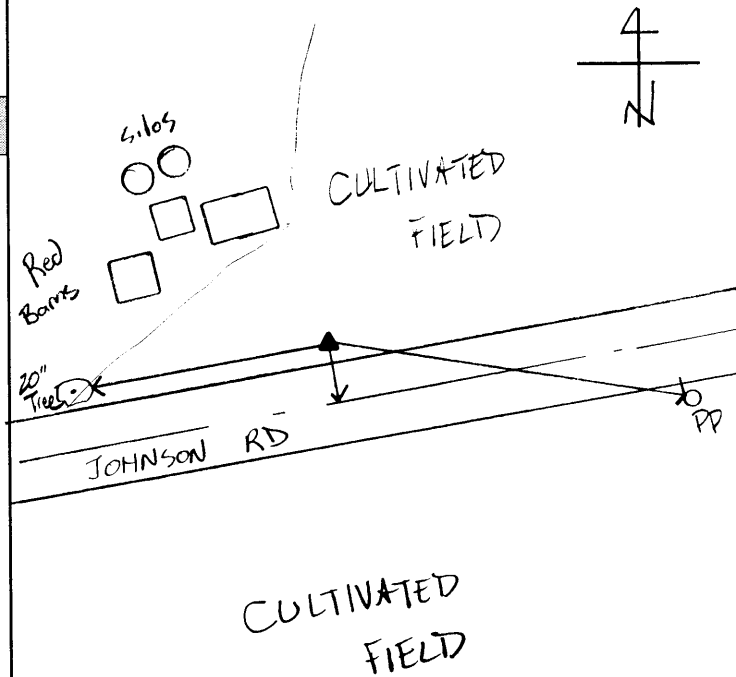

TO-REACH DIRECTIONS

From SR 729 and SR 350 take 729 north 2.2 miles to Antioch Rd - Turn right and head east 1.2 miles to Johnson Rd on left. Take left and travel .8 miles to station on left.

REFERENCES

Reference Object	Distance	Azimuth
<u>C</u>	<u>10'</u>	
<u>PP</u>	<u>160'</u>	
<u>20" Tree</u>	<u>147'</u>	

VISIBILITY DIAGRAM

No Obstructions

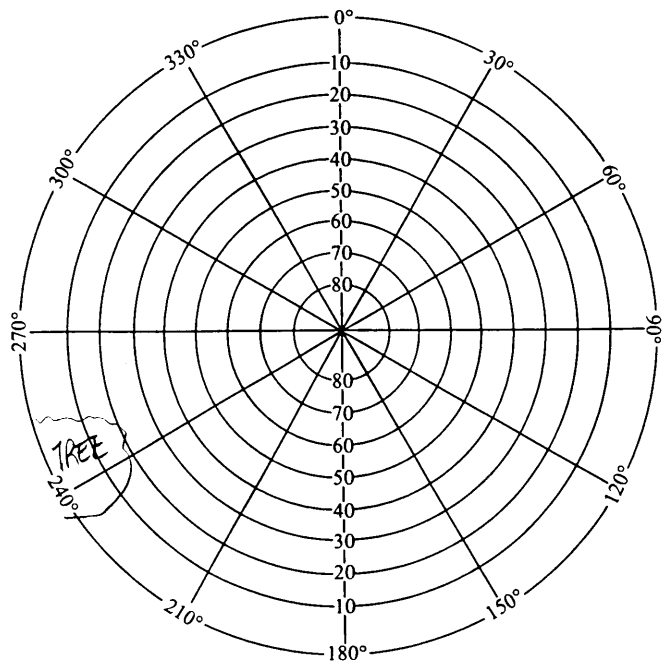

DISC DETAIL

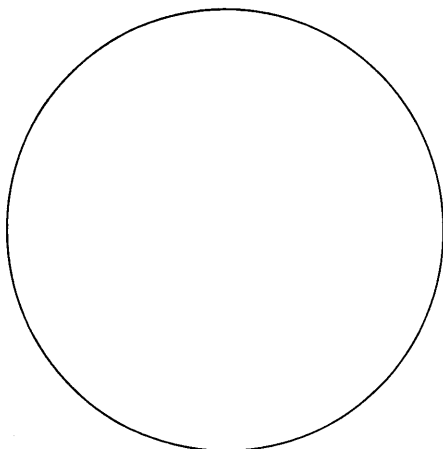



GPS STATION LOG

Station Name: 2028 ≈ 28 A Project Name: CLINTON CO. (BB)
 Receiver No.: 01 Job Number: 57526
 Day of Year: 110 Local Date: 19 APR 00
 Session No.: H → 14 Operator: BJM

C/A CODE POSITION

Lat: 39° 22' 22.54" N
 Long: 083° 39' 13.00" W
 Ellip. Height: 301.1 M

Trimble: 4000 SSE 4000 SSL, Other _____
 Antenna: Kinematic, Compact, Groundplane, Dome
 Battery No.: AUT: 0220014069 REC: 3251A02226
 Tribach No.: FHT @ 200m
 File Name: 0001-110-H

Antenna H.I. ⇒ Before: 2.063 M 6.768 Ft
 After: 2.063 M 6.768 Ft
Rapid Static, Static, Kinematic Survey T.V.

Actual ⇒ Start ²² 17:12 Stop 23:24 UTC
 Start 18:12 Stop 19:24 Local
 Local-UTC Time Offset: 4 HR

SV's Used: 17, 10, 13, 24, 06, 26

Weather: 01111

Sketch:

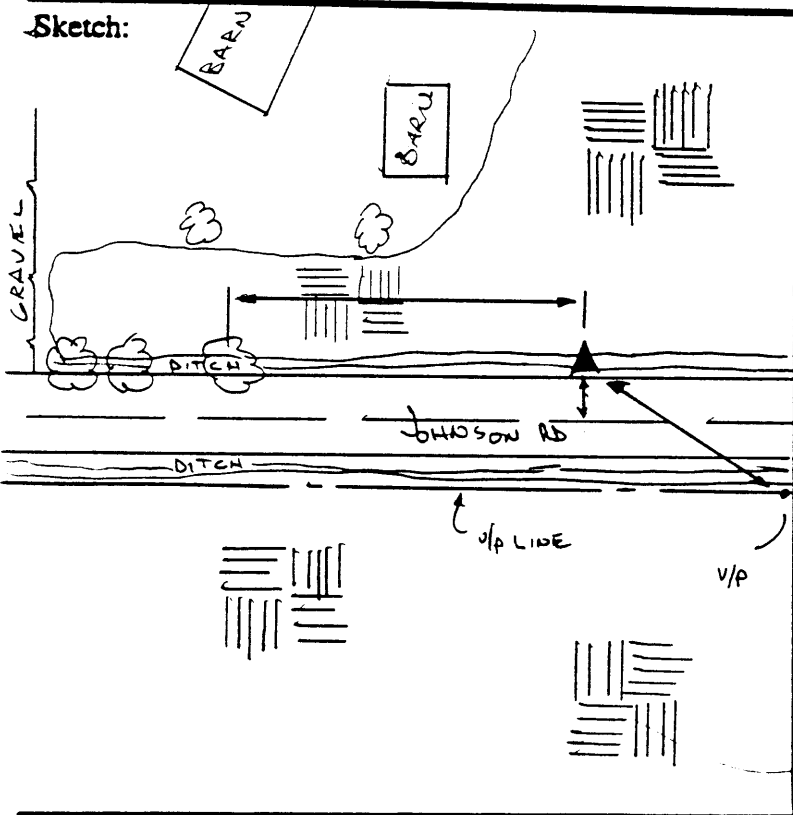

Description:

THE STATION IS:

- 49.28 m 076° OF A 1.09m OAK TREE
- 56.69 m 268° OF A UTILITY POLE DPL 94687
- 4.97 m 348° OF THE ¢ OF THOMAS JOHNSON RD.

Type of Mark: Bronze Survey Disk
 mping: 2000 28 A
 Agency: CLINTON CO GIS AUDITOR/ENGINEER



Remarks:
 DRY: 63.7°F REL: 62.0%
 WET: 56.0°F PRESS: 28.87" Hg



GPS STATION LOG

Station Name: 2028 Project Name: Clinton Co
 Receiver No.: 12 Job Number: 57521
 Day of Year: 110 Local Date: 4-19-00
 Session No.: F Operator: DCB

C/A CODE POSITION

Lat: 39° 22' 22" N
 Long: 83° 39' 11" W
 Ellip. Height: 328 M

Trimble: 4000 SSE, 4000 SSL, Other
 Antenna: Kinematic, Compact, Groundplane, Dome
 Battery No.: 019963 / 115358
 Tribrach No.: FHT
 File Name: 0012-110-F

Antenna H.I. ⇒ Before: 2.063 M _____ Ft Actual ⇒ Start 19:34 Stop 20:25 UTC
 After: 2.063 M _____ Ft Start 15:24 Stop 16:25 Local
Rapid Static Static, Kinematic Survey Local-UTC Time Offset: 4 HR

SV's Used: 24, 04, 07, 30, 16, 05, 10, 18 Weather: _____

Sketch:

Description:

DRY 62.7
 WET 56.0
 HUMID 66.9
 PRESS 28.94
 CODE 01111

Type of Mark: Brass Disk
 Stamping: ZBA
 Agency: Clinton Co Engineer

 Indicate North

Remarks: