



WOOLPERT

Station Recovery Log

Station #: 28
 Project Name: CLINTON CO.
 Job Number: 57524
 Local Date: 11.29.99
 Name: JCS

TO-REACH DIRECTIONS

From SR 729 and SR 340 take 729 north 2.2 miles to Antioch Rd - Turn right and head east 1.2 miles to Johnson Rd on left. Take left and travel 1.0 miles to station on right.

STATION LOCATION

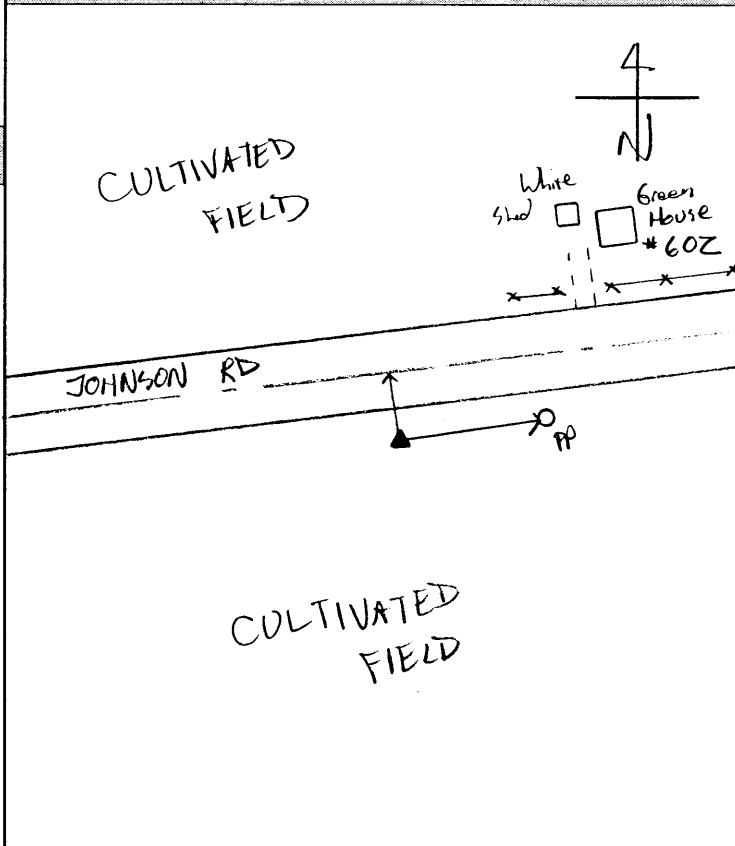

REFERENCES

Reference Object	Distance	Azimuth
PP	46'	
E	11'	

VISIBILITY DIAGRAM

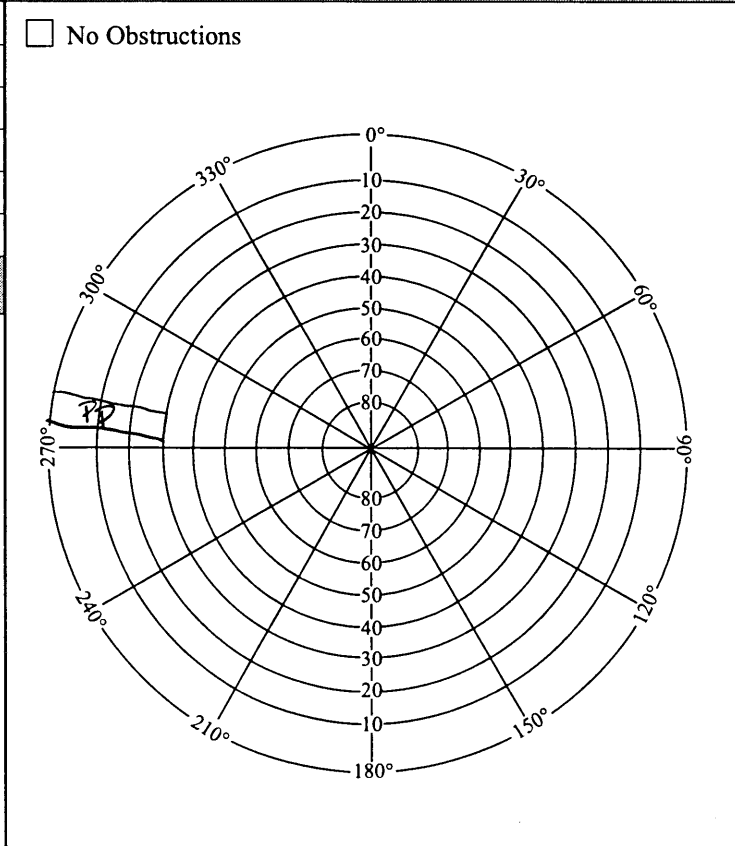

DISC DETAIL

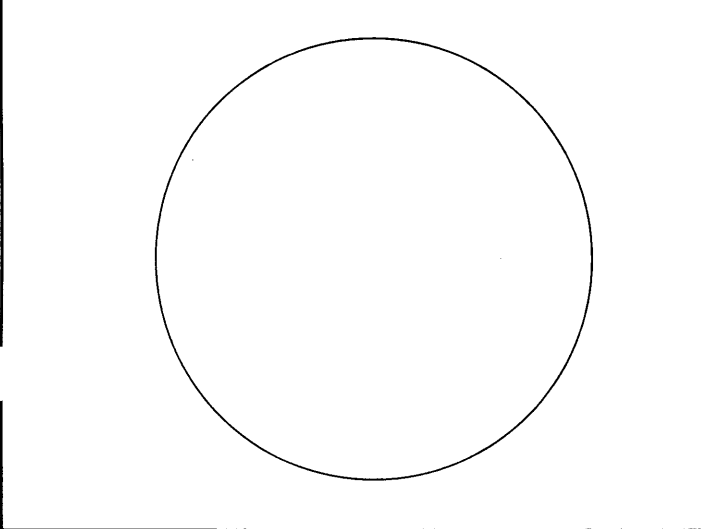



GPS STATION LOG

Station Name: 1028 Project Name: CLINTON CO
 Receiver No.: 1372 Job Number: 57526
 Day of Year: 110 Local Date: 19-APR-00
 Session No.: F Operator: EJR

C/A CODE POSITION

Lat: 39 ° 22 ' 26 " N
 Long: 083 ° 38 ' 58 " W
 Ellip. Height: _____ M

Trimble: 4000 SSE, 4000 SSI, Other _____
 Antenna: Kinematic, Compact, Groundplane, Dome
 Battery No.: 1372 w/ 057732
 Tribrach No.: FT
 File Name: 1372-110-F

Antenna H.I. => Before: 2.063T.V. M _____ Ft
 After: 2.063T.V. M _____ Ft
 Actual => Start 19:34 Stop 20:25 UTC
 Start 15:34 Stop 16:25 Local
 Local-UTC Time Offset: 4HR

Rapid Static, Static, Kinematic Survey

SV's Used: _____ Weather: _____

Sketch:

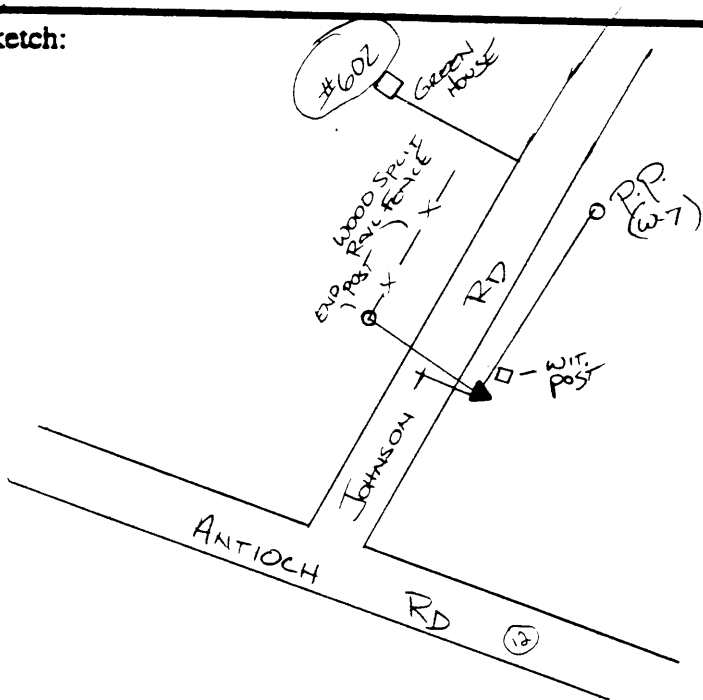

Description:

PP. (27) - 16.05m
 E JOHNSON - 4.65m
 END POST - 17.95m
 (FACE)
 CLINTON CO WITNESS POST - 0.10m

MET DATA:

DRV (F) 62.7
 WET (E) 56.0
 RH 66.90
 BP 29.84
 (002) 0111

Type of Mark: DISK
 Emping: 28
 Agency: _____



Remarks: