



WOOLPERT

Station Recovery Log

Station #: 27A
 Project Name: EVINGTON
 Job Number: 57526
 Local Date: 11.29.99
 Name: JCB

STATION LOCATION

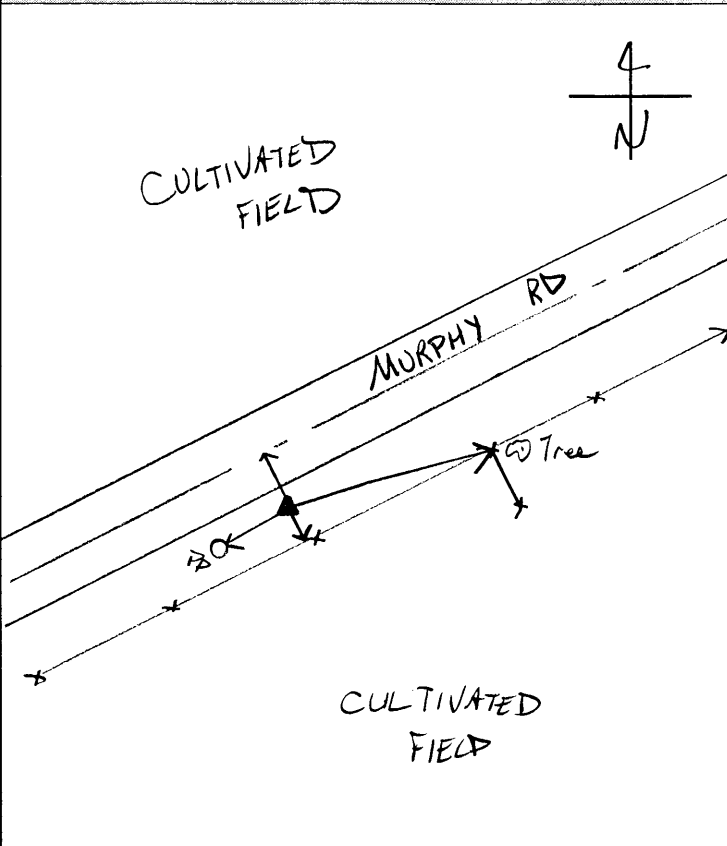

TO-REACH DIRECTIONS

From {US 23} and SR 73, {SR 35}, take SR 73 south 4.8 miles to Murphy Rd on right. Turn right and head SW 1.0 miles to station on left.

4.8 mile to SR 73 and 22/3
 1.0 mile to SR 73

(13)

REFERENCES

Reference Object	Distance	Azimuth
Fence	86'	
♀	13'	
PP	10'	
Fence	2.0'	

VISIBILITY DIAGRAM

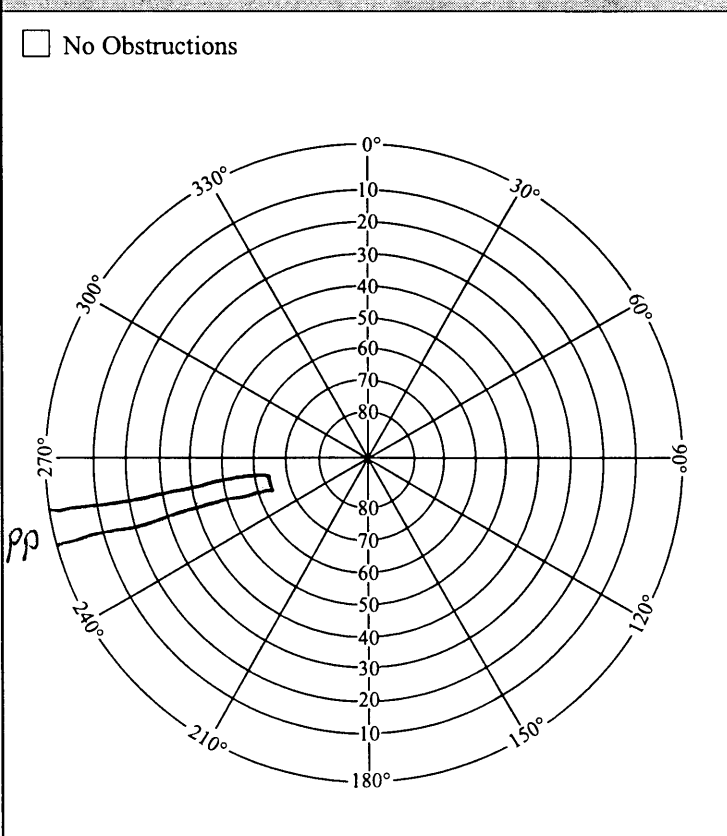

DISC DETAIL

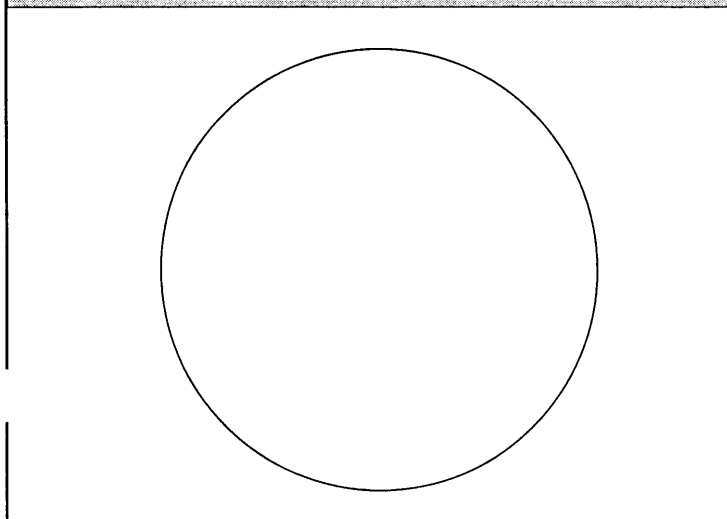



GPS STATION LOG

Station Name: 2027 Project Name: Clinton County
 Receiver No.: 2948 Job Number: 57526
 Day of Year: 110 Local Date: 7/19/00
 Session No.: H Operator: G.T.F

C/A CODE POSITION
 Lat: 39° 22' 53" N Trimble: 4000 SSE, 4000 SSL, Other _____
 Long: 083° 45' 44" W Antenna: Kinematic, Compact, Groundplane, Dome
 Ellip. Height: +0306 M Battery No.: Lot # 33812 Lec 33BA0294B
 Tribach No.: F-A TP.
 File Name: 2948-110-H

Antenna H.I. ⇒ Before: 2.063 M Actual ⇒ Start 22:21 Stop 25:24 UTC
 After: 2.063 M Start 19:21 Stop 19:24 Local
Rapid Static, Static, Kinematic Survey T.V. Local-UTC Time Offset: -4

SV's Used: 30, 06, 10, 13, 17, 24, 26 Weather: D=63.7° W=56.0° RH=62% BP=28.87
 Weather Code = 0111

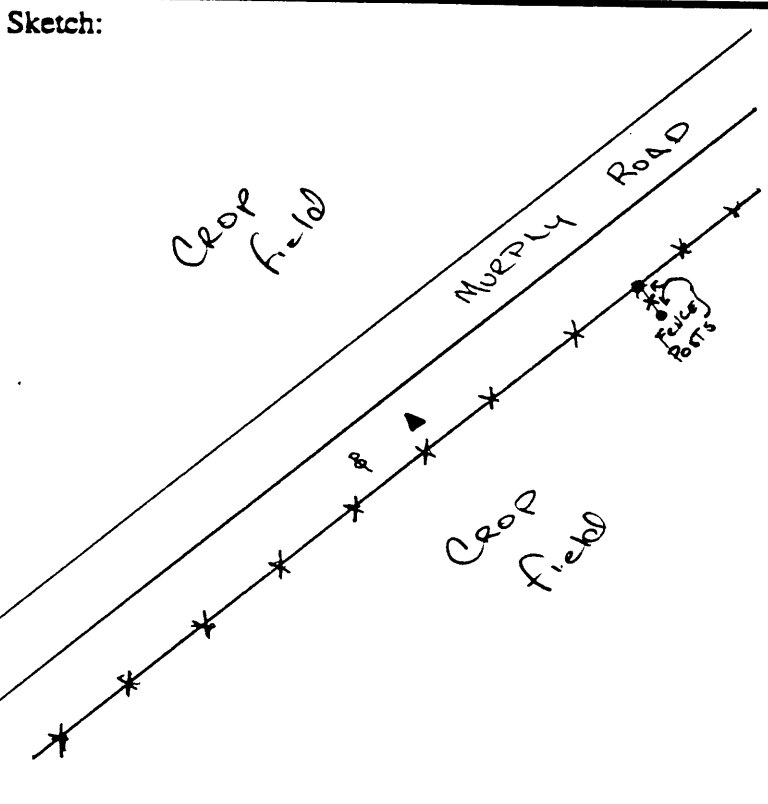

Description:
 Refer To
 STATION Recovery
 Log For TIES
 And To Reach!

Type of Mark: DISK IN CONCRETE
 Mapping: 27A Auditor: ENGINEER 2000
 Agency: Clinton County

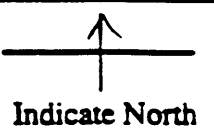

Remarks:



GPS STATION LOG

Station Name: 2027 Project Name: Clinton County
 Receiver No.: 2948 Job Number: 5226
 Day of Year: 111 Local Date: 4-20-00
 Session No.: A Operator: G.T.F

C/A CODE POSITION

Lat: 39 ° 22 ' 54 " N
 Long: 083 ° 45 ' 45 " W
 Ellip. Height: +0259 M

Trimble: 4000 SSE 4000 SSL, Other
 Antenna: Kinematic, Compact, Groundplane, Dome
 Battery No.: Rec# 3313A0248 Ant 053812
 Tribach No.: F-H-TP
 File Name: 2948-111-A

Antenna H.I. => Before: 2.063 M _____ Ft
 After: 2.063 M _____ Ft
Rapid Static, Static, Kinematic Survey

Actual => Start 12 : 12 Stop 13 : 08 UTC
 Start 8 : 12 Stop 9 : 08 Local
 Local-UTC Time Offset: -4

SV's Used: 11, 03, 08, 27, 13, 31, 18, 19, 15

Weather: D=62.4 W=55.6 RH=46% BP=28.67
 weather code = 0111

Sketch:

Refer to
 FILE
 2948-110-H

Description:

Type of Mark: Disk in Conc.
 Mapping: 27A Auditor-ENGINEER 2000
 Agency: Clinton County

Indicate North

Remarks:

27A-3