

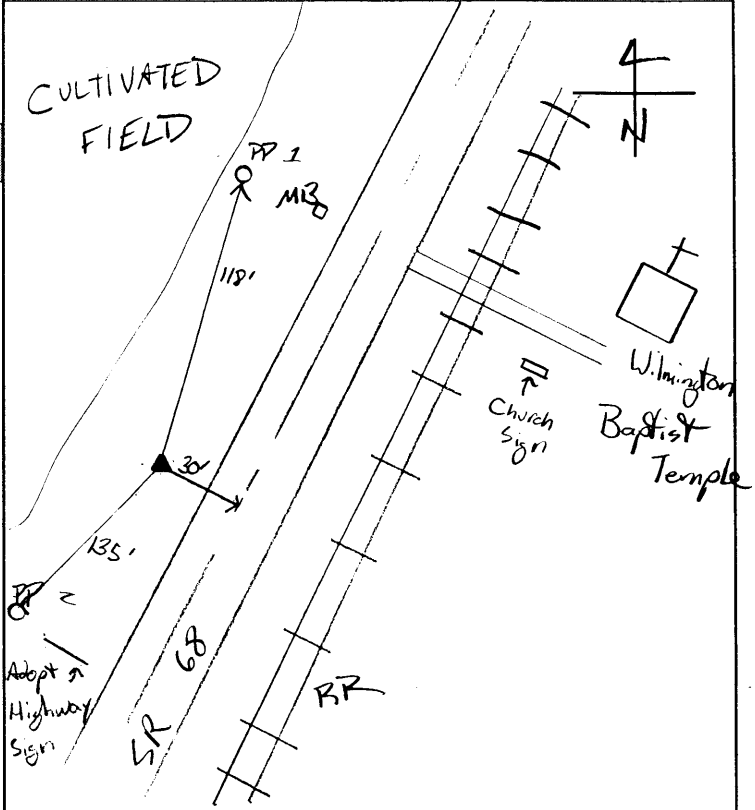

Station Recovery Log

Station #: 26 A
 Project Name: CLINTON CO.
 Job Number: 57520
 Local Date: 11.29.99
 Name: JCB

STATION LOCATION



TO-REACH DIRECTIONS

From SR 68 and SR 22
 take 68 South 2.4 miles
 to station on right.

122
 123

REFERENCES

Reference Object	Distance	Azimuth
SR 68	30'	
PP 1	118'	
PP 2	135'	

VISIBILITY DIAGRAM

No Obstructions

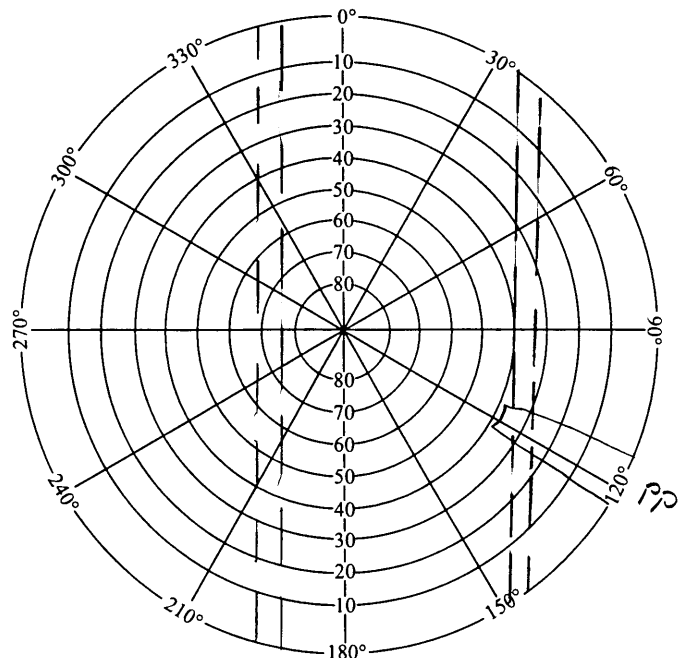

DISC DETAIL

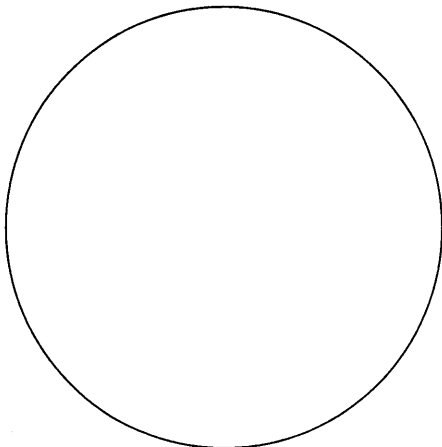



GPS STATION LOG

Station Name: 2026
 Receiver No.: 1377
 Day of Year: 109
 Session No.: EF

Project Name: CLINTON Co
 Job Number: 57526
 Local Date: 18-APR-00
 Operator: ER

C/A CODE POSITION

Lat: 39° 24' 33" N
 Long: 083° 50' 54" W
 Ellip. Height: _____ M

Trimble: 4000 SSE, 4000 SSL, Other _____
 Antenna: Kinematic, Compact, Groundplane, Dome
 Battery No.: _____
 Tribrach No.: FR
 File Name: 1377-109-F

Antenna H.I. \Rightarrow Before: 2.063 T.V M _____ Ft
 #057732 After: 2.063 T.V M _____ Ft
Rapid Static, Static, Kinematic Survey

Actual \Rightarrow Start 22:12 Stop 23:23 UTC
 Start 18:12 Stop 19:23 Local
 Local-UTC Time Offset: -4 HR

SV's Used: _____

Weather: _____

Sketch:

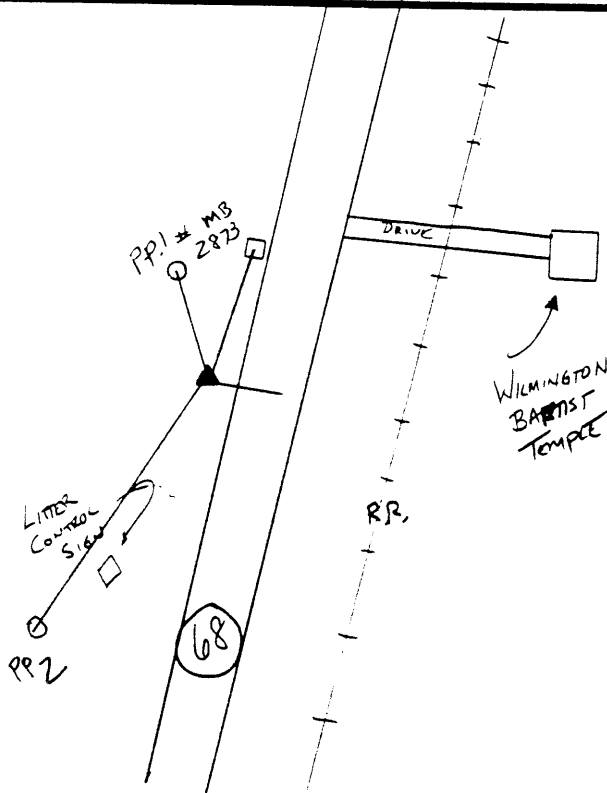

Description:

ppt-43.24m
 MB - 45.44m
 2873
 PP2 - 46.15m
 E 68 - 9.8m

MET DATA:

DRIFT (F) _____
 WET (F) 65.5
 RH 53%
 BP 28.98
 Code 01111

of Mark: BRASS DISC

Stamping: 26A AUDITOR/ENGINEER 2000

Agency: CLINTON Co. AUDITOR/ENGINEER



Indicate North

Remarks:



VOOLPERT

GPS STATION LOG

Station Name: 7026 Project Name: Clinton Co
 Receiver No.: 12 Job Number: 57626
 Day of Year: 111 Local Date: 4/20/00
 Session No.: A Operator: DOB

C/A CODE POSITION

Lat: 39° 24' 34" N
 Long: 83° 50' 54" W
 Ellip. Height: 219 M

Trimble: 4000 SSE, 4000 SSI, Other
 Antenna: Kinematic, Compact, Groundplane, Dome
 Battery No.: 019963 / 215353
 Tribrach No.: EHT
 File Name: 0012-111-A

Antenna H.I. ⇒ Before: 2.063 M _____ Ft Actual ⇒ Start 12:12 Stop 13:08 UTC
 After: 2.063 M _____ Ft Start 9:12 Stop 9:08 Local
 Rapid Static, Static, Kinematic Survey Local-UTC Time Offset: -4

SV's Used: 01, 03, 13, 08, 27, 31, 15, 18, 19 Weather: _____

Sketch:

Description:

Dry 62.4
 Wet 55.6
 Hum 66%
 Press 28.67
 Code 01111

Type of Mark: BRASS DISC
 mping: 26A 2000
 Agency: CLINTON CO. ADTOR-ENGINEER

Indicate North

Remarks: