



Station Recovery Log

Station #: 25
 Project Name: CLINTON CO.
 Job Number: 57526
 Local Date: 11.29.99
 Name: JCB

TO-REACH DIRECTIONS

From SR 68 and SR 22 take 68 South $\frac{1}{2}$ 40 miles to W. Dalton Rd on right. Turn onto W. Dalton and curve to the left and go 1.3 miles to point on left.
 1026 placed marker
 1027

STATION LOCATION

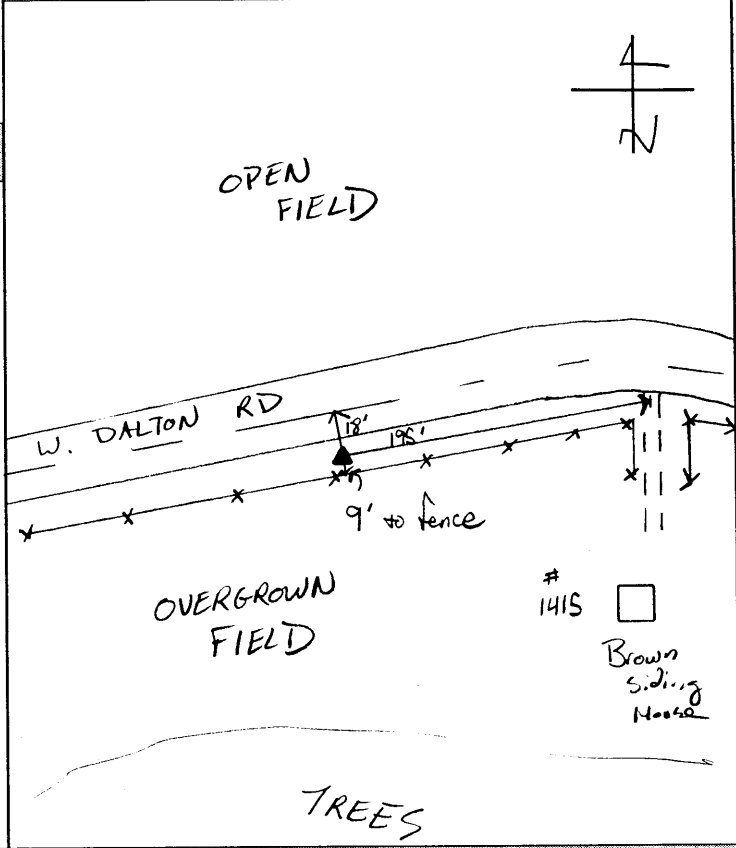

REFERENCES

| Reference Object | Distance | Azimuth |
|------------------|----------|---------|
| W Dalton Rd | 18' | |
| Driv | 195' | |
| Fence | 9' | |
| | | |
| | | |

VISIBILITY DIAGRAM

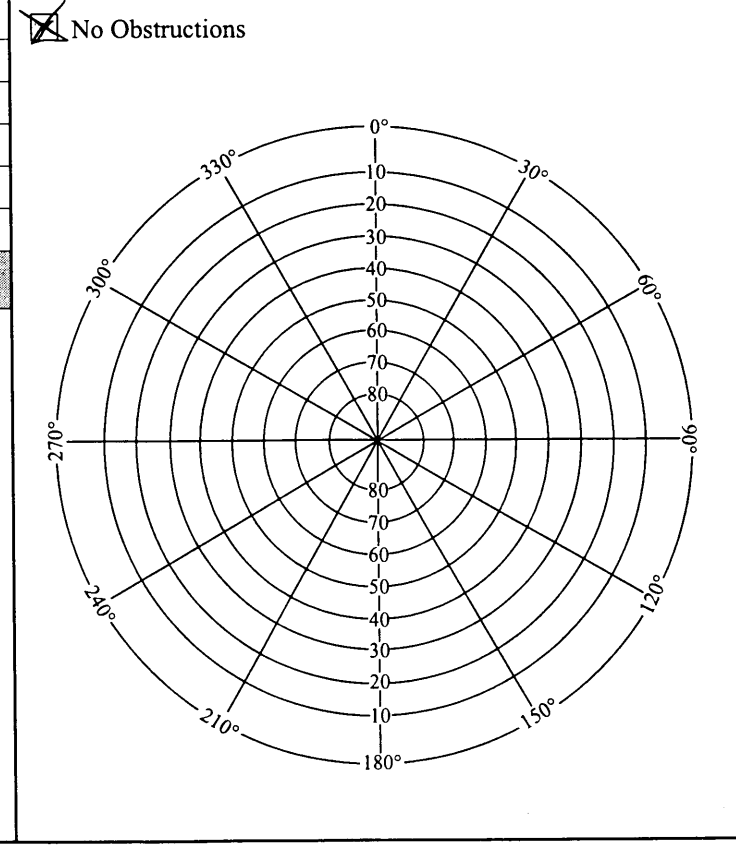

DISC DETAIL

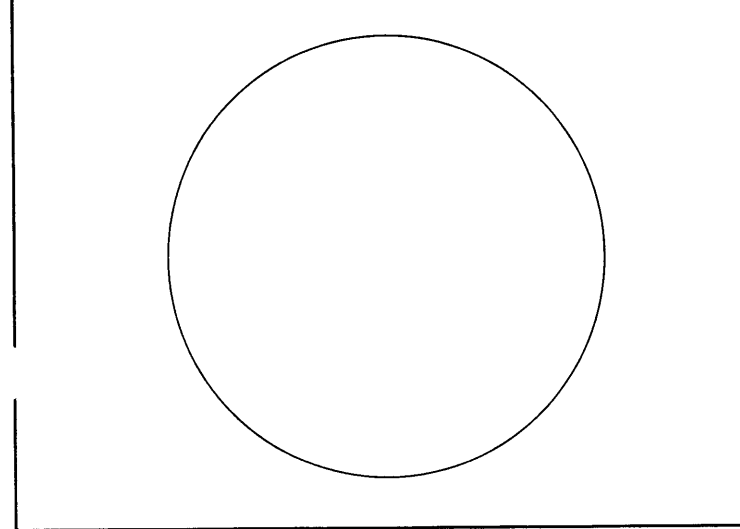



GPS STATION LOG

Station Name: 1025 = 25
 Receiver No.: 01
 Day of Year: 109
 Session No.: SE

Project Name: CLINTON CO.
 Job Number: 57526
 Local Date: 18 APR. 00
 Operator: BJM

C/A CODE POSITION

Lat: 39° 23' 22.77" N
 Long: 083° 52' 36.30" W
 Ellip. Height: 283.7 M

Trimble: 4000 SSE 4000 SSL, Other _____
 Antenna: Kinematic, Compact Groundplane, Dome
 Battery No.: _____
 Tribrach No.: FLT @ 2.00m
 File Name: 0001-109-E

Antenna H.I. ⇒ Before: 2.063 M 6.768 Ft
 After: 2.063 M 6.768 Ft

Actual ⇒ Start 20:52 Stop 21:45 UTC
 Start 16:52 Stop 17:45 Local

Rapid Static, Static, Kinematic Survey TV

Local-UTC Time Offset: -4HR

SV's Used: 30 04 05 06 10 13 24

Weather: 0111

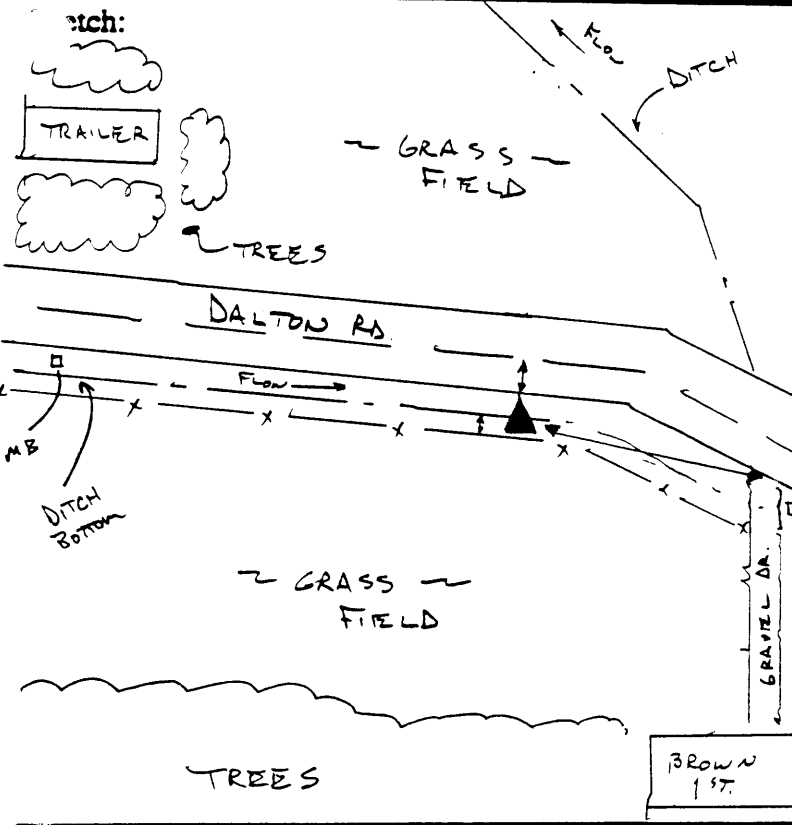

Description:
 ANT: 0220014089
 REC: 3251A02226

THE STATION IS:

- 63.3 m 248° OF 1/2 OF GRAVEL DRIVE @ RES. W/ E.O.P. OF DALTON RD.
- 2.34 m 333° OF FENCE LINE
- 6.50 m 151° OF Q OF DALTON RD
- 0.21 m 276° OF WHITE W/P

Color of Mark: Bronze Survey Disk
 Stamping: 2000 25
 Agency: CLINTON CO. GIS AUDITOR / ENGINEER

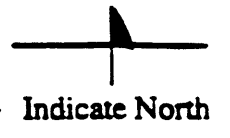

Remarks:
 DRY: 65.0° REL: 48%
 WET: 54.5° PRE: 29.02



GPS STATION LOG

Station Name: 1025 = 25
 Receiver No.: 01
 Day of Year: 109
 Session No.: F

Project Name: CLINTON CO.
 Job Number: 57526
 Local Date: 18 APR. 00
 Operator: BJM

C/A CODE POSITION

Lat: 39 ° 23 ' 22.78 " N
 Long: 083 ° 52 ' 36.29 " W
 Ellip. Height: 283.1 M

Trimble: 4000 SSE, 4000 SSI, Other _____
 Antenna: Kinematic, Compact, Groundplane, Dome
 Battery No.: _____
 Tribrach No.: FUT @ 2.00m
 File Name: 0001-109-F

Antenna H.I. ==> Before: 2.063 M 6.768 Ft
 After: 2.063 M 6.768 Ft
Rapid Static, Static, Kinematic Survey T.V.

Actual ==> Start 21 : 54 Stop 23 : 23 UTC
 Start 17 : 54 Stop 19 : 23 Local
 Local-UTC Time Offset: 4 HR

SV's Used: _____ Weather: 01111

atch:

Description:

of Mark: BRONZE SURVEY DISK
 Stamping: 2000 25
 Agency: CLINTON CO. GIS AUDITOR/ENGINEER

Indicate North

Remarks:
 DRY: 65.5°F REL: 53%
 WET: 55.6°F PRES: 28.98