



Station Recovery Log

Station #: 23A
 Project Name: CLINTON CO
 Job Number: 57526
 Local Date: 11.29.99
 Name: JCB

TO-REACH DIRECTIONS

From SR 22/3 and SR 72
 Take 72 south 1.5 to
 point on left

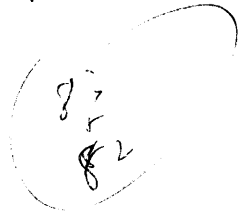

STATION LOCATION

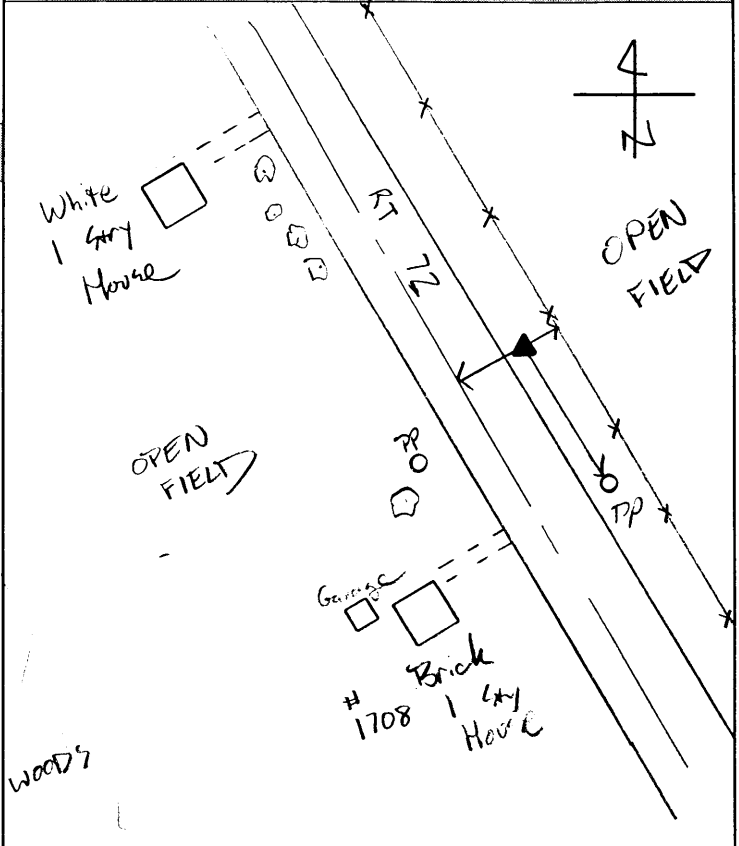

REFERENCES

Reference Object	Distance	Azimuth
RT 72	15'	
PP	81'	
Fence	13'	

VISIBILITY DIAGRAM

No Obstructions

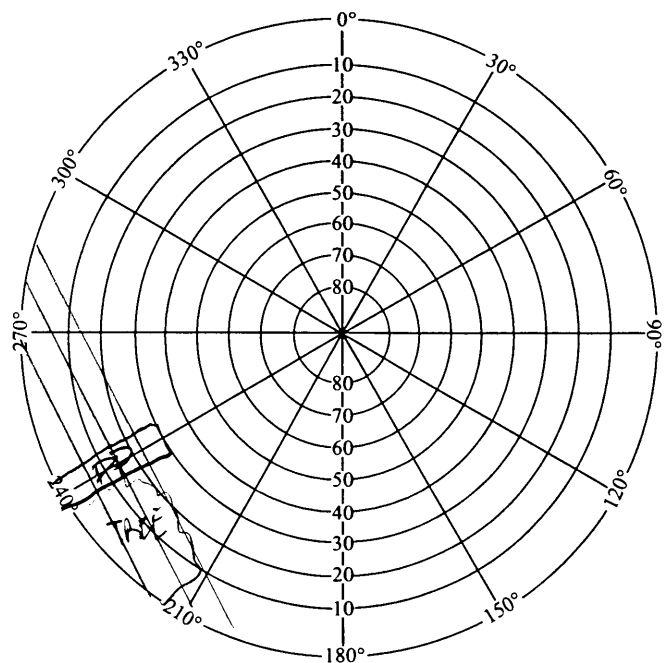

DISC DETAIL

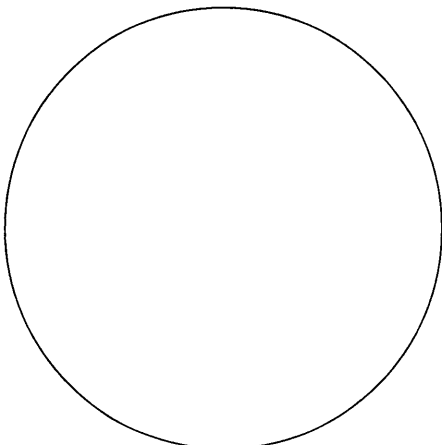



GPS STATION LOG

Station Name: 2023
 Receiver No.: 1
 Day of Year: 115
 Session No.: D

Project Name: CLINTON CO.
 Job Number: 57526
 Local Date: 4-24-00
 Operator: T.E.R

C/A CODE POSITION

Lat: 39° 27' 28" N
 Long: 83° 39' 18" W
 Ellip. Height: 329.4 M

Trimble: 4000 SSE, 4000 SSI, Other _____
 Antenna: Kinematic, Compact, Groundplane, Dome
 Battery No.: 1-014009
 Tribrach No.: _____
 File Name: 0001-115-D

Antenna H.I. ⇒ Before: 2.063 M _____ Ft
 After: 2.063 M _____ Ft
 Rapid Static, Static, Kinematic Survey

Actual ⇒ Start 21:15 Stop 22:06 UTC
 Start 5:15 Stop 6:06 Local
 Local-UTC Time Offset: 4

SV's Used: 04, 05, 06, 10, 13, 30, 26, 24

Weather: 00111

Sketch:

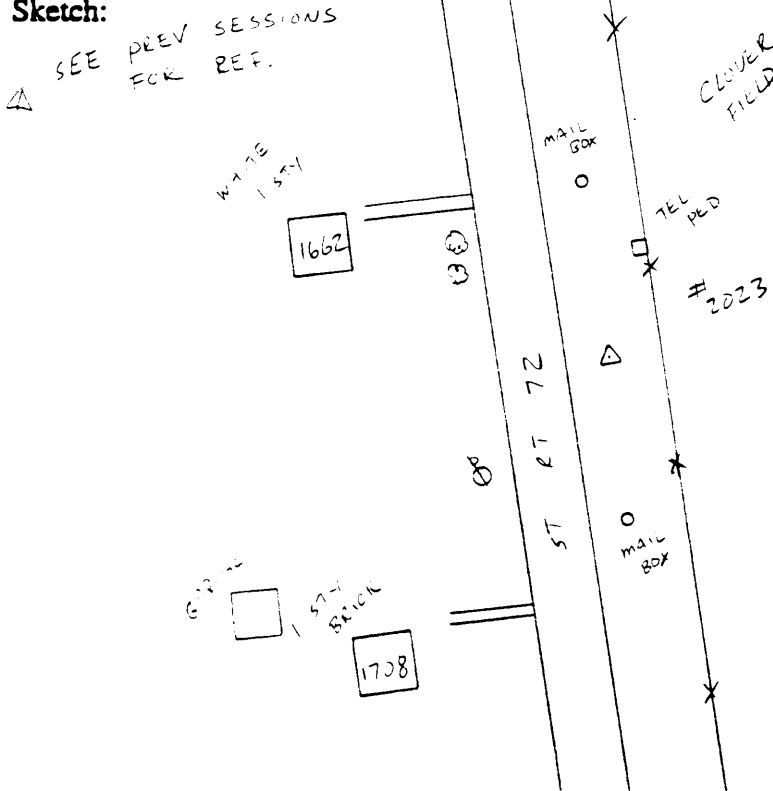

Description:

Type of Mark: CONC MON W/ BRASS DISC
 Mapping: CLINTON CO # 23A
 Agency: CLINTON CO AUDITOR/ENGINEER



Remarks: 67.1
50.8
4090
28.68



GPS STATION LOG

Station Name: 2023 Project Name: CLINTON CO
 Receiver No.: 1377 Job Number: 57526
 Day of Year: 110 Local Date: 19-APR-00
 Session No.: 8G Operator: CTR

C/A CODE POSITION

Lat: 39° 27' 28" N
 Long: 083° 39' 18" W
 Ellip. Height: _____ M

Trimble: 4000 SSE, 4000 SSI, Other _____
 Antenna: Kinematic, Compact, Groundplane, Dome
 Battery No.: 1372 W 87737
 Tribach No.: Fit
 File Name: 1372-110-G

Antenna H.I. => Before: 2.063 TV M _____ Ft Actual => Start 20:59 Stop 21:52 UTC
 After: 2.063 TV M _____ Ft Start 16:59 Stop 17:52 Local
Rapid Static, Static, Kinematic Survey Local-UTC Time Offset: 4HR

SV's Used: _____ Weather: _____

Sketch:

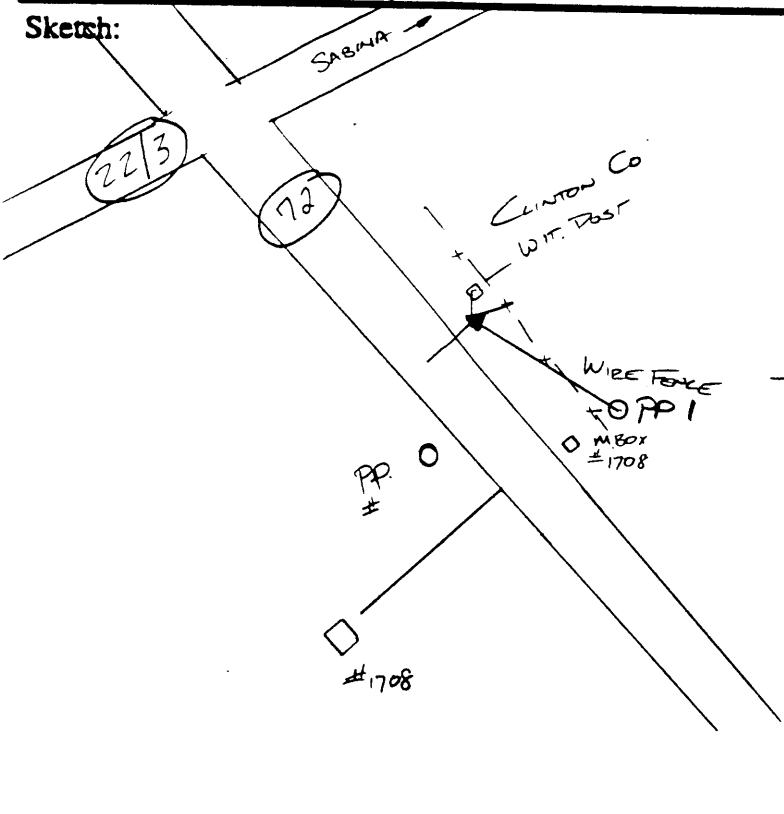

Description:

DR₁^(F) - 65.8
 WE₁^(F) - 56.7
 RH - 57.90
 BP - 28.92
 Code - 01110
 WIT. POST - 0.19M
 Q 72 - 4.7M
 PPI - 27.02M
 FENCE - 4.01M

Type of Mark: BRASS DISC
 Mapping: 23A 2000
 Agency: CLINTON CO. AIDOR / ENGINEER

↑
 Indicate North

Remarks:

23A-3