



Station Recovery Log

Station #: 22
 Project Name: CLINTON CO.
 Job Number: 57526
 Local Date: 11.29.99
 Name: JCB

TO-REACH DIRECTIONS

From 73 split from 22/3,
 take 22/3 East 1.4 miles
 to Stone Rd on left. Turn
 left and continue 1.0 miles
 to station on left
 (FROM WHERE 73 HEADS SOUTH EAST
 OF WILMINGTON)

1.4 to 73 split
 1.0 miles from RT 22/3

95°
 95°

STATION LOCATION

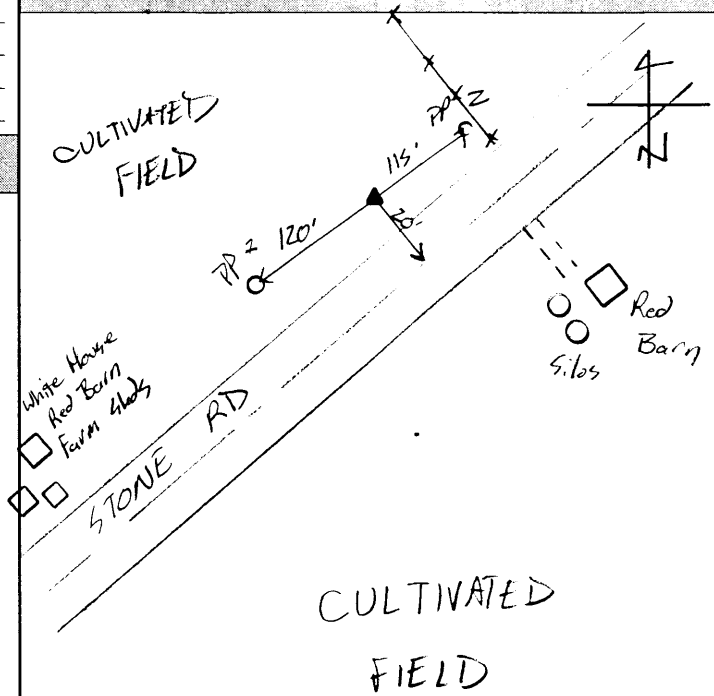

REFERENCES

Reference Object	Distance	Azimuth
PP 1	120'	
PP 2	115'	
STONE RD.	20'	

VISIBILITY DIAGRAM

No Obstructions

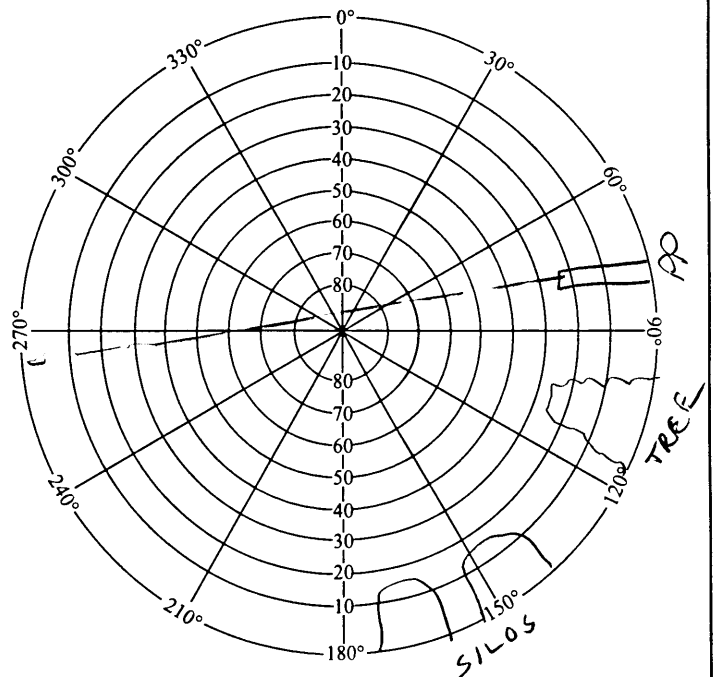

DISC DETAIL

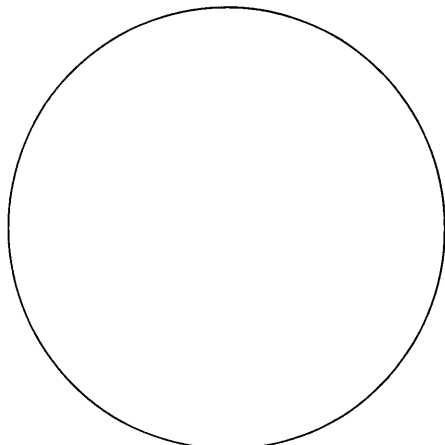



GPS STATION LOG

Station Name: 1022 Project Name: CLINTON CO
 Receiver No.: 14 Job Number: 57576
 Day of Year: 111 Local Date: 4-20-00
 Session No.: B Operator: T.E.R

C/A CODE POSITION

Lat: 39° 28' 11" N
 Long: 83° 44' 43" W
 Ellip. Height: 337.0 M

Trimble: 4000 SSE, 4000 SSL, Other
 Antenna: Kinematic, Compact, Groundplane, Dome
 Battery No.: 14-057763
 Tribrach No.: _____
 File Name: 0014-111-B

Antenna H.I. ⇒ Before: 2.063 M _____ Ft Actual ⇒ Start 13:28 Stop 14:30 UTC
 After: 2.063 M _____ Ft Start 9:31 Stop 10:30 Local
Rapid Static, Static, Kinematic Survey Local-UTC Time Offset: 4

SV's Used: 02, 27, 31, 08, 11, 13, 15, 9 Weather: 01111

Sketch:

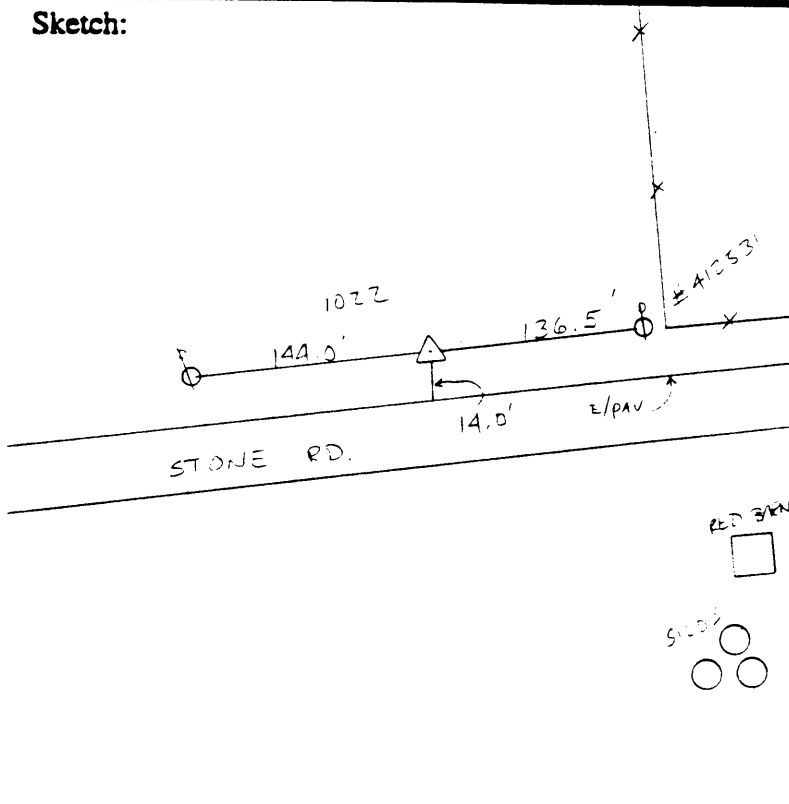

Description:

0.2' FROM TARGET TO
BRASS DISC.

Type of Mark: CONC. MON. W/ BRASS DISC
 Mapping: CLINTON CO = 22
 Agency: CLINTON CO ENGINEER - AUSTON

Indicate North

Remarks: 65.9
57.8
61.9
28.64

~~22-2~~ 22-2



GPS STATION LOG

Station Name: 1022 Project Name: Clinton Co
 Receiver No.: 12 Job Number: 57526
 Day of Year: 115 Local Date: 4-24-00
 Session No.: B Operator: DCB

C/A CODE POSITION

Lat: 39° 28' 17" N
 Long: 83° 14' 44" W
 Ellip. Height: 366 M

Trimble: 4000 SSE, 4000 SSI, Other
 Antenna: Kinematic, Compact, Groundplane, Dome
 Battery No.: A15386 019963
 Tribrach No.: F.H.T.
 File Name: 2002-115-B

Antenna H.I. ⇒ Before: 2.063 M _____ Ft Actual ⇒ Start 18:43 Stop 19:39 UTC
 After: 2.063 M _____ Ft Start 14:43 Stop 15:39 Local
Rapid Static, Static, Kinematic Survey Local-UTC Time Offset: -4

SV's Used: 24, 04, 05, 07, 16, 10 Weather: _____

Sketch:

Description:
 Dry 68.8
 Wet 55.0
 Hum 38%
 Press 28.74
 Code 00111

Type of Mark: Brass Disk
 amping: 22
 Agency: Clinton Co Eng

Indicate North

Remarks:

~~22A~~ 22-3



GPS STATION LOG

Station Name: 1022 Project Name: Clinton Co
 Receiver No.: 12 Job Number: 57526
 Day of Year: 115 Local Date: 4-24-00
 Session No.: C Operator: TJB

C/A CODE POSITION

Lat: 39° 28' 10" N
 Long: 83° 44' 43" W
 Ellip. Height: 336 M

Trimble: 4000 SSE, 4000 SSI, Other
 Antenna: Kinematic, Compact, Groundplane, Dome
 Battery No.: A15388 019963
 Tribach No.: EHT
 File Name: 0012-115-C

Antenna H.I. ⇒ Before: 2.063 M _____ Ft Actual ⇒ Start 20:04 Stop 20:51 UTC
 After: 2.063 M _____ Ft Start 16:04 Stop 16:51 Local
 Rapid Static, Static, Kinematic Survey Local-UTC Time Offset: -4

SV's Used: 24, 18, 04, 05, 13, 30, 10 Weather: _____

Sketch:

Description:

Dry 64.4
WET 50.7
HUM 38%
PRESS 28.69
Code 0011

Type of Mark: BRASS DISC
 amping: 22 2000
 Agency: CLINTON Co. ADTOR / ENGINEER

Indicate North

Remarks:

~~22-3~~ 22-4