

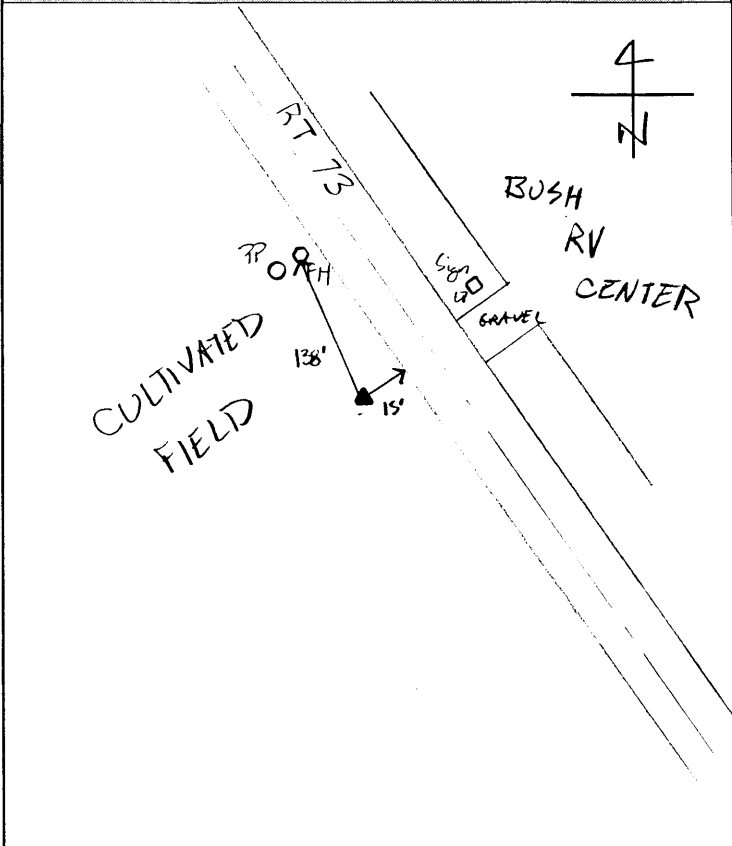

Station Recovery Log

station #: 21A
 Project Name: CLINTON CO.
 Job Number: 07520
 Local Date: 11.29.99
 Name: SCB

STATION LOCATION



TO-REACH DIRECTIONS

From 73 east splits
 from 22/3, head
 east on 73 for .2
 miles to station on right
 51+52

REFERENCES

Reference Object	Distance	Azimuth
FH	138'	
EOP Rt 73	15'	

VISIBILITY DIAGRAM

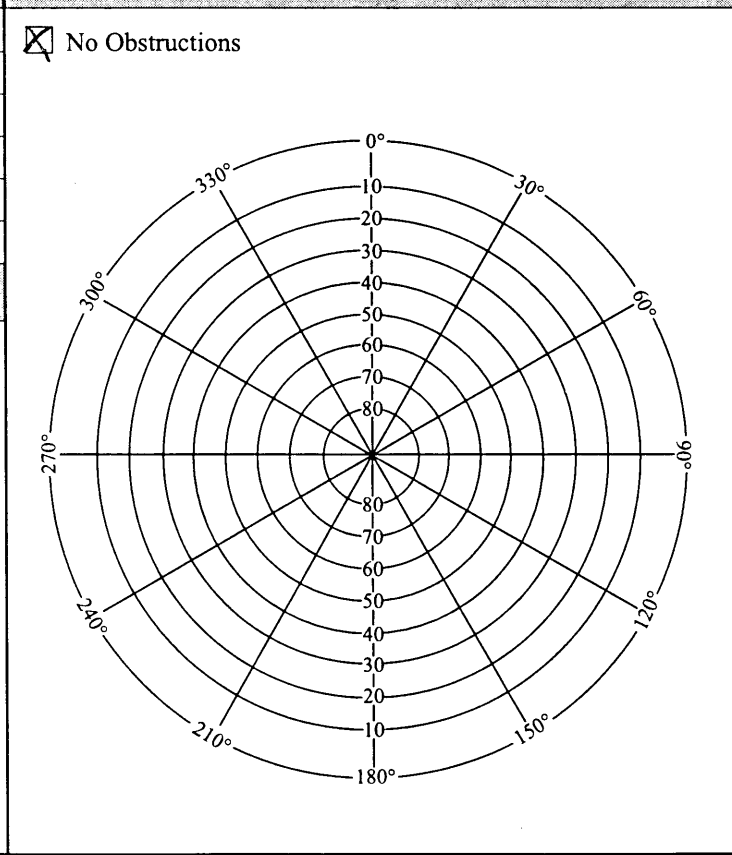

DISC DETAIL

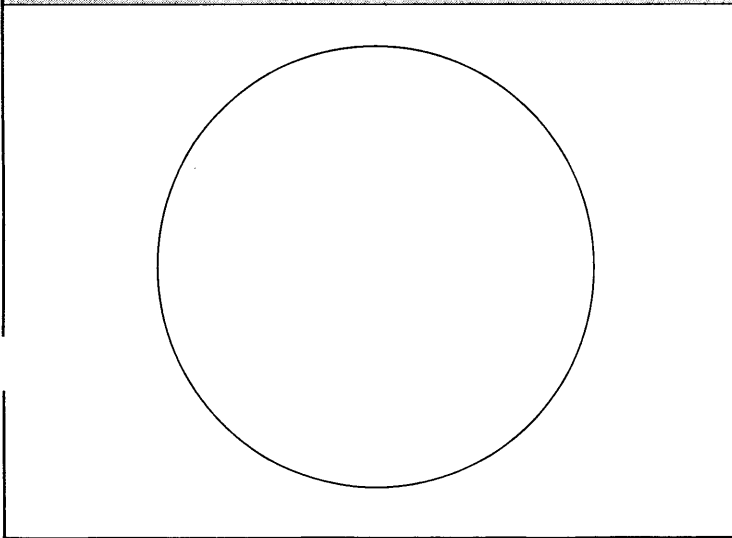



GPS STATION LOG

Station Name: 2021 Project Name: Clinton Co
 Receiver No.: 12 Job Number: 57524
 Day of Year: 111 Local Date: 7-20-00
 Session No.: D Operator: DOB

C/A CODE POSITION

Lat: 39° 27 ' 04 " N
 Long: 83° 46 ' 54 " W
 Ellip. Height: 366 M

Trimble: 4000 SSE, 4000 SSI, Other
 Antenna: Kinematic, Compact, Groundplane, Dome
 Battery No.: 219963/1A15399
 Tribrach No.: FHT
 File Name: 0012-111-D

Antenna H.I. ⇒ Before: 2.063 M _____ Ft
 After: 2.063 M _____ Ft
Rapid Static, Static, Kinematic Survey

Actual ⇒ Start 17 :06 Stop 18 :00 UTC
 Start 13 :06 Stop 14 :00 Local
 Local-UTC Time Offset: -4

SV's Used: 02, 04, 07, 09, 16

Weather: _____

Sketch:

Description:

DRY 73.1
 WET 64.2
 HUM 47%
 PRESS 28.50
 CODE 01111

Type of Mark: Brass Disc
 Mapping: Z1A
 Agency: Clinton Co Eng.

Indicate North

Remarks:



GPS STATION LOG

Station Name: 2021 Project Name: Clinton County
 Receiver No.: 2948 Job Number: 59526
 Day of Year: 111 Local Date: 4/20/00
 Session No.: B Operator: G.T.F

C/A CODE POSITION

Lat: 39° 27' 04" N
 Long: 083° 46' 54" W
 Ellip. Height: +0362 M

Trimble: 4000 SSE, 4000 SSL, Other _____
 Antenna: Kinematic, Compact Groundplane Dome
 Battery No.: AG # 33812 EC 3315A02948
 Tribach No.: F-H-TF
 File Name: 2948-111-B

Antenna H.I. ⇒ Before: 2.063 M _____ Ft Actual ⇒ Start 13:30 Stop 14:23 UTC
 After: 2.063 M _____ Ft Start 9:30 Stop 10:23 Local
Rapid Static Static, Kinematic Survey T.V Local-UTC Time Offset: -4

SV's Used: 02, 27, 31, 08, 11, 13, 15, 07, 19 Weather: D=65.9 W=57.8 R.H.=61% BP=28.6
 weather code = 01111

Sketch:

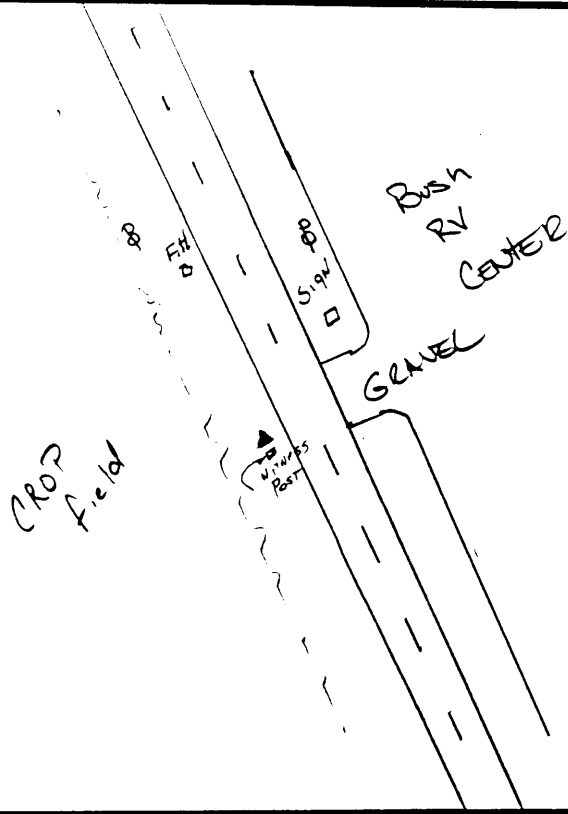

Description:

Type of Mark: DISK IN CONCRETE
 amping: 21A Auditor-ENGINEER 2000
 Agency: Clinton County



Remarks: