



Station Recovery Log

Station #: 2
 Project Name: CLINTON CO.
 Job Number: 57526
 Local Date: 11.22.99
 Name: JCO

TO-REACH DIRECTIONS

At Co Line on SR 68
 North of HWY 71

STATION LOCATION

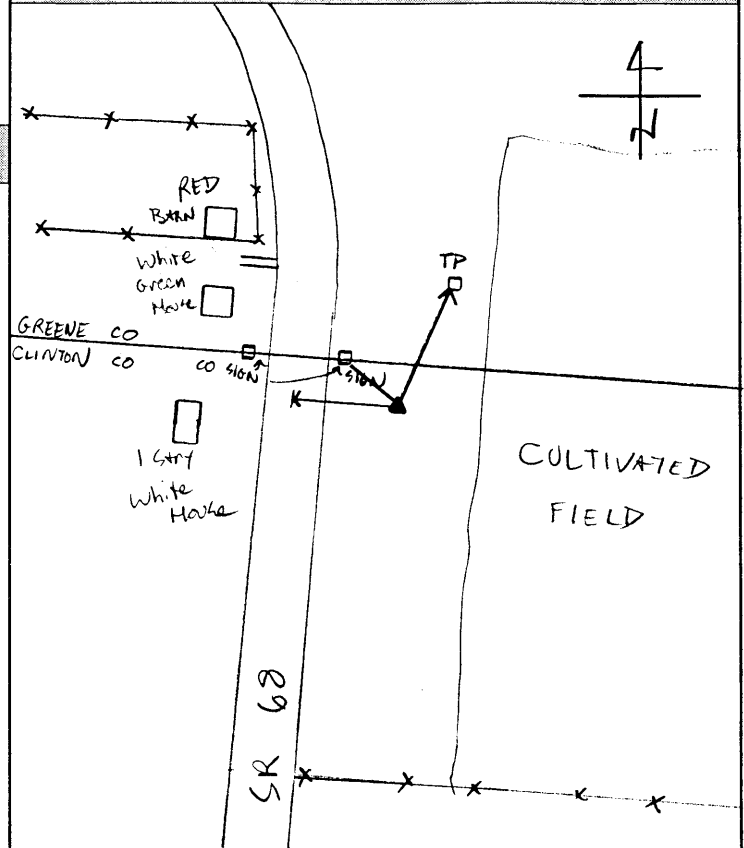

REFERENCES

Reference Object	Distance	Azimuth
Telephone Pedestal	37.0	
Co Sign	12.0	
Co 68	32.0	

VISIBILITY DIAGRAM

No Obstructions

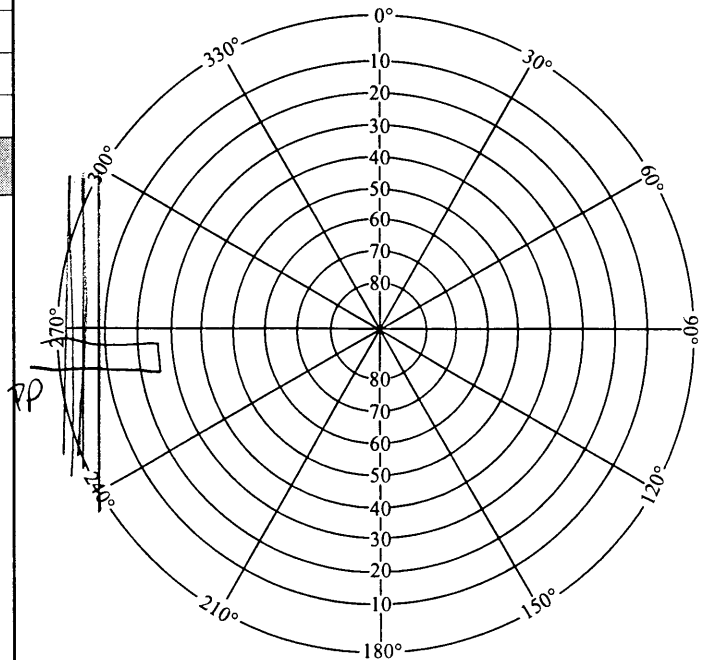

DISC DETAIL

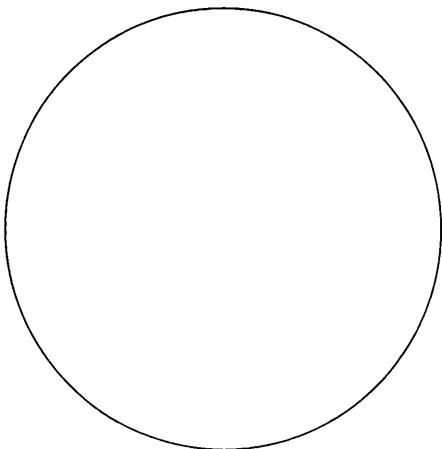



NOOLPERT

GPS STATION LOG

Station Name: 1002 (005) Project Name: CLINTON Co
 Receiver No.: 1372 Job Number: 57526
 Day of Year: 115 Local Date: 24-APR-00
 Session No.: A Operator: EJR

C/A CODE POSITION

Lat: 39 ° 33 ' 40 " N
 Long: 083 ° 50 ' 51 " W
 Ellip. Height: _____ M

Trimble: 4000 SSE, 4000 SSI, Other _____
 Antenna: Kinematic, ~~Compact~~, ~~Groundplane~~, Dome
 Battery No.: 1372 w/05737
 Tribrach No.: FLT
 File Name: 1372-115-A

Antenna H.I. ==> Before: 2.063T ✓ M _____ Ft Actual ==> Start 16 : 20 Stop 18 : 16 UTC
 After: 2.063T ✓ M _____ Ft Start 12 : 20 Stop 14 : 16 Local
Rapid Static, Static, Kinematic Survey Local-UTC Time Offset: _____ -4

SV's Used: _____ Weather: _____

Sketch:

Description:

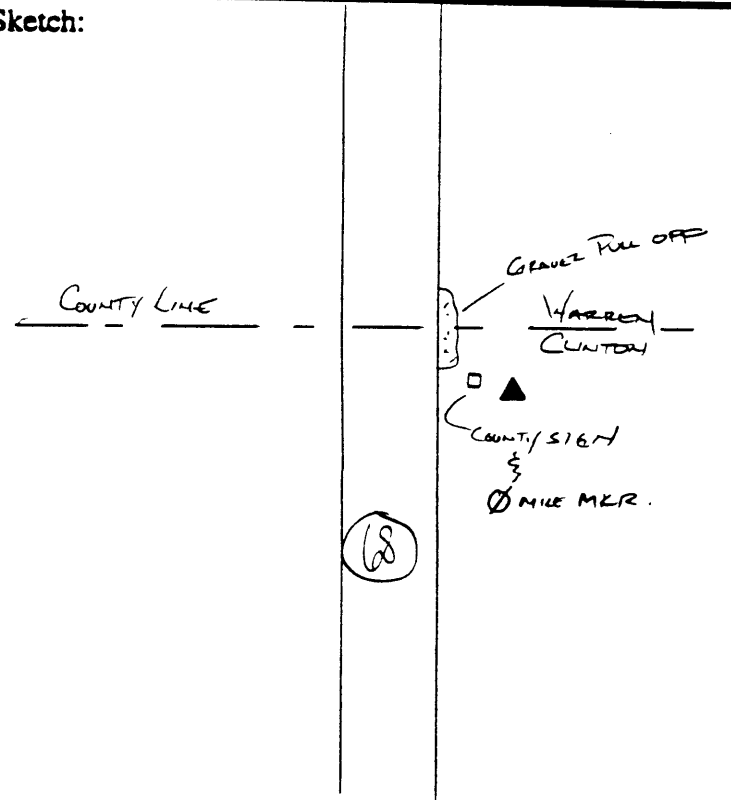

PREP VIS. CLOUD TEMP WIND
 0 0 1 1 1
 MET DATA:
 DRY (°) 61.9
 WET (°) 51.8
 R.H. 50%
 B.P. 28.82
 CODE: 00111

Type of Mark: Dsk
 nping: 2
 Agency: CLINTON Co

 Indicate North

Remarks:



WOOLPERT

GPS STATION LOG

Receiver ran out of memory @ 23:25

Station Name: 1002 Project Name: CLINTON CO
 Receiver No.: 1372 Job Number: 57526
 Day of Year: 112 Local Date: 21 APR 00
 Session No.: 6 Operator: EST

C/A CODE POSITION

Lat: 39 ° 33 ' 40 " N
 Long: 083 ° 50 ' 53 " W
 Ellip. Height: _____ M

Trimble: 4000 SSE, 4000 SSL, Other _____
 Antenna: Kinematic, Compact, Groundplane, Dome
 Battery No.: 1372 / 25723
 Tribach No.: FT
 File Name: 1372-112-G

Antenna H.I. ⇒ Before: 2.063 M _____ Ft Actual ⇒ Start 22 : 27 Stop 23 : 18 UTC
 After: 2.063 M _____ Ft Start 18 : 27 Stop 19 : 18 Local
 Rapid Static, Static, Kinematic Survey Local-UTC Time Offset: -4

SV's Used: _____ Weather: _____

Sketch:

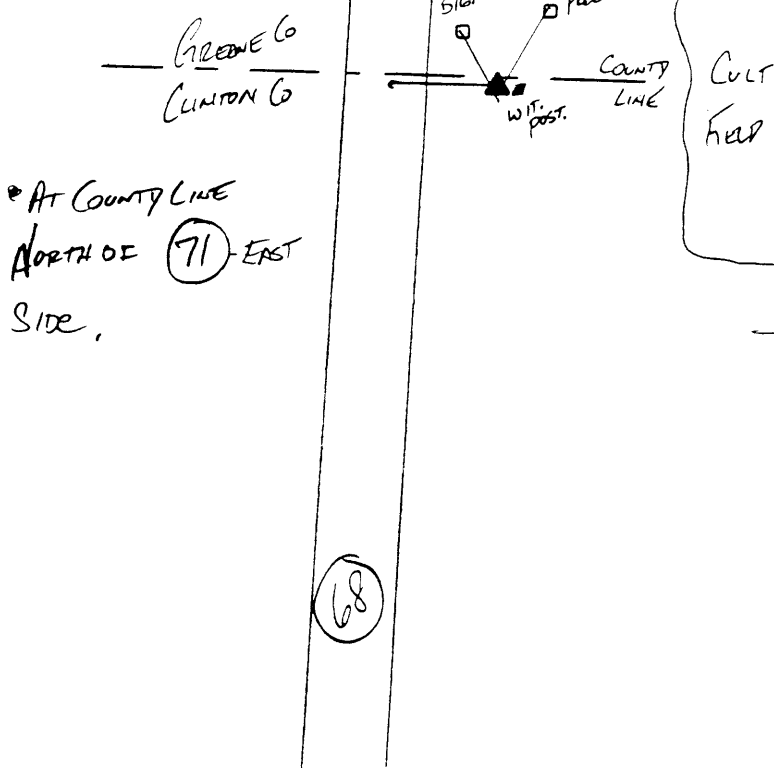

Description:

T. PEDESTAL - 37.05'
 COUNTY SIGN - 12.14'
 E 68 - 32.10'

Met Data:

DRY (F) - 44.4
 WET (F) - 42.7
 RH - 88%
 BP - 28.66
 CODE - 01121

Type of Mark: BRASS DISC
 amping: 2 2000
 Agency: CLINTON CO. AGRIC. ENGINEER



Remarks: